



QP-SERIES Quick Pneumatics

Compressed Air Piping Systems and Components

Rigid Aluminum Piping | Semi-Flexible Tubing | Fittings

FASTPIPE
BY RAPIDAIR

MAXLINE
BY RAPIDAIR

RAPIDAIR
HOME GARAGE

**OPTIONS AVAILABLE
For Big and Small Shops!**

IDEAL FOR:

- Automotive Shops
- Heavy Truck Repair
- Industrial
- Manufacturing
- Small Businesses
- Home Garages
- Hobbyist
- Food / Beverage
- Hospitals / Medical
- And More!

SVI International, Inc.

155 Harvestore Drive • DeKalb, IL 60115

800-321-8173

815-748-0200

www.sviinternational.com

CHICAGO • LOS ANGELES



DIRECTFIT™
SVI's DIRECT FIT™ BRAND

Table of Contents



Hose Reels / Electric Cord Reels	4-5
FastPipe Rigid, Straight Compressed Air Piping	6-27
Reddi-Crate™ Protective Packaging for FastPipe	6
MaxLine Semi-Flexible Compressed Air Tubing	5-6, 28-41
RapidAir Single-Layer Nylon Compressed Air Tubing	5-6, 42-45
RapidAir Compressed Air Accessories	46-59
Power Station™ Air / Electric Utility Box	57



SVI International
155 Harvestore Drive
DeKalb, IL 60115
Chicago • Los Angeles

800-321-8173 • 815-748-0200
Fax: 800-899-1784 • 815-748-0210
Email: parts@sviintl.com
sviinternational.com



Dual Arm Hose Reels

ROBUST CONSTRUCTION:

Heavy duty all steel construction, dual arm mounting with stamped reinforcing ribs, powder coat finish

VERSATILE MOUNTING:

Adjustable guide arm, hose reel can be installed on wall or ceiling

SPECS:

- 8-Position Ratchet Gear Locks Hose When Pulled Out of Reel
- Spring Return Drive, Automatically Rewinds the Hose
- Premium Quality, Made in Germany Rubber Air Hose, 300 PSI Rated



HOSE REELS WITH 50 OR 75 FT. HOSE

Also see Swivel Brackets below.

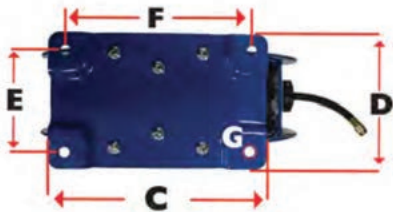
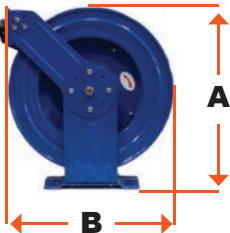

SVI Part #	HOSE ID	HOSE LENGTH	HOSE END NPT	INLET SIZE NPT	WEIGHT	A	DIMENSIONS (A THRU G):						(Hole Ø)
							B	C	D	E	F	G	
QP-0375-050-4	3/8"	50 ft	1/4" Male	1/2" Female	36 lbs	20.00"	17.50"	8.75"	5.75"	4.50"	7.50"	0.50"	
QP-0375-075-4-2	3/8"	75 ft	1/4" Male	1/2" Female	45 lbs	22.00"	20.00"	11.63"	7.00"	5.25"	10.00"	0.50"	
QP-0500-050-4	1/2"	50 ft	1/2" Male	1/2" Female	52 lbs	22.00"	20.00"	11.63"	7.00"	5.25"	10.00"	0.50"	

SWIVEL BRACKETS

Mounting Hardware Not Included

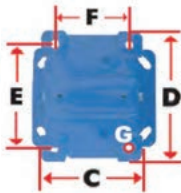

QP-0375-050SB

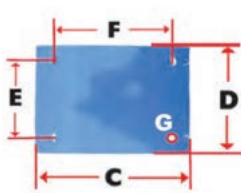

QP-0375-075SB

SVI Part #	Description	DIMENSIONS (C THRU G):					(Hole Ø)
		C	D	E	F	G	
QP-0375-050SB	Optional Swivel for QP-0375-050-4 Reel	5.625"	7.25"	5.75"	4.00"	0.50"	
QP-0375-075SB	Optional Swivel for QP-0375-075-4-2 and QP-0500-050-4 Reels	8.00"	5.50"	4.00"	6.00"	0.50"	

HOSE REEL WITH 100 FT. HOSE

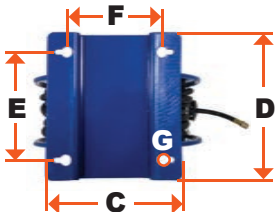
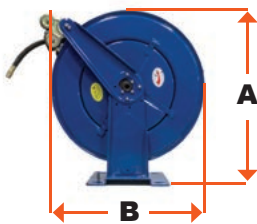

SVI Part #	HOSE ID	HOSE LENGTH	HOSE END NPT	INLET SIZE NPT	WEIGHT	A	B	DIMENSIONS (A THRU G):					(Hole Ø)
								C	D	E	F	G	
QP-0500-100-4	1/2"	100 ft	1/2" Male	1/2" Female	82 lbs	23.00"	22.00"	10.75"	11.75"	8.63"	7.63"	0.75"	



Electric Cord Reel

- 16 ga x 45 ft Cord
- Spring Retractable with Latch
- Adjustable Cable Stop
- Wall or Ceiling Mount with Swivel Bracket
- Rated 10 Amps x 125 Volts x 60 Hz
- 16/3 ga SJTW x 45 ft
- Circuit Breaker
- 3 ft Lead in Cord

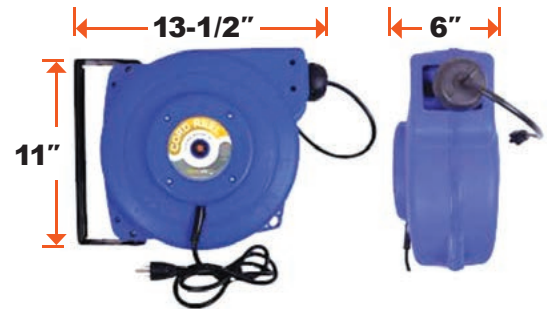

SVI Part #	Description	HEIGHT	DEPTH	WIDTH
QP-0016-045E	Electric Cord Reel 16 ga x 45 ft with Swivel	11.00"	13.50"	6.00"

Hose Reel Hose Stops

DIRECTFIT™ Service, Value, and Innovations
Top-line products and solutions.



MANY STYLES AVAILABLE FOR GENERAL USE AND VARIOUS MAKES:

- ALEMITE
- BALCRANK
- COXREELS
- DURO
- GRACO
- HANNAY
- HOSETRACT
- LEGACY LEVELWIND
- LINCOLN
- RAPID AIR
- REELCRAFT
- SAMSON



	BP-1525 - Standard FOR 3/8" ID HOSE Hose Stop Dimensions: 2.75" OD 0.611" ID 1.14" Thick		BP-1525L - Larger OD Style FOR 3/8" ID HOSE Hose Stop Dimensions: 3.625" OD 0.611" ID 1.14" Thick
	BP-1526 - Standard FOR 1/2" ID HOSE Hose Stop Dimensions: 2.75" OD 0.78" ID 1.14" Thick		BP-1526L - Larger OD Style FOR 1/2" ID HOSE Hose Stop Dimensions: 3.625" OD 0.78" ID 1.14" Thick
	BP-1527 - Standard FOR 1/4" ID HOSE Hose Stop Dimensions: 2.75" OD 0.522" ID 1.14" Thick		BP-1527L - Larger OD Style FOR 1/4" ID HOSE Hose Stop Dimensions: 3.625" OD 0.522" ID 1.14" Thick
	BP-1528L - Larger OD Style FOR 11/16" ID HOSE Hose Stop Dimensions: 4.25" OD 1.375" ID 2" Thick		BP-1529L - Larger OD Style FOR 29/32" ID HOSE Hose Stop Dimensions: 4.25" OD 1.875" ID 2" Thick



FASTPIPE
BY RAPIDAIR



MAXLINE
BY RAPIDAIR



RAPIDAIR
HOME GARAGE

RapidAir, MaxLine, and FastPipe piping systems are low maintenance and much easier to install than the alternatives. Plus, they deliver clean compressed air, safely.

Traditional alternatives may seem cheaper up front, but they are actually much more expensive when you consider costs of labor, workers' comp, and wear and tear on your tools. PVC could explode. Copper is expensive and requires specialized skills to install. Black pipe generates rust, silt and sediment, which gets into the air lines and ruins air tools and machinery. With our blue aluminum compressed air pipe products, you don't have to worry about any of that.

Safer than PVC

PVC is not rated for compressed air. PVC becomes brittle over time and is not safe. It can explode, sending shrapnel everywhere. Using PVC for compressed air is a safety liability you don't want to gamble on. RapidAir blue aluminum airline products deliver safe compressed air. Plus, OSHA has banned the use of PVC piping for compressed air in above-ground applications.

Cleaner than Black Iron Pipe

Black iron pipe creates rust, silt, and sediment, which can ruin your equipment. Protect your investment with our plastic tubing or blue aluminum pipe that always delivers clean air.

Easier than Copper: Copper pipes require soldering. Our piping only uses compression blue aluminum air pipe fittings. No expensive special tools or glue needed.

Can be Modified

Black iron pipe or copper pipes are time consuming to install. And once they've been installed, modifying the system is very difficult. With RapidAir blue airline pipe, you can change your compressed air distribution system ANYTIME, even after installation.

Faster Installation

With RapidAir blue pipe products, you'll save 30-50% on installation time and labor costs versus traditional products, like copper or black iron. You can run 300 feet of piping by yourself in an afternoon—and it's easy.

PREVENT PRODUCT DAMAGE • ECONOMICAL TROUBLE-FREE TRANSPORTATION

SVI carefully handles and packages your order in to ensure your FastPipe Compressed Air Piping is delivered safely!

Reddi-Crate™ Protective Packaging for Shipping
The simple, low cost solution to product protection.

Reddi-Crate™ laminated paperboard packaging helps prevent product damage that can occur during shipping and handling. An economical replacement product for expensive wooden crates that are ideally-suited for trouble-free compressed air piping transportation, its preformed profiles and two end closures form a shipping container that provides superior strength and protection at a very reasonable cost.

Reddi-Crate™ has a smooth surface and interior that is non-abrasive to products. Its standard exterior is a white clay coat. Reddi-Crate™ end plugs are typically 2 by 6 wood boards stapled in place to secure the ends and your tubing in place. It is ideal protection to help protect your tubing shipments from the rigors of transportation.

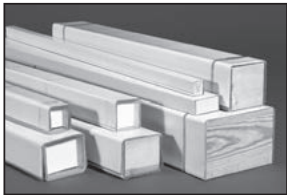

10" Wide x 6" Tall
20-1/2" ft. Long
3/16" Thick Walls
SVI # BL-5000C

SHIPPING CARTON CAPACITY	
Tubing O.D.	# of Lengths
1/2"	210
3/4"	87
1"	50
1-1/2"	22
2"	12

FASTPIPE®
 BY RAPIDAIR

MAXLINE®
 BY RAPIDAIR

RAPIDAIR®
 HOME GARAGE

Rigid, Straight Modular Aluminum Alloy Compressed Air Piping

FASTPIPE by RapidAir

Rigid, Straight
Aluminum Alloy Pipe

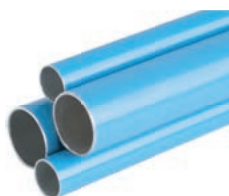

3/4" • 1"

Available in Pipe Lengths
19' 2" and 7' 6"

Compressed Air: 190 psi max
Inert Gas: 190 psi max
Vacuum: Up to 29 in hg

Fittings: Compression Style
Fiberglass / Nylon

**Distance from the compressor
to the farthest outlet point**
up to 150 ft use 3/4" FastPipe
up to 300 ft use 1" FastPipe

*Also available in OD:
1-1/2" • 2" • 3" • 4" • 6"*
Contact SVI today 800-321-8173

APPLICATION

- Straight Piping Runs
- Elbow Fittings Needed for Corners
- Professional Looking Installations
- Multiple Air Supply Stations
- On-Wall or Suspended Ceiling Installation

NOTE: FastPipe and MaxLine
Fittings are NOT Interchangeable.

Industrial Semi-Flexible, Leak-Proof Compressed Air Tubing

MAXLINE by RapidAir

Multi Layer Tubing
(HDPE-Aluminum-HDPE)
Maintains Shape After Bending



1/2" • 3/4" • 1"

Available in 25 ft, 50 ft,
100 ft, 300 ft rolls

Compressed Air: 200 psi max
Inert Gas: 200 psi max
Vacuum: Up to 29 in hg

Fittings: Compression Style
Nickel Plated Brass
(Stainless Steel option)

**Distance from the compressor
to the farthest outlet point**
up to 75 ft use 1/2" MaxLine
up to 200 ft use 3/4" MaxLine
up to 300 ft use 1" MaxLine

2" Tubing is also available!—
Contact SVI today 800-321-8173

APPLICATION

- Layouts with Many Obstructions
- Tubing can Sweep/Bend Corners
- Long Continuous Piping Lengths
- Direct Burial
- In-Wall / On-Wall Installations
- Economical

NOTE: FastPipe and MaxLine
Fittings are NOT Interchangeable.

Single Layer Nylon Compressed Air Tubing for Single Air User/Home Garage

RapidAir Home Garage

Single Layer Tubing
Nylon Material



1/2" OD x 3/8" ID

Available in 100 ft rolls

Compressed Air: 150 psi max

Fittings: Push-to-Connect Style
Nickel Plated Brass / Nylon

**Distance from the compressor
to the farthest outlet point**
up to 50 ft
For building sizes
under 1200 sq. ft.

Contact SVI today 800-321-8173

APPLICATION

- Home Garage / Workshop
- Hobbyist Woodworking
- In-Wall / On-Wall Installation
- Single Air Users

FAST & EASY INSTALLATION • LOW MAINTENANCE



Modular Aluminum Compressed Air Piping



*Rigid, Straight
Modular Aluminum Alloy
Compressed Air Piping*

FASTPIPE by RapidAir

Rigid, Straight
Aluminum Alloy Pipe

3/4" • 1" • 1-1/2" • 2"

Available in Pipe Lengths
19' 2" and 7' 6"

*Also available in OD: 3" • 4" • 6"
Specs Vary For Larger Sizes—Call SVI Today!*

TECHNICAL SPECS

Compressed Air: 190 psi max

Inert Gas: 190 psi max

Vacuum: Up to 29 in hg

0° to 140° F

Compatible with all types of
compressor lubricants

GENERAL SYSTEM RATINGS

Fire-resistant to flammability
standard UL94HB

OSHA Compliant

ALUMINUM PIPE SPECS

3/4"–2" / Call for Larger Pipe Specs

- Alloy Grade
- Extruded to ASTM B221, B429
- Blue powder coat, RAL5012 outside
- Green powder coat, RAL6018 outside
- Non-chromate conversion coating inside

**Distance from the compressor
to the farthest outlet point**
up to 150 ft use 3/4" FastPipe
up to 300 ft use 1" FastPipe

IDEAL FOR: Industrial Plants,
Manufacturing Facilities,
Small Businesses, Auto Shops,
Heavy Truck Repair, and more...



APPLICATIONS

- Straight Piping Runs
- Elbow Fittings Needed for Corners
- Professional Looking Installations
- Multiple Air Supply Stations
- On-Wall / Hanging from Ceiling Installation
- Operating Heavy-Duty Air or Tire Inflation Tools

QUICK INSTALLATION

- Compression style fittings make installation simple
- Aluminum piping is easy to cut and handle
- O-ring seals ensure a leak free system
- No gluing, threading, or soldering
- Installs in half the time as some traditional methods

ADAPTABLE

- Install in small shops to large industrial plants
- Connect to any existing piping system
- Expand or modify the Air System with ease

SUPERIOR AIR QUALITY

- No corrosion in the pipe and fittings means longer tool life
- Cools hot compressed air quickly for better filter performance

ENERGY EFFICIENT

- Smooth inner wall and free flowing fittings lower compressed air costs
- Sealed connections means your compressor run time is less



Modular Aluminum Compressed Air Piping



Note: Fastpipe Ships by Truck Freight and is Non-Returnable

Fastpipe by RapidAir—Choose:

Blue for Compressed Air

Green for Inert Gases

19' 2" Pipe Ships by Truck Freight • 7' 6" Pipe Ships UPS

BLUE PIPE • FOR COMPRESSED AIR

SIZE	MM	SVI PART #	OUTSIDE	INSIDE	LENGTH	WEIGHT
3/4"	20mm	QP-1541-000	.79 in.	.69 in.	19 ft. 2 in.	3 lbs.
1"	25mm	QP-1542-000	.98 in.	.87 in.	19 ft. 2 in.	4.2 lbs.
1½"	40mm	QP-1544-000	1.57 in.	1.43 in.	19 ft. 2 in.	8.4 lbs.
2"	50mm	QP-1545-000	1.97 in.	1.81 in.	19 ft. 2 in.	10.6 lbs.
3/4"	20mm	QP-1541-863	.79 in.	.69 in.	7 ft. 6 in.	1.3 lbs.
1"	25mm	QP-1542-863	.98 in.	.87 in.	7 ft. 6 in.	1.5 lbs.
1½"	40mm	QP-1544-863	1.57 in.	1.43 in.	7 ft. 6 in.	4 lbs.
2"	50mm	QP-1545-863	1.97 in.	1.81 in.	7 ft. 6 in.	4.2 lbs.

LARGER OD TUBING MAY BE SPECIAL ORDER—CALL FOR SPECS:

3"	80mm	QP-1607-000			19 ft. 2 in.	22.5 lbs.
4"	102mm	QP-1608-000			19 ft. 2 in.	33.2 lbs.
6"	153mm	QP-1609-000			19 ft. 2 in.	64.2 lbs.
3"	80mm	QP-1607-863			7 ft. 6 in.	

GREEN PIPE • FOR INERT GASES

SIZE	MM	PART #	OUTSIDE	INSIDE	LENGTH	WEIGHT
3/4"	20mm	QP-1541-000G	.79 in.	.69 in.	19 ft. 2 in.	3 lbs.
1"	25mm	QP-1542-000G	.98 in.	.87 in.	19 ft. 2 in.	4.2 lbs.
1½"	40mm	QP-1544-000G	1.57 in.	1.43 in.	19 ft. 2 in.	8.4 lbs.
2"	50mm	QP-1545-000G	1.97 in.	1.81 in.	19 ft. 2 in.	10.6 lbs.
3/4"	20mm	QP-1541-863G	.79 in.	.69 in.	7 ft. 6 in.	1.3 lbs.
1"	25mm	QP-1542-863G	.98 in.	.87 in.	7 ft. 6 in.	1.5 lbs.
1½"	40mm	QP-1544-863G	1.57 in.	1.43 in.	7 ft. 6 in.	4 lbs.
2"	50mm	QP-1545-863G	1.97 in.	1.81 in.	7 ft. 6 in.	4.2 lbs.

Get started today!
Call 800-321-8173

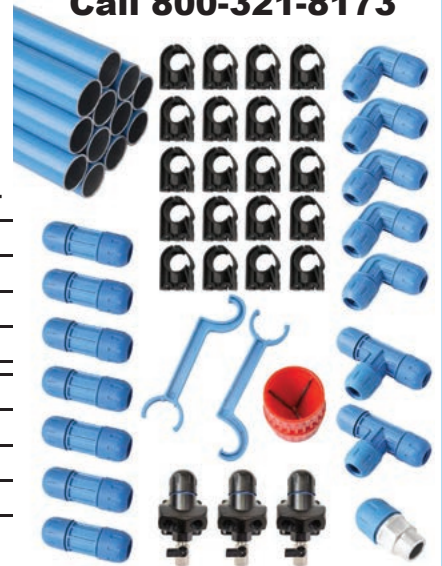

Green Master Kits
available—Contact SVI.

Master Kits make it easy—pick a kit and add on.

FASTPIPE ALUMINUM COMPRESSED AIR PIPING SYSTEM • MASTER KITS

SVI PART #	SERIES	OD	DESCRIPTION	See next page for Master Kit Details...
QP-1588-099	FastPipe 3/4 in.	3/4"	Master Kit	230 ft. / 5 Outlets
QP-1588-070	FastPipe 3/4 in.	3/4"	Master Kit	90 ft. / 3 Outlets
QP-1588-235	FastPipe 1 in.	1"	Master Kit	230 ft. / 5 Outlets
QP-1588-090	FastPipe 1 in.	1"	Master Kit	90 ft. / 3 Outlets



Modular Aluminum Compressed Air Piping

3/4"
SYSTEM

FASTPIPE MASTER KITS (continued)

Set up a compressed air system with the 3/4 in. Fastpipe Master Kit. The Fastpipe Rigid Pipe is all aluminum and powder coated on the outside. Reduce shop clutter with this industrial compressed air piping system. No glue, soldering or crimping needed. Simply cut the pipe to length, insert in the fitting and tighten. Easy to expand with more air outlet locations or modify later.

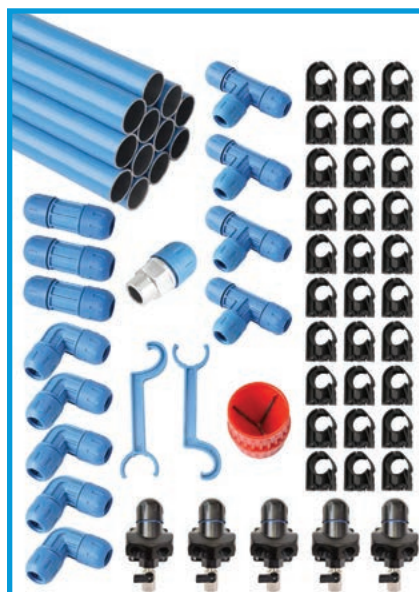

(Fittings Box Only: # QP-1588-099F)

SVI PART

DESCRIPTION

QP-1588-099 FastPipe 3/4 in. 3/4" Master Kit • 230 ft. • 5 Outlets

Kit Contains:

(12)	QP-1541-000	3/4" Blue Aluminum FastPipe 19' 2" Long (230 ft. Total)
(5)	QP-1541-024	Air Outlet
(3)	QP-1541-002	Union
(5)	QP-1541-003	Elbow
(4)	QP-1541-005	Tee Fitting
(1)	QP-1541-118	Threaded Male Adapter 3/4" Male NPT
(3)	QP-1541-022-10	10/Pack Mount Clips (30 Clips Total)
(2)	QP-1541-020	Spanner Wrench
(1)	QP-1540-142	Deburr Tool (3/4" & 1")

Outlets have 1/2" Female NPT Ports, use Coupler QP-2270-241

Use Jumper Hose QP-1540-215 3/4" x 3 ft.

Use Regulator QP-2293-217 3/4" Ports

Ships Truck Freight

Use only with Fastpipe 3/4 in. system.

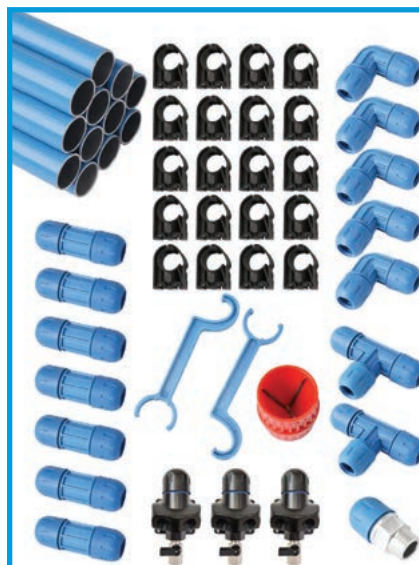
3/4"
SYSTEM

(Fittings Box Only: # QP-1588-070F)

SVI PART

DESCRIPTION

QP-1588-070 FastPipe 3/4 in. 3/4" Master Kit • 90 ft. • 3 Outlets

Kit Contains:

(12)	QP-1541-863	3/4" Blue Aluminum FastPipe 7' 6" Long (90 ft. Total)
(3)	QP-1541-024	Air Outlet
(7)	QP-1541-002	Union
(5)	QP-1541-003	Elbow
(2)	QP-1541-005	Tee Fitting
(1)	QP-1541-118	Threaded Male Adapter 3/4" Male NPT
(2)	QP-1541-022-10	10/Pack Mount Clips (20 Clips Total)
(2)	QP-1541-020	Spanner Wrench
(1)	QP-1540-142	Deburr Tool (3/4" & 1")

Outlets have 1/2" Female NPT Ports, use Coupler QP-2270-241

Use Jumper Hose QP-1540-215 3/4" x 3 ft.

Use Regulator QP-2293-217 3/4" Ports

Ships UPS

Use only with Fastpipe 3/4 in. system.

3/4"
SYSTEM

Need a different size tubing or ready to order—Call SVI Today 800-321-8173



Modular Aluminum Compressed Air Piping

FASTPIPE MASTER KITS *(continued)*

Set up a compressed air system with the 1 in. Fastpipe Master Kit. The Fastpipe Rigid Pipe is all aluminum and powder coated on the outside. Reduce shop clutter with this industrial compressed air piping system. No glue, soldering or crimping needed. Simply cut the pipe to length, insert in the fitting and tighten. Easy to expand with more air outlet locations or modify later.



SVI PART #	DESCRIPTION
QP-1588-235	FastPipe 1 in. 1" Master Kit • 230 ft. • 5 Outlets
Kit Contains:	
(12) QP-1542-000	1" Blue Aluminum FastPipe 19' 2" Long (230 ft. Total)
(5) QP-1542-024	Air Outlet • 1" Inlet with (4) 1/2" FNPT Outlets
(3) QP-1542-002	Union
(5) QP-1542-003	90° Elbow
(4) QP-1542-005	Equal Tee Fitting
(1) QP-1542-118	Threaded Male Adapter 3/4" Male NPT
(3) QP-1542-022-10	10/Pack Mount Clips (30 Clips Total)
(2) QP-1542-020	Spanner Wrench
(1) QP-1540-142	Deburr Tool (3/4" & 1")

Outlets have 1/2" Female NPT Ports, use Coupler QP-2270-241
 Use Jumper Hose QP-1540-215 3/4" x 3 ft.
 Use Regulator QP-2293-217 3/4" Ports

Ships Truck Freight

Use only with Fastpipe 1 in. system.

1"
SYSTEM

(Fittings Box Only: # QP-1588-235F)

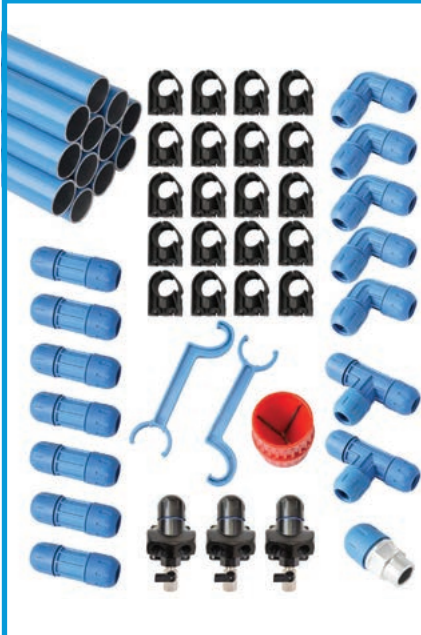

SVI PART #	DESCRIPTION
QP-1588-090	FastPipe 1 in. 1" Master Kit • 90 ft. • 3 Outlets
Kit Contains:	
(12) QP-1542-863	1" Blue Aluminum FastPipe 7' 6" Long (90 ft. Total)
(3) QP-1542-024	Air Outlet • 1" Inlet with (4) 1/2" FNPT Outlets
(7) QP-1542-002	Unions
(5) QP-1542-003	90° Elbow
(2) QP-1542-005	Equal Tee Fittings
(1) QP-1542-118	Threaded Male Adapter 3/4" Male NPT
(2) QP-1542-022-10	10/Pack Mount Clips (20 Clips Total)
(2) QP-1542-020	Spanner Wrench
(1) QP-1540-142	Deburr Tool (3/4" & 1")

Outlets have 1/2" Female NPT Ports, use Coupler QP-2270-241
 Use Jumper Hose QP-1540-215 3/4" x 3 ft.
 Use Regulator QP-2293-217 3/4" Ports

Ships UPS

Use only with Fastpipe 1 in. system.

1"
SYSTEM

(Fittings Box Only: # QP-1588-090F)

Need a different size tubing or ready to order—Call SVI Today 800-321-8173



Modular Aluminum Compressed Air Piping

FASTPIPE AIR COOLING LOOP

- Easy to install, versatile solution to eliminate excess moisture in an air system.
- Hot air flows into the cooling loop and travels a total distance of approximately 27 feet, cooling the air and causing water vapor to condense
- Rectangular construction allows for easy draining through the ball valves
- Inexpensive compared to the cost of a powered air dryer or aftercooler

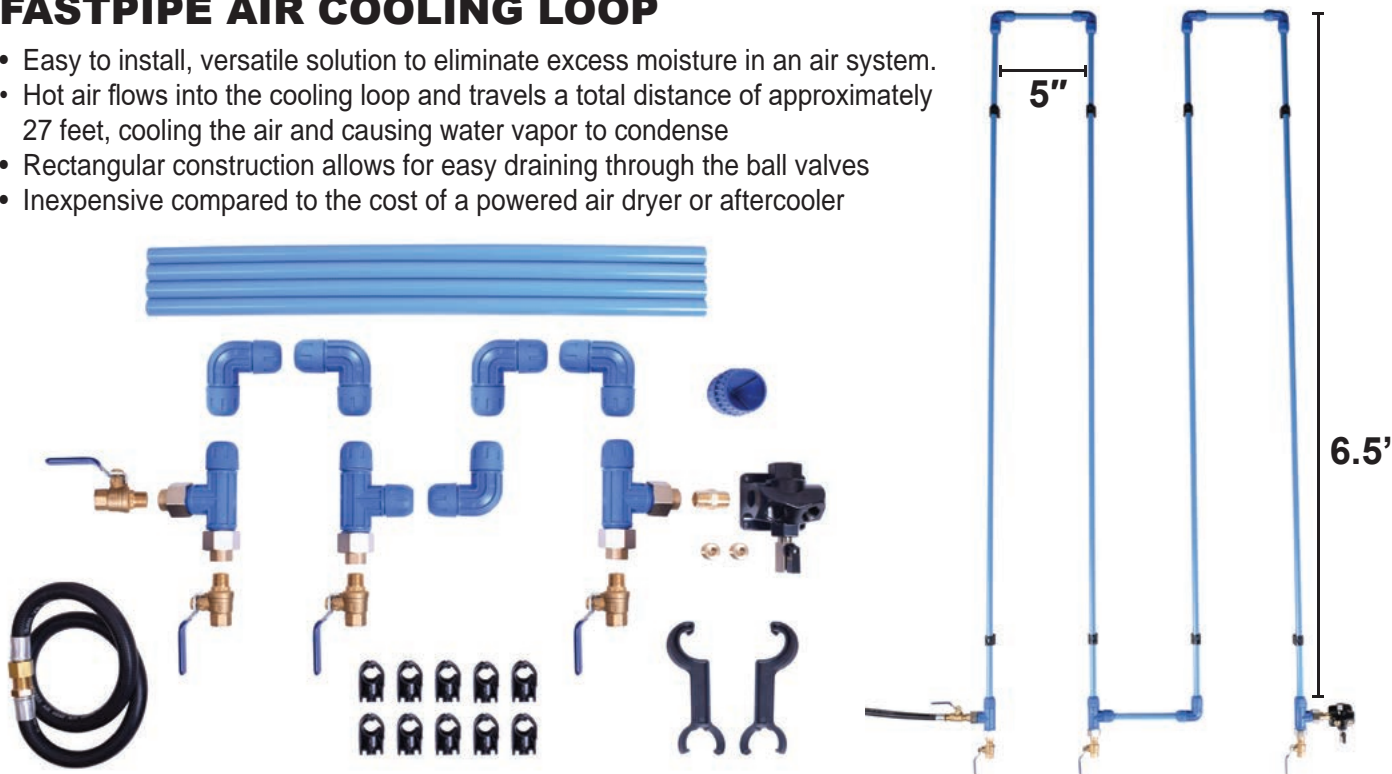

3/4"
SYSTEM

FASTPIPE COOLING KIT FOR 3/4" SYSTEM

Order SVI Part # QP-1588-072

Kit Components:

SVI Part #	Qty	Description
QP-1588-072	KIT	Fastpipe Cooling Kit for 3/4" System
QP-1541-863	4	3/4" OD X 7' 6" Long Pipe
QP-1541-003	5	3/4" Fastpipe Elbows
QP-1541-009	3	3/4" Fastpipe Reducing Tee x 1/2" FNPT
QP-1543-400	2	3/4" Fastpipe Large Hex Nut
QP-1543-411	2	3/4" Fastpipe Insert Gasket
QP-1543-450	2	3/4" Fastpipe Brass Insert x 1/2" FNPT
QP-2235-050M	4	1/2" NPT Male x Female Brass Ball Valve
QP-5550-616	1	1/2" NPT Brass Hex Nipple
QP-1542-024	1	Wall Outlet with 1/2" Fnpt Inlet
QP-1540-142	1	Deburr Tool (3/4" & 1")
QP-1541-020	2	3/4" Spanner Wrench
QP-1541-022-10	1	3/4" Fastpipe Wall Clips (10 Pack)
QP-1540-213	1	1/2" x 3' Compressor Jumper Hose

1"
SYSTEM

FASTPIPE COOLING KIT FOR 1" SYSTEM

Order SVI Part # QP-1588-092

Kit Components:

SVI Part #	Qty	Description
QP-1588-092	KIT	Fastpipe Cooling Kit for 1" System
QP-1542-863	4	1" OD X 7' 6" Long Pipe
QP-1542-003	5	1" Fastpipe Elbows
QP-1542-009	3	1" Fastpipe Reducing Tee x 1/2" FNPT
QP-1543-100	2	1" Fastpipe Large Hex Nut
QP-1543-111	2	1" Fastpipe Insert Gasket
QP-1543-175	2	1" Fastpipe Brass Insert x 3/4" FNPT
QP-2235-075M	1	3/4" NPT Male x Female Brass Ball Valve
QP-2235-050M	3	1/2" NPT Male x Female Brass Ball Valve
QP-5550-620	1	3/4" x 1/2" NPT Brass Hex Nipple
QP-1542-025	1	Wall Outlet with 3/4" FNPT Inlet
QP-1540-142	1	Deburr Tool (3/4" & 1")
QP-1542-020	2	1" Spanner Wrench
QP-1542-022-10	1	1" Fastpipe Wall Clips (10 Pack)
QP-1540-215	1	3/4" x 3' Compressor Jumper Hose

Need a different size tubing or ready to order—Call SVI Today 800-321-8173



Modular Aluminum Compressed Air Piping

FastPipe blue aluminum airline installs in half the time as most traditional methods. Save on labor costs by needing fewer people to install the system, and installation will take half the time. Saving money on labor costs simply makes sense.



FITTINGS

NOTE: FastPipe and MaxLine Fittings are NOT Interchangeable.



FITTINGS SPECS FOR 3/4" TO 2" OD

- Nylon 6 Base with Fiberglass Reinforcement
- Bite Ring: Stainless Steel
- O-Ring: Nitrile



FITTINGS SPECS FOR 3" OD

- Diecast Aluminum Alloy
- Bite Ring: Stainless Steel
- O-Ring: Nitrile
- Electrocoated



FITTINGS SPECS FOR 4" AND 6" OD

- Diecast Aluminum Alloy
- Seal: Nitrile
- Powder Coat

3/4"-3" COMPRESSION TYPE

— Step 1 —



— Step 2 —



— Step 3 —



4"-6" LUG TYPE

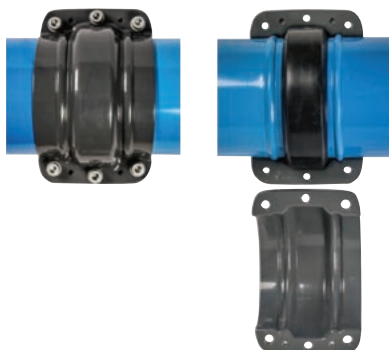

SPARE PARTS

Seal for 4" / 6"

SIZE	SVI PART #
4"	QP-1608-076
6"	QP-1609-076



Modular Aluminum Compressed Air Piping
FASTPIPE FITTINGS • 3/4" TO 2"

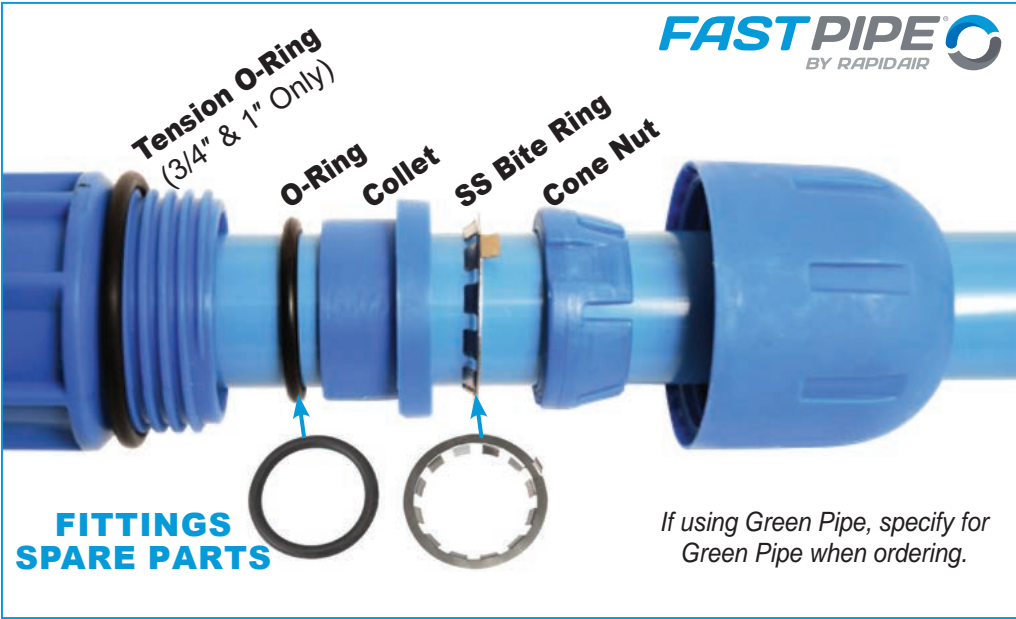

**SPARE PARTS KIT
FOR BLUE FASTPIPE**
(Includes O-Ring & SS Bite Ring)
Choose 1 Each or Kits of 10 Each

SIZE	SVI PART #
3/4"	QP-1541-076
3/4"	QP-1541-076-10
1"	QP-1542-076
1"	QP-1542-076-10
1½"	QP-1544-076
1½"	QP-1544-076-10
2"	QP-1545-076
2"	QP-1545-076-10
3"	QP-1607-076
3"	QP-1607-076-10

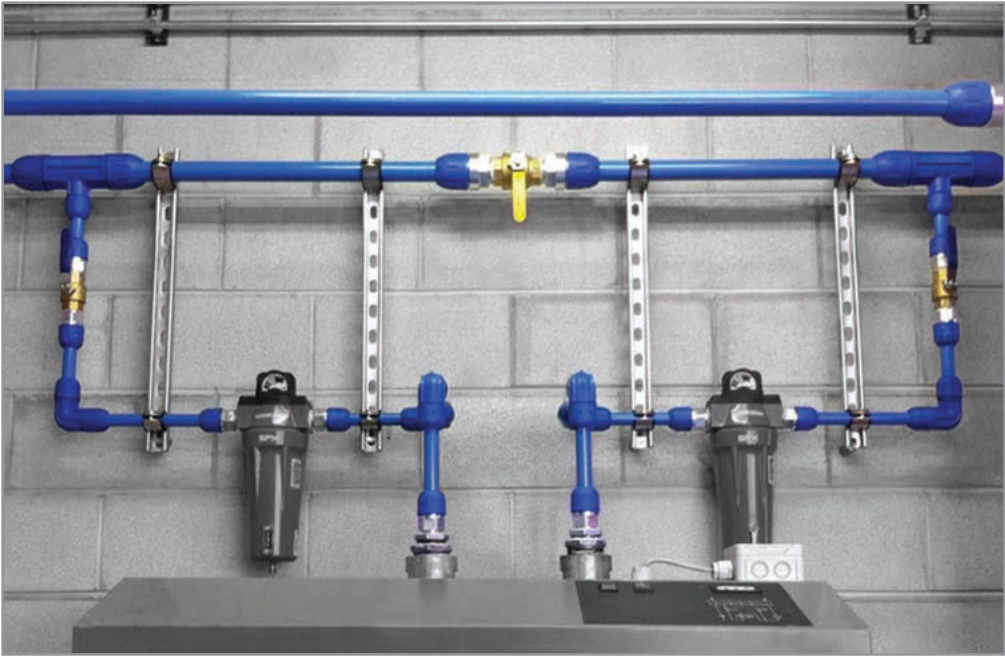



Modular Aluminum Compressed Air Piping

FASTPIPE FITTINGS • 3/4" TO 2"



UNION

SIZE	SVI PART #
3/4"	QP-1541-002
1"	QP-1542-002
1½"	QP-1544-002
2"	QP-1545-002



REDUCING UNION

SIZE	SVI PART #
1" x 3/4"	QP-1542-121
1½" x 3/4"	QP-1544-223
1½" x 1"	QP-1544-221
2" x 3/4"	QP-1545-223
2" x 1"	QP-1545-221
2" x 1½"	QP-1545-421



INLINE VALVE

SIZE	SVI PART #
3/4"	QP-1541-111
1"	QP-1542-222
1½"	QP-1544-444
2"	QP-1545-555



90° ELBOW

SIZE	SVI PART #
3/4"	QP-1541-003
1"	QP-1542-003
1½"	QP-1544-003
2"	QP-1545-003



45° ELBOW

SIZE	SVI PART #
1"	QP-1542-004
1½"	QP-1544-004
2"	QP-1545-004



90° REDUCING ELBOW NPT

DROP SIZE		
SIZE	FEMALE	SVI PART #
3/4"	1/4" NPT	QP-1541-073
3/4"	1/2" NPT	QP-1541-093
1"	1/4" NPT	QP-1542-073
1"	1/2" NPT	QP-1542-093
1"	3/4" NPT	QP-1542-083



EQUAL TEE

SIZE	SVI PART #
3/4"	QP-1541-005
1"	QP-1542-005
1½"	QP-1544-005
2"	QP-1545-005



REDUCING TEE

DROP		
SIZE	SIZE	SVI PART #
1"	3/4"	QP-1542-107
1½"	3/4"	QP-1544-206
1½"	1"	QP-1544-207
2"	3/4"	QP-1545-206
2"	1"	QP-1545-207



REDUCING TEE NPT

DROP SIZE		
SIZE	FEMALE	SVI PART #
3/4"	1/4"	QP-1541-007
3/4"	1/2"	QP-1541-009
1"	1/4"	QP-1542-007
1"	1/2"	QP-1542-009
1"	3/4"	QP-1542-008
1½"	1/2"	QP-1544-009
1½"	3/4"	QP-1544-008
2"	1/2"	QP-1545-009
2"	3/4"	QP-1545-008



CROSS

SIZE	SVI PART #
3/4"	QP-1541-051
1"	QP-1542-051
1½"	QP-1544-051
2"	QP-1545-051



Modular Aluminum Compressed Air Piping

FASTPIPE FITTINGS • 3/4" TO 2"

EXPANSION JOINTS

Any piping system will expand and contract with temperature changes. Use this guide for installation of expansion joints to compensate for this movement of aluminum pipe in non-conditioned buildings.

TEMP CHANGE	3/4"	1"	1-1/2"	2"	3"	4"	6"
10° F	700 ft.	600 ft.	550 ft.	500 ft.	300 ft.	250 ft.	225 ft.
20° F	500 ft.	460 ft.	420 ft.	370 ft.	230 ft.	190 ft.	175 ft.
35° F	350 ft.	310 ft.	280 ft.	250 ft.	150 ft.	125 ft.	100 ft.
55° F	260 ft.	230 ft.	200 ft.	190 ft.	120 ft.	95 ft.	75 ft.
70° F	200 ft.	190 ft.	170 ft.	150 ft.	100 ft.	75 ft.	50 ft.



FEMALE NPT X FEMALE NPT

SIZE	SVI PART #
1"	QP-1540-615
1½"	QP-1540-616
2"	QP-1540-617



THREADED FEMALE ADAPTER

MAIN SIZE	MALE THREAD	SVI PART #
3/4"	1/2" NPT	QP-1541-018
3/4"	3/4" NPT	QP-1541-118
1"	1/2" NPT	QP-1542-018
1"	3/4" NPT	QP-1542-118
1"	1" NPT	QP-1542-218
1½"	1" NPT	QP-1544-218
1½"	1½" NPT	QP-1544-418
2"	1½" NPT	QP-1545-418
2"	2" NPT	QP-1545-518



THREADED FEMALE ADAPTER

MAIN SIZE	FEMALE THREAD	SVI PART #
3/4"	3/4" NPT	QP-1541-120
1"	1" NPT	QP-1542-220
1½"	1½" NPT	QP-1544-420



REDUCING UNION X FEMALE NPT

MAIN SIZE	FEMALE THREAD	SVI PART #
3/4"	1/2" NPT	QP-1541-221
1"	1/2" NPT	QP-1542-221
1"	3/4" NPT	QP-1542-231
1½"	3/4" NPT	QP-1544-231
1½"	1/2" NPT	QP-1544-241
2"	3/4" NPT	QP-1545-231
2"	1/2" NPT	QP-1545-241



BRASS INSERT

PIPE SIZE	FEMALE THREAD	SVI PART #
1"	1/4" FNPT	QP-1543-125
1"	1/2" FNPT	QP-1543-150
1"	3/4" FNPT	QP-1543-175
3/4"	1/4" FNPT	QP-1543-425
3/4"	1/2" FNPT	QP-1543-450



GASKET FOR BRASS INSERTS, REDUCING TEE AND ELBOW TO NPT

PIPE SIZE	SVI PART #
3/4"	QP-1543-411
1"	QP-1543-111



Modular Aluminum Compressed Air Piping

FASTPIPE FITTINGS • 3/4" TO 3"

MALE NPT
X SWIVEL
FEMALE NPT



JUMPER HOSE RUBBER

MAIN SIZE	LENGTH	SVI PART #
1/2"	2 ft.	QP-1540-212
1/2"	3 ft.	QP-1540-213
3/4"	2 ft.	QP-1540-214
3/4"	3 ft.	QP-1540-215
3/4"	5 ft.	QP-1540-221
1"	2 ft.	QP-1540-216
1"	3 ft.	QP-1540-217

MALE NPT X SWIVEL
FEMALE NPT



JUMPER HOSE STAINLESS STEEL

MAIN SIZE	LENGTH	SVI PART #
1 1/2"	18"	QP-1540-225
1 1/2"	36"	QP-1540-226
2"	36"	QP-1540-227
3"	36"	QP-1540-228



END CAP

SIZE	SVI PART #
3/4"	QP-1541-006
1"	QP-1542-006
1 1/2"	QP-1544-006
2"	QP-1545-006



WALL OUTLET

HAS BOTTOM MOISTURE DRAIN
*Each side of outlet has an
extra 1/2" NPT port
2 plugs included*



TOP INLET	OUTLET SIZE FEMALE	SVI PART #
3/4"	(4x) 1/2" NPT	QP-1541-024
1"	(4x) 1/2" NPT	QP-1542-024

WALL OUTLET WITH SHUTOFF

HAS BOTTOM MOISTURE DRAIN



TOP INLET	OUTLET SIZE FEMALE	SVI PART #
3/4"	(4x) 1/2" NPT	QP-1541-024V
1"	(4x) 1/2" NPT	QP-1542-024V

FASTPIPE OUTLET CONVERSION TO SHUTOFF

Add a shut off valve to a Fastpipe outlet with a standard compression top

SVI Part #	Description
QP-1541-024K	Fastpipe 3/4" Outlet Conversion to Shutoff
QP-1542-024K	Fastpipe 1" Outlet Conversion to Shutoff



THRU WALL OR OUTSIDE OUTLET

MAIN SIZE	OUTLET SIZE FEMALE	SVI PART #
3/4"	(1X) 1/2" NPT	QP-1541-024W
1"	(1X) 1/2" NPT	QP-1542-024W

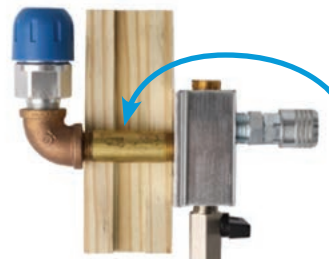

CUSTOMER-SUPPLIED
1/2" NPT NIPPLE
LENGTH VARIES PER
WALL THICKNESS



Modular Aluminum Compressed Air Piping

FASTPIPE WALL OUTLET SINGLE PORT

Use with Fastpipe Modular Compressed Air Blue or Green Aluminum Piping System

1/2" Female NPT Outlet, Front Side

SVI Part #	Description
QP-1541-014	3/4" Fastpipe Single Port Outlet Kit
QP-1542-014	1" Fastpipe Single Port Outlet Kit

Includes

- (1) QP-9118-010 Wall Block
- (1) QP-5550-120 Drain Valve
- (1) QP-5550-136 1/2" Brass Plug
- (1) QP-9107-510SP Spacer Plate
- (1) Threaded Male Adapter:
Either QP-1542-018 (3/4" x 1/2" NPT)
or QP-1541-018 (1" x 1/2" NPT)



Use Quick Coupler: QP-2260-241, QP-2270-241 or QP-2290-241



**WALL OUTLET
FOR USE WITH ANY
THREADED PIPE SYSTEM**

HAS BOTTOM MOISTURE DRAIN
Each side of outlet has an extra 1/2" NPT port
Kit Includes Wall Block, Drain Valve,
and (2) 1/2" Brass Plugs



TOP INLET	OUTLET SIZE FEMALE	SVI PART #
1/2" NPT	(4x) 1/2" NPT	QP-1542-025
3/4" NPT	(4x) 1/2" NPT	QP-1542-026

Use Quick Coupler: QP-2260-241, QP-2270-241 or QP-2290-241





Modular Aluminum Compressed Air Piping

FASTPIPE FITTINGS • 3", 4" and 6"



3"

UNION

SIZE	SVI PART #
3"	QP-1607-002



4" / 6"

UNION

SIZE	SVI PART #
4"	QP-1608-002
6"	QP-1609-002



REDUCING UNION

SIZE	SVI PART #
6" x 4"	QP-1609-821



45° ELBOW

SIZE	SVI PART #
4"	QP-1608-004
6"	QP-1609-004



90° ELBOW

SIZE	SVI PART #
3"	QP-1607-003



90° ELBOW

SIZE	SVI PART #
4"	QP-1608-003
6"	QP-1609-003



INLINE VALVE

SIZE	SVI PART #
3"	QP-1607-777



INLINE VALVE

SIZE	SVI PART #
4"	QP-1608-888
6"	QP-1609-999



EQUAL TEE

SIZE	SVI PART #
3"	QP-1607-005



EQUAL TEE

SIZE	SVI PART #
4"	QP-1608-005
6"	QP-1609-005



REDUCING TEE NPT

SIZE	SVI PART #
3" x 2" NPT	QP-1607-509



UNION PLUG

SIZE	SVI PART #
4"	QP-1608-221
4"	QP-1608-321
6"	QP-1609-221
6"	QP-1609-331

EXPANSION JOINTS

Any piping system will expand and contract with temperature changes. Use guide on page 11 for installation of expansion joints to compensate for this movement of aluminum pipe in non-conditioned buildings.



FEMALE NPT X FEMALE NPT

SIZE	SVI PART #
3"	QP-1540-619



FLANGE X FLANGE

SIZE	SVI PART #
4"	QP-1540-621
6"	QP-1540-622



Modular Aluminum Compressed Air Piping

FASTPIPE FITTINGS • 4" and 6"



THREADED MALE ADAPTER

MAIN SIZE	MALE THREAD	SVI PART #
3"	3" NPT	QP-1607-718

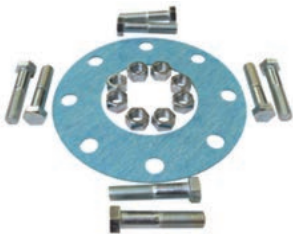

FLANGE GASKET

SIZE	SVI PART #
3"	QP-1607-905
4"	QP-1608-905
6"	QP-1609-905



FLANGE CONNECTIONS

SIZE	SVI PART #
3"	QP-1607-900



FLANGE CONNECTIONS

SIZE	SVI PART #
4"	QP-1608-900
6"	QP-1609-900

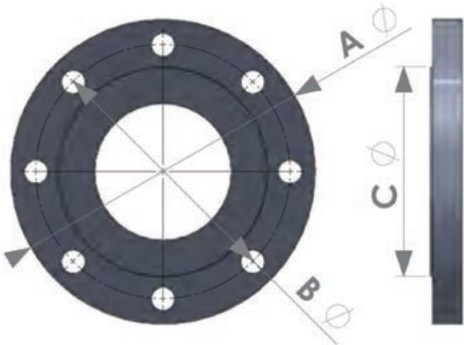

FLANGE DIMENSIONS

SIZE	A	B	C	BOLT HOLES
3"	7.50	6.00	5.00	4
4"	9.00	7.50	6.18	8
6"	11.00	9.50	8.50	8



JUMPER HOSE STAINLESS STEEL

MAIN SIZE	LENGTH	SVI PART #
4"	36"	QP-1540-234
6"	36"	QP-1540-236



END CAP

SIZE	SVI PART #
3"	QP-1607-006



END CAP

SIZE	SVI PART #
4"	QP-1608-006
6"	QP-1609-006



Modular Aluminum Compressed Air Piping

FASTPIPE COUPLERS / PLUGS



FEMALE

MALE

SAFETY / QUICK COUPLER

Safely exhaust air before disconnecting the valve.

SIZE	CFM	SVI PART #
30 CFM INDUSTRIAL TYPE M		
1/4" NPT Male	30	QP-2270-221
1/2" NPT Male	30	QP-2270-241
1/4" NPT Female	30	QP-2270-220
70 CFM INDUSTRIAL TYPE H		
3/8" NPT Male	70	QP-2290-231
1/2" NPT Male	70	QP-2290-241
3/8" NPT Female	70	QP-2290-230
1/2" NPT Female	70	QP-2290-240



MALE

FEMALE

COUPLER PLUGS • M-STYLE • INDUSTRIAL

SIZE	CFM	SVI PART #
30 CFM INDUSTRIAL TYPE M		
1/4" NPT Male	30	AS-0727
1/4" NPT Female	30	AS-0728
70 CFM INDUSTRIAL TYPE H		
1/4" NPT Male	70	QP-2280-221
3/8" NPT Male	70	QP-2280-231
1/2" NPT Male	70	QP-2280-241
1/4" NPT Female	70	QP-2280-220
3/8" NPT Female	70	QP-2280-230
1/2" NPT Female	70	QP-2280-240

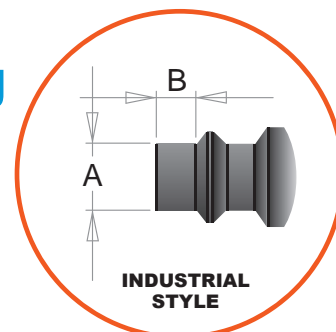

INDUSTRIAL STYLE

DIMENSION	A	B	TYPE
30 CFM			
1/4" BODY	5/16"	3/16"	M
70 CFM			
3/8" BODY	7/16"	5/16"	H



Check out SVI's Air System Parts Catalog

PUSH TO CONNECT M-STYLE COUPLER 30 CFM BODY

Brass / Industrial Style
Type M

When ordering mating
plugs, must use 30 CFM plug.

Push to connect style coupler allows the male plug to be seated without "pulling back" the sleeve. Simply push the male plug into the coupler body until it clicks. Release by holding male plug securely and pulling sleeve forward.

QP-2260-220 • 1/4" FNPT

QP-2260-221 • 1/4" MNPT

QP-2260-241 • 1/2" MNPT



QUICK COUPLER PLUG PACK

- (3) Pieces 1/4" Male Thread
- (3) Pieces 1/4" Female Thread
- Industrial Style, Type M 30 CFM
- When ordering couplers, must use 30 CFM coupler
- Heat Treated Steel, Zinc Plated

SVI Part #	Description
QP-2250-226	1/4" NPT Quick Coupler Plug Pack 3 each Female & Male



Modular Aluminum Compressed Air Piping

SADDLE DROPS Add a drop to an existing line.



SADDLE DROP
(Pipe x Pipe)

MAIN SIZE	DROP SIZE	SVI PART #
1"	1"	QP-1542-210
1½"	¾"	QP-1544-110
1½"	1"	QP-1544-210
2"	¾"	QP-1545-110
2"	1"	QP-1545-210

- Need QP-1540-043 9/16" Hole Saw for 1" Main Pipe Size
- Need QP-1540-044 ¾" Hole Saw for 1-1/2", 2" and 3" Main Pipe Size



SADDLE DROP
(Pipe x Female NPT)

MAIN SIZE	DROP SIZE	SVI PART #
1"	1/4" NPT	QP-1542-011
1"	1/2" NPT	QP-1542-012
1"	3/4" NPT	QP-1542-112
1½"	1/4" NPT	QP-1544-011
1½"	1/2" NPT	QP-1544-012
1½"	3/4" NPT	QP-1544-112
2"	1/4" NPT	QP-1545-011
2"	1/2" NPT	QP-1545-012
2"	3/4" NPT	QP-1545-112

SADDLE DROP DRILL BIT / GASKET

MAIN SIZE	DRILL BIT PART #	GASKET #
1"	9/16" QP-1540-043	QP-1542-210C
1½"	¾" QP-1540-044	QP-1544-210C
2"	¾" QP-1540-044	QP-1545-210C
3"	¾" QP-1540-044	QP-1607-210C
4", 6"	15/16" QP-1540-045	Call



SADDLE DROP
(Pipe x Pipe)

MAIN SIZE	DROP SIZE	SVI PART #
3"	¾"	QP-1607-110
3"	1"	QP-1607-210



SADDLE DROP
(Pipe x Female NPT)

MAIN SIZE	DROP SIZE	SVI PART #
3"	1/2" NPT	QP-1607-012
3"	3/4" NPT	QP-1607-112
3"	1" NPT	QP-1607-312



SADDLE DROP
(Pipe x Pipe)

MAIN SIZE	DROP SIZE	SVI PART #
4"	1"	QP-1608-312
6"	1"	QP-1609-312



SADDLE DROP
(Pipe x Female NPT)

MAIN SIZE	DROP SIZE	SVI PART #
4"	1" NPT	QP-1608-312A
6"	1" NPT	QP-1609-312A

SADDLE DROP INSTALLATION

- System must be de-pressurized before installing.
 - To prevent chips from entering the pipe interior, stop drilling occasionally and blow out chips, grease the end of the drilling tool
1. Position saddle drop opposite the side of the pipe that needs the hole. Tighten securely and mark the pipe by the raised locating mark on the fitting. Mark the pipe both horizontally and vertically along the fitting edge.
 2. Drill thru one side of the pipe with the drill bit, using the hole in the fitting as a locator.
 3. Insert the saddle drop gasket into the molded cavity.
 4. Position the saddle drop over the drilled hole with aligning marks, tighten securely.
 5. Attach the necessary drop pipe or threaded adapter.





Modular Aluminum Compressed Air Piping

MOUNTINGS—SUPPORT PIPE EVERY 10 FT. AND ONE SIDE OF FITTING

FLAT SURFACE INSTALLATION

- Use pipe clips to secure pipe to any flat surface with mounting screw
- Ceiling or Wall Mount
- Clip has 5/16" Thru Hole and Hex Bore for a 5/16" Hex Nut
- Hex Nut serves as a backer for screws.
- In horizontal installations, mount clip pivot tab up.

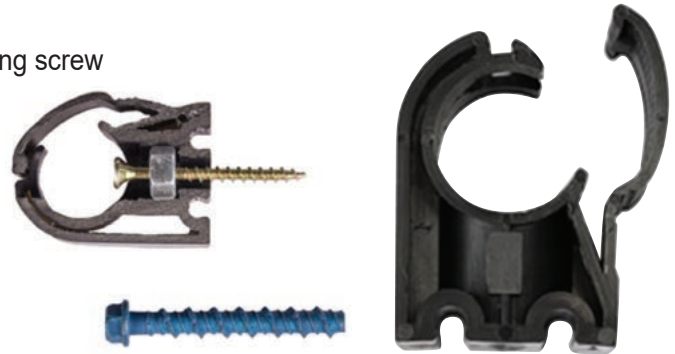

PIPE CLIPS

MAIN SIZE	X DIMENSION	SVI PART #	QTY	NOTES
3/4"	15/16"	QP-1541-022-10	10-Pack	Thru Hole, or use 5/16" Threaded Rod
1"	7/8"	QP-1542-022-10	10-Pack	Thru Hole, or use 5/16" Threaded Rod
1½"	1-15/16"	QP-1544-022-10	10-Pack	Thru Hole, or use 5/16" Threaded Rod
2"	1-3/4"	QP-1545-022-10	10-Pack	Thru Hole, or use 5/16" Threaded Rod
3"		QP-1607-022	1 Piece	Thru Hole, or use 3/8" Threaded Rod

HANGING INSTALLATION



- Beam Clamp
- 5/16" Threaded Rod
- Pipe Clip



- Beam Clamp
- 3/8" Threaded Rod
- Loop Hanger

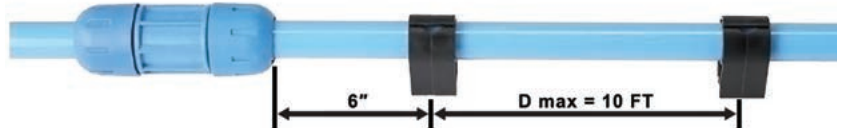

- Hangers or Mounting Clips should be no more than 10 ft. apart and one must be at least 6" from a fitting.
- Do NOT overtighten cantilever-type tube supports, pipe must be allowed to expand and contract slightly in length
- For continuous lengths over 200 ft and variations in temperatures of 80° F, consult SVI for expansion joint guidelines.



- Cantilever Arm
- Cantilever Tube Supports



THREADED ROD

SIZE	SVI PART #
3/8" x 6'	F-TR-0375-16-072

HEX NUTS • 3/8"

QTY	SVI PART #
100	F-HN-0375-16-B100



Modular Aluminum Compressed Air Piping



BEAM CLAMP

SVI PART # QP-1540-018

- Thru Hole Design
- Works for both 5/16" and 3/8" Threaded Rod
- 3/4" Width Opening



LOOP HANGER

For 3/8"-16 Standard Strut;
Accepts 3/8" Threaded Rod

SIZE	SVI PART #
3/4" & 1"	QP-1540-019
1 1/2"	QP-1540-020
2"	QP-1540-024
3"	QP-1600-030
4"	QP-1600-031
6"	QP-1600-032



STRUT CUSHION CLAMP

For 3/8"-16 Standard Strut

SIZE	SVI PART #
3/4"	QP-1540-017
1"	QP-1540-022
1 1/2"	QP-1540-023
2"	QP-1540-025
3"	QP-1600-028
4"	QP-1600-035
6"	QP-1600-040



CANTILEVER ARM

SVI PART # QP-1540-021

- 12" Overall Length
- Standard 1-5/8" Unistrut
- Zinc Plated / Silver Color
- Clamps sold separately



TOOL SETS

SIZE	SVI PART #	
3/4"	QP-1540-136	Spanners, Deburr Tool, Cutter, Spray Bottle
1"	QP-1540-137	Spanners, Deburr Tool, Cutter, Spray Bottle
1 1/2"	QP-1540-138	Spanners, Deburr Tool, Cutter, Spray Bottle
2"	QP-1540-145	Spanners, Deburr Tool, Cutter, Spray Bottle
3"	QP-1600-146	Spanners, Deburr Tool, Cutter, Spray Bottle
3/4"	QP-1541-021	Spanner, Deburr Tool
1"	QP-1542-021	Spanner, Deburr Tool



3/4" THRU 2"

DEBURR TOOL

SIZE	SVI PART #
3/4" & 1"	QP-1540-142
3/4" thru 2"	QP-1540-141
3"	QP-1600-153*

*Electric Drill required for 3"



2 Required

SPANNER WRENCH

SIZE	SVI PART #
3/4"	QP-1541-020 each
1"	QP-1542-020 each
1 1/2"	QP-1544-020 each
2"	QP-1545-020 each
3"	QP-1607-020 each



PIPE CUTTER

SIZE	SVI PART #
3/4" thru 2"	QP-1540-140*
2" thru 3"	QP-1600-148

*For Replacement Pipe Cutter Wheels, order QP-1540-143.



SPRAY BOTTLE

SVI PART #
QP-1540-139



FastPipe Installation • 3/4"–3"

The FastPipe system is only as safe as a thorough installation. Read all provided installation instructions before starting. Each shipment will contain installation instructions, if you do not receive them please call immediately.



Cut pipe to length
with Tubing Cutter (Cut must be square). DO NOT USE HACK SAW.



Deburr the end of the pipe outside and inside (a smooth edge allows easy fitting assembly and no damage to the fitting o-ring)



Mark end of pipe
for the proper insertion depth

3/4" Fittings:	2 inches
1" Fittings:	2-3/4 inches
1-1/2" Fittings:	4 inches
2" Fittings:	4-3/4 inches
3" Fittings:	4-1/2 inches



Wet end of pipe
with very diluted soapy water
DO NOT USE ANY OIL
OR GREASE LUBRICANT



Loosen fitting cone nut partially.
LOOK INSIDE EACH FITTING
FOR INNER PARTS
(inner parts, o-ring,
stainless steel bite ring)



Insert Pipe into fitting until pipe bottoms out.
Hand Tighten Fitting
Fully Tighten Fitting with
FastPipe Spanner Wrenches

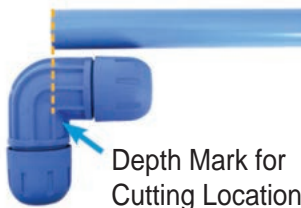

FASTPIPE® BY RAPIDAIR

FastPipe Installation • 4"–6"

The FastPipe system is only as safe as a thorough installation. Read all provided installation instructions before starting. Each shipment will contain installation instructions, if you do not receive them please call immediately.



Cut pipe to length

with Tubing Cutter (Cut must be square). DO NOT USE HACK SAW.



Deburr the end of the pipe outside and inside (a smooth edge allows easy fitting assembly and no damage to the fitting o-ring)



Add marks for lugs

Use the locating notches on the outer edge of the deburr head to add marks for the location of the lugs on the pipe

4" Fittings: 5 lugs

6" Fittings: 8 lugs



Lug the end of pipe

DO NOT OVERLAP THE LUGS



Wet end of pipe

with very diluted soapy water
DO NOT USE ANY OIL
OR GREASE LUBRICANT

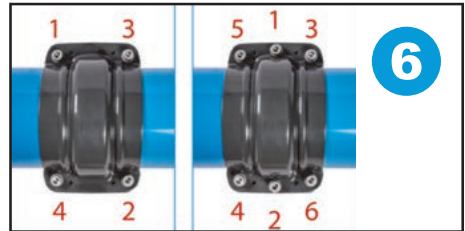

Tighten bolts

per sequence shown
15 ft. lbs–20 ft. lbs max
DO NOT USE AN IMPACT



LUG TOOL JAW SET

SIZE	SVI PART #
4"–6"	QP-1609-021



CORDLESS LUGGING TOOL

SIZE	SVI PART #
4"–6"	QP-1609-020



DEBURR TOOL

SIZE	SVI PART #
4"	QP-1600-154
6"	QP-1600-155



PIPE CUTTER

SIZE	SVI PART #
4"–6"	QP-1600-149



WARNINGS

- Compressed air is DANGEROUS if not used properly
- Always use EYE PROTECTION when using compressed air
- DO NOT POINT compressed air at your body or any person
- Pressurize system SLOWLY
- TURN OFF air compressor when not in use
- CHECK local building codes before installation
- ALWAYS RELIEVE the system pressure when installing or performing maintenance
- Systems must have a SAFETY RELIEF valve installed at the compressed air source to prevent over pressurization
- When using FastPipe in direct sunlight, cover or paint the polymer fittings to protect from UV exposure (Pipe needs no covering and can be exposed)
- Keep children away from the system

FastPipe is NOT Designed:

- For underground burial
- To electrically ground equipment
- To be welded
- To take violent impacts
- To be used where the compressed air temperature is above 140° F
- For environments of caustic or corrosive chemicals

 **WARNING:** This product can expose you to chemicals including lead, which is known to the State of California to cause cancer. For more information, go to www.P65Warnings.ca.gov.

Wash hands after handling.

CONTAINS LEAD: MAY BE HARMFUL IF EATEN OR CHEWED. MAY GENERATE DUST CONTAINING LEAD. KEEP OUT OF THE REACH OF CHILDREN.

Installation Tips & Recommendations

Care must be taken on any installation of the FastPipe system. Pipes will be carrying compressed air / gas up to 190 psi. The FastPipe system is only as safe as a thorough installation. Read all installation instructions before starting. Below are some tips for a safe installation. We strongly recommend that the installer contact our tech department for installation questions PRIOR to the installation.

- Assemble all NPT **PIPE THREADS** with two wraps of Teflon tape and then pipe sealant which prevents thread galling.
- Support the pipe with clips/ hangers a maximum of **10 FT. SPACING** and on **ONE SIDE OF EACH FITTING**.
- FastPipe can be bent to a maximum of 15° **DO NOT OVER BEND**. 3/4" Fastpipe can be bent to 45°.
- Any machine/compressor plumbed to the FastPipe must have a **JUMPER HOSE** to reduce vibration.
- Any piping system will expand and contract with temperature changes. Use **EXPANSION JOINTS** to compensate for this movement of aluminum pipe in non-conditioned buildings.
- **DO NOT USE** FastPipe for **PULSING** desiccant dryers or other like equipment.
- **CAUTION** installing inert gas bulk tank systems, gas must be warmed up to FastPipe temperature range.
- Use a strain relief attached to the building for any rubber hose drops attached to the piping.
- **DO NOT** connect quick couplings for air hoses to reducing elbows or tee fittings. The constant connecting/ disconnecting and pulling or air hoses could loosen the fitting. Use the FastPipe **WALL OUTLET** which can be secured to a wall or post. Any hoses attached in the ceiling area to a fitting must use a strain relief attached to the building structure.
- **CHECK** that all fittings are tightened before pressurizing the system for the first time.
- For initial installation, pressurize system **SLOWLY** to 50 psi and check for leaks, then pressurize slowly to MAX 190 psi.
- **AFTER 24 HOURS** of being pressurized, depressurize the system and **RETIGHTEN** the compression nuts. Some settling of components may have occurred. **This is not optional, it must be done.**
- Make sure compressor output temperature does not exceed **140° F**.
- Products manufactured by the seller carry a limited one year warranty. Contact SVI for more details.



Industrial Compressed Air Piping System

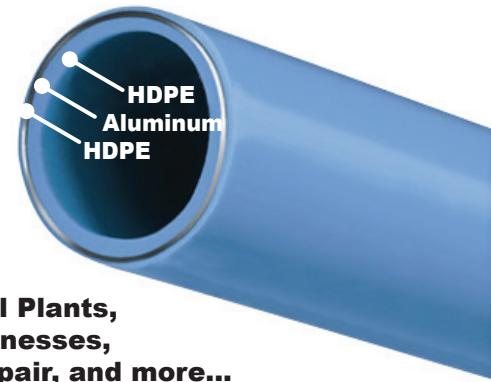

*Industrial Semi-Flexible,
Leak-Proof
Compressed Air Tubing*

MAXLINE by RapidAir

Multi Layer Tubing
(HDPE-Aluminum-HDPE)
Maintains Shape After Bending

1/2" • 3/4" • 1" • 2"
Available in 25 ft, 50 ft,
100 ft, 300 ft rolls

TECHNICAL SPECS

Working Pressure
200 psi at 73°, 160 psi at 140°
Temperature Range: -40° to 140° F

**Compressed Air, Inert Gas such
as Argon or CO₂, and Vacuum**

- Compatible with common compressor oils.
- Can be Direct Buried
- 1/2", 3/4" 1", 2"
- Multi-Layer Semi Flexible Tubing
- Inner and Outer Layer - HDPE
- Center Layer - Aluminum
- Sizes Measured on Inside Diameter

RATINGS

OSHA Compliant /
Complies with ASTM F1282
ASTM F1974

FITTINGS: Compression Style
Nickel Plated Brass
(Stainless Steel option)

**Distance from the compressor
to the farthest outlet point**
up to 75 ft use 1/2" MaxLine
up to 200 ft use 3/4" MaxLine
up to 300 ft use 1" MaxLine

IDEAL FOR: Layouts with Many
Obstructions and Corners, Industrial Plants,
Manufacturing Facilities, Small Businesses,
Auto Shops, Farms, Heavy Truck Repair, and more...

APPLICATIONS—CHOOSE MAXLINE FOR:

- Fast and Easy to Install
- Cost Effective
- Leak Proof
- Corrosion Resistant

MaxLine's multilayer construction can be easily bent by hand and maintain its desired shape, giving a professional appearance with no tubing sag. Rolls allow for faster installation times, with fewer joints. Its smooth interior walls will never build up scale or rust making it an efficient air system. MaxLine piping can be mounted on wall surfaces, in wall for new construction and be directly buried under ground or concrete.

This system is easily configured and can be modified. MaxLine fittings are nickel plated brass designed for years of long term performance. Its double o-ring compression design is engineered to be a leak proof system, that can be easily disassembled and reused.

- Great for a layout that involves many obstructions or corners
- Long continuous piping lengths
- Underground direct burial of the piping
- Installing in Wall or On Wall
- A lower cost option than FastPipe

QUICK INSTALLATION

- Long tubing rolls allow for fewer joints
- Compression fittings reduce labor
- Bury underground or underneath concrete
- Expand or modify the system layout with ease

ADAPTABLE

- Install in small shops to large manufacturing facilities
- On wall, in wall and underground applications
- Connect to any existing piping system

AIR QUALITY—ENERGY EFFICIENT

- No corrosion with HDPE tubing and nickel-plated fittings
- Double o-ring design ensures leak-free joints
- Efficient flowing smooth inner wall

BURIAL

- This product can be direct buried in the soil or under concrete
- Wrap all fittings underground and do a pressure test before covering



Industrial Compressed Air Piping System

ASSEMBLY OF THREADED COMPONENTS

Assemble all NPT threads with two wraps of teflon tape and then PIPE SEALANT which prevents thread galling.



PLANNING / LAYOUT

Before beginning the installation, create a plan as to the location of the air compressor and where you are going to mount the compressed air outlets. On the plan locate outlets, tees, and elbows if needed.

AIR COMPRESSOR

Use a flexible jumper hose from the air compressor to the filter regulator unit to reduce vibration to the Maxline tubing.

FILTER / REGULATOR

A good quality filter regulator is recommended to catch particles, moisture and oils entering the air system as well as to maintain a constant pressure to your air tools.

MaxLine will hold any bent shape.

Bend Radius

- 1/2" Tubing: 4-6 inches
- 3/4" Tubing: 8-10 inches
- 1" Tubing: 10-12 inches
- 2" Tubing: 36-48 inches

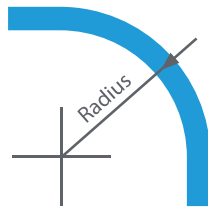

1/2", 3/4", 1" Fittings

- Compression with Split Ring
- Nickel-Plated Brass
- Double O-Ring: Nitrile

2" Fittings

- Crimp Style
- Nickel-Plated Brass Body
- Crimp Ring: Stainless Steel
- Double O-Ring: Nitrile

BENDING THE TUBING

The Maxline tubing can be bent to hold any shape. Care should be taken not to kink the tubing, but rather bend the tubing in a sweeping radius around corners and obstacles. Elbow fittings are available for sharp corners.

TUBING INSTALLATION

Maxline tubing will expand and contract slightly with changes in temperature.

Use wall clips spaced 5 ft. for 3/4" and 1" tubing, 3 ft for 1/2" tubing.





Industrial Compressed Air Piping System
MAXLINE MASTER KITS

1/2"
SYSTEM

1/2"
SYSTEM



MaxLine Master Kits
Available for All Sizes
Call SVI today!

SVI #	Description
QP-9103-800 Maxline 1/2 in. 1/2" Master Kit • 100 ft. • 3 Outlets	
Kit contains:	
(1) QP-9106-026	100 ft. x 1/2" MaxLine Tubing
(1) QP-9138-220	Manifold Block (3/8" Ports x 4)
(3) QP-5590-120	Outlet Blocks
(4) QP-5550-135	3/8" NPT Plugs
(1) QP-9108-010	Tee Fitting
(5) QP-9108-080	Elbow Fittings
(3) QP-5550-120	3/8" NPT Drain Valves
(6) QP-9108-001	1/2" Tubing x 3/8" NPT Fitting
(1) QP-9108-002	1/2" Tubing x 1/2" NPT Fitting
(3) QP-5550-130	1/4" 45° Brass St. Elbows
(1) QP-9108-091	Tubing Cutter
(1) QP-9108-095	Bevel Tool
(5) QP-9108-054	Spare O-Rings

Set up a compressed air system with the 1/2 in. MaxLine Master Kit with 3 air outlet locations. The MaxLine Semi-Flexible Compressed Air Tubing has an aluminum core sandwiched between an inner and outer layer of polyethylene. Tubing holds any hand bent shape. Reduce shop clutter with this industrial compressed air piping system. No glue, soldering or crimping needed. Simply cut the tubing to length, insert in the fitting and tighten. Easy to expand with more air outlet locations or modify later. Tubing size is 5/8" OD x 1/2" ID.

Use only with Maxline 1/2 in. system.

Use QP-9108-064 Wall Clips • Use RapidAir Coupler QP-2270-221
Use Filter Regulator QP-2293-216 1/2 Ports

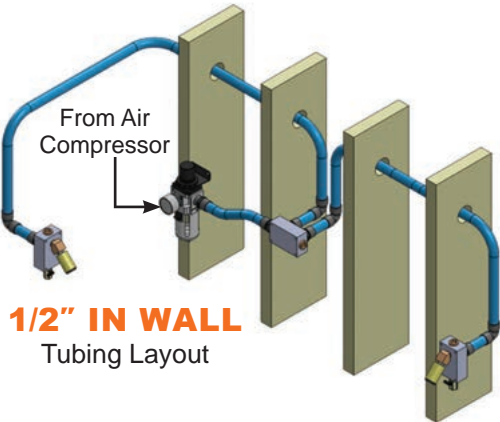
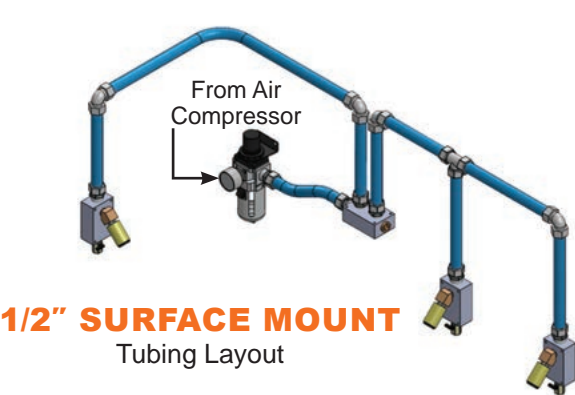

Need a different size tubing or ready to order—Call SVI Today 800-321-8173



Industrial Compressed Air Piping System

MAXLINE MASTER KITS (continued)

3/4"
SYSTEM

3/4"
SYSTEM



MaxLine Master Kits
Available for All Sizes
Call SVI today!

SVI # Description

QP-9107-500 Maxline 3/4 in. **3/4" Master Kit • 100 ft. • 3 Outlets**

QP-9107-580 Maxline 3/4 in. **3/4" Master Kit • 300 ft. • 3 Outlets**

Kit contains:

(1)	QP-9106-030	100 ft. x 3/4" MaxLine Tubing
(1)	QP-9106-031	OR 300 ft. x 3/4" MaxLine Tubing
(3)	QP-9118-010	Aluminum Blocks
(3)	QP-5550-136	1/2" NPT Plugs
(1)	QP-9108-011	Tee Fitting
(3)	QP-5550-120	3/8" NPT Drain Valves
(6)	QP-9108-003	3/4" Tubing x 3/4" NPT Fitting
(1)	QP-9108-005	3/4" Tubing x 1/2" NPT Fitting
(2)	QP-9108-065	Mount Clips (10/pack)
(1)	QP-9108-091	Tubing Cutter
(1)	QP-9108-095	Bevel Tool
(5)	QP-9105-055	Spare O-Rings

Set up a compressed air system with the 3/4 in. MaxLine Master Kit with 3 air outlet locations. The MaxLine Semi-Flexible Compressed Air Tubing has an aluminum core sandwiched between an inner and outer layer of polyethylene. Tubing holds any hand bent shape. Reduce shop clutter with this industrial compressed air piping system. No glue, soldering or crimping needed. Simply cut the tubing to length, insert in the fitting and tighten. Easy to expand with more air outlet locations or modify later. Tubing size is 1" OD x 3/4" ID.

Use only with Maxline 3/4 in. system.

Outlets have 1/2" Female NPT Ports—Use QP-2270-241 1/2" MNPT Safety Quick (Type M) Coupler or use reducer bushing if your couplers are 1/4" NPT. Coupler & Bushing not included.

Use Jumper Hose QP-1540-215 3/4" x 3 Ft.

Use Filter Regulator QP-2293-217 3/4" Ports

Fitting Box: QP-9107-500/580FV • 3/4" MaxLine Fittings, Valves, Hardware Only





Industrial Compressed Air Piping System
MAXLINE MASTER KITS



<div>1" SYSTEM</div> <div>MaxLine Master Kits Available for All Sizes Call SVI today!</div>	SVI #	Description
	QP-9106-580	<p>Maxline 1 in. 1" Master Kit • 300 ft.</p> <p>HIGHER FLOW RATE: This QP-9106-580 1" Maxline 300FT Master Kit flows at 81 CFM at 300FT, versus the QP-9107-580 3/4" equivalent that flows at 39 CFM at 300FT.</p> <p>200 PSI Maximum working pressure Compression style nickel plated brass fittings.</p> <p>Set up a compressed air system with the 1 in. MaxLine Master Kit with 3 air outlet locations. The MaxLine Semi-Flexible Compressed Air Tubing has an aluminum core sandwiched between an inner and outer layer of polyethylene. Tubing holds any hand bent shape. Reduce shop clutter with this industrial compressed air piping system. No glue, soldering or crimping needed. Simply cut the tubing to length, insert in the fitting and tighten. Easy to expand with more air outlet locations or modify later. Tubing size is 1.2" OD x 1" ID.</p> <p>Use only with Maxline 1 in. system.</p> <p>Use QP-9108-066 Mount Clips • Use RapidAir Coupler QP-2270-241 Use Filter Regulator QP-2293-218</p>

Need a different size tubing or ready to order—Call SVI Today 800-321-8173



Industrial Compressed Air Piping System

MAXLINE TUBING

MaxLine compressed air tubing has an aluminum core sandwiched between an inner and outer layer of polyethylene. Tubing can be mounted on wall surfaces, in wall, or buried underground or concrete. Kit 100 ft or more include cutter and deburr too. *Lengths shorter than 100 ft do NOT include cutter and deburr tool.



MaxLine Master Kits
Available for All Sizes
Call SVI today!

BLUE TUBING FOR COMPRESSED AIR

SIZE	PART #	OUTSIDE	INSIDE	LENGTH
1/2"	QP-9106-026-25	.63 in.	.50 in.	25 ft*
1/2"	QP-9106-026-50	.63 in.	.50 in.	50 ft*
1/2"	QP-9106-026	.63 in.	.50 in.	100 ft
1/2"	QP-9106-027	.63 in.	.50 in.	300 ft
3/4"	QP-9106-030-25	.98 in.	.80 in.	25 ft*
3/4"	QP-9106-030-50	.98 in.	.80 in.	50 ft*
3/4"	QP-9106-030	.98 in.	.80 in.	100 ft
3/4"	QP-9106-031	.98 in.	.80 in.	300 ft
1"	QP-9106-032	1.26 in.	1.02 in.	100 ft
1"	QP-9106-033	1.26 in.	1.02 in.	300 ft
2"	QP-9106-520-100	2.50 in.	2.00 in.	100 ft
2"	QP-9106-520	2.50 in.	2.00 in.	200 ft



GREEN TUBING FOR INERT GAS

SIZE	PART #	OUTSIDE	INSIDE	LENGTH
1/2"	QP-9106-026G	.63 in.	.50 in.	100 ft
1/2"	QP-9106-027G	.63 in.	.50 in.	300 ft
3/4"	QP-9106-030G	.98 in.	.80 in.	100 ft
3/4"	QP-9106-031G	.98 in.	.80 in.	300 ft
1"	QP-9106-032G	1.26 in.	1.02 in.	100 ft
1"	QP-9106-033G	1.26 in.	1.02 in.	300 ft



MOUNT CLIPS 10-PACK

SIZE	PART #	SPACING
1/2"	QP-9108-064	3 ft.
3/4"	QP-9108-065	4-5 ft.
1"	QP-9108-066	4-5 ft.



STRUT CLAMP FOR 1-5/8" STRUT

SIZE	PART #	SPACING
1/2"	QP-6001-001	3 ft.
3/4"	QP-1540-022	4-5 ft.
1"	QP-6001-002	4-5 ft.
2"	QP-6001-003	8 ft.



Industrial Compressed Air Piping System

FITTINGS • NICKEL-PLATED BRASS • 1/2" / 3/4" / 1"



UNION

SIZE	SVI PART #
1/2" x 1/2"	QP-9108-021
1/2" x 3/4"	QP-9108-024
1/2" x 1"	QP-9108-020
3/4" x 3/4"	QP-9108-022
3/4" x 1"	QP-9108-025
1" x 1"	QP-9108-023



ELBOW

SIZE	SVI PART #
1/2"	QP-9108-080
3/4"	QP-9108-067
1"	QP-9108-068



TEE

SIZE	SVI PART #
1/2"	QP-9108-010
3/4"	QP-9108-011
1"	QP-9108-012



CROSS

SIZE	SVI PART #
1/2"	QP-9108-041
3/4"	QP-9108-042
1"	QP-9108-043



REDUCING TEE

SIZE	SVI PART #
3/4" x 1/2" x 3/4"	QP-9108-014
1" x 1/2" x 1"	QP-9108-016
1" x 3/4" x 1"	QP-9108-018



REDUCING TEE FEMALE NPT

SIZE	SVI PART #
1/2" x 1/2" x 1/2"	QP-9108-019
3/4" x 1/2" x 3/4"	QP-9108-078
1" x 3/4" x 1"	QP-9108-089

For 1/2"
MaxLine

1/2"
FNPT



SINGLE PORT ELBOW

SIZE	SVI PART #
1/2" MaxLine x 1/2" FNPT	QP-9108-009



INLINE VALVE

SIZE	SVI PART #
1/2"	QP-9108-038
1/2"	QP-9108-038TEE
3/4"	QP-9108-039
1"	QP-9108-040



SPARE PARTS ORING

Buy Individually or 10-Pack

SIZE	SVI PART #
1/2"	QP-9108-054
1/2"	QP-9108-054-10
3/4"	QP-9108-055
3/4"	QP-9108-055-10
1"	QP-9108-056
1"	QP-9108-056-10



SPARE PARTS SPLIT RING

SIZE	SVI PART #
1/2"	QP-9108-047
3/4"	QP-9108-048
1"	QP-9108-049



Industrial Compressed Air Piping System

FITTINGS • NICKEL-PLATED BRASS • 1/2" / 3/4" / 1"



STRAIGHT FITTING TUBING / MALE NPT

SIZE	SVI PART #
1/2" x 3/8" NPT	QP-9108-001
1/2" x 1/2" NPT	QP-9108-002
3/4" x 1/2" NPT	QP-9108-005
3/4" x 3/4" NPT	QP-9108-003
1" x 3/4" NPT	QP-9108-015
1" x 1" NPT	QP-9108-004



ELBOW • MALE NPT

SIZE	SVI PART #
1/2" x 1/2" NPT	QP-9108-085
3/4" x 1/2" NPT	QP-9108-086
3/4" x 3/4" NPT	QP-9108-088
1" x 1" NPT	QP-9108-090



HEX NUT

SIZE	SVI PART #
1/2" NPT	QP-9108-057
3/4" NPT	QP-9108-058
1" NPT	QP-9108-059



STRAIGHT FITTING TUBING / FEMALE NPT

SIZE	SVI PART #
1/2" x 1/2" NPT	QP-9108-006
3/4" x 3/4" NPT	QP-9108-007



END CAP

SIZE	SVI PART #
1/2"	QP-9108-026
3/4"	QP-9108-027
1"	QP-9108-028



STAINLESS STEEL STRAIGHT FITTING TUBING / MALE NPT

SIZE	SVI PART #
1/2" x 1/2" NPT	QP-9108-030
3/4" x 3/4" NPT	QP-9108-031
1" x 1" NPT	QP-9108-032



STAINLESS STEEL TEE

SIZE	SVI PART #
1/2"	QP-9108-033
3/4"	QP-9108-034
1"	QP-9108-035



Industrial Compressed Air Piping System

FITTINGS • NICKEL-PLATED BRASS • 2" • Requires Crimping Tool QP-1609-020



REQUIRES HYDRAULIC
CRIMP TOOL

UNION

SIZE	SVI PART #
2" x 2" NPT	QP-9108-525



REQUIRES HYDRAULIC
CRIMP TOOL

ELBOW

SIZE	SVI PART #
2"	QP-9108-535



REQUIRES HYDRAULIC
CRIMP TOOL

TEE

SIZE	SVI PART #
2"	QP-9108-530



REQUIRES HYDRAULIC
CRIMP TOOL

REDUCING TEE FE-
MALE NPT

SIZE	SVI PART #
2" x 1" FNPT X 2"	QP-9108-531



REQUIRES HYDRAULIC
CRIMP TOOL

STRAIGHT TUBING -
MALE NPT

SIZE	SVI PART #
2" x 1" NPT	QP-9108-541
2" x 2" NPT	QP-9108-542



SPARE PARTS
ORING

SIZE	SVI PART #
2"	QP-9108-559



SPARE CRIMP
SLEEVE

SIZE	SVI PART #
2"	QP-9108-549





Industrial Compressed Air Piping System



**SINGLE
PORT
OUTLET**

SIZE	OUTLET	SVI PART #
1/2"	1/4" NPT	QP-9103-810
1/2"	1/2" NPT	QP-9118-101
3/4"	1/2" NPT	QP-9107-510
For clamshell packaged, order QP-9107-510-2		



**SINGLE
PORT
OUTLET
WITH
SHUTOFF**

SIZE	OUTLET	SVI PART #
1/2"	1/4" NPT	QP-9103-810V
1/2"	1/2" NPT	QP-9108-101V
3/4"	1/2" NPT	QP-9107-510V
For clamshell packaged, order QP-9107-510V-2		

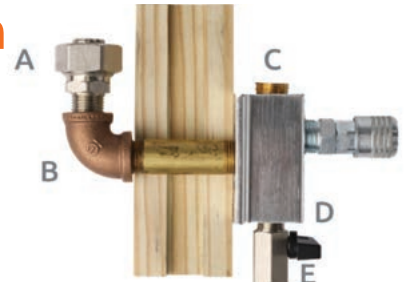

Customer-Supplied 1/2" NPT Nipple
Length Varies Per Wall Thickness

THRU WALL OUTLET
(Kit Includes A, B, C, D, E)

SIZE	OUTLET	SVI PART #
1/2"	1/4" NPT	QP-9103-810W
3/4"	1/2" NPT	QP-9107-510W



**MULTI-PORT
WALL OUTLET**

(Has Bottom Moisture Drain)

SIZE	OUTLET	SVI PART #
1/2"	1/2" NPT x 4	QP-9108-200
3/4"	1/2" NPT x 4	QP-9108-201
1"	1/2" NPT x 4	QP-9108-203

Each side of outlet has
an extra 1/2" NPT port
2 plugs included



**MULTI-PORT
WALL OUTLET
WITH SHUTOFF**

(Has Bottom Moisture Drain)

SIZE	OUTLET	SVI PART #
1/2"	1/2" NPT x 4	QP-9108-200V
3/4"	1/2" NPT x 4	QP-9108-201V
1"	1/2" NPT x 4	QP-9108-203V



COUPLERS / PLUGS • INDUSTRIAL STYLE



SAFETY / QUICK COUPLER

Safely exhaust air before
disconnecting the valve.

SIZE	CFM	SVI PART #
30 CFM INDUSTRIAL TYPE M		
1/4" NPT Male	30	QP-2270-221
1/2" NPT Male	30	QP-2270-241
1/4" NPT Female	30	QP-2270-220

70 CFM INDUSTRIAL TYPE H		
3/8" NPT Male	70	QP-2290-231
1/2" NPT Male	70	QP-2290-241
3/8" NPT Female	70	QP-2290-230
1/2" NPT Female	70	QP-2290-240



QUICK COUPLER PLUGS M-STYLE

SIZE	CFM	SVI PART #
30 CFM INDUSTRIAL TYPE M		
1/4" NPT Male	30	AS-0727
1/4" NPT Female	30	AS-0728

70 CFM INDUSTRIAL TYPE H		
1/4" NPT Male	70	QP-2280-221
3/8" NPT Male	70	QP-2280-231
1/2" NPT Male	70	QP-2280-241
1/4" NPT Female	70	QP-2280-220
3/8" NPT Female	70	QP-2280-230
1/2" NPT Female	70	QP-2280-240

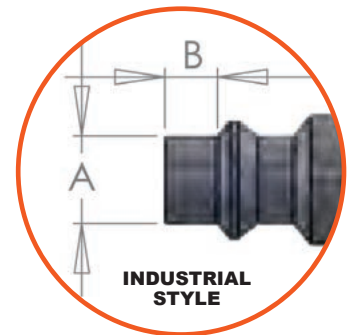

DIMENSION	A	B	TYPE
30 CFM			
1/4 BODY	5/16"	3/16"	M
70 CFM			
3/8 BODY	7/16"	5/16"	H



Industrial Compressed Air Piping System

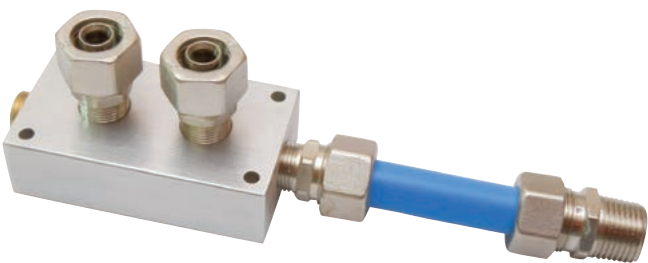

MAXLINE COMPRESSOR
MANIFOLD KIT

SVI PART #	DESCRIPTION
QP-9103-820	1/2" MaxLine Manifold Kit
QP-9138-220	1/2" MaxLine Manifold Only (3/8" Ports)
QP-9108-001	Straight Fitting 1/2" Tubing x 3/8" Male NPT



SINGLE PORT OUTLET -
BLOCK ONLY

SVI PART #	DESCRIPTION
QP-9118-010	Block Only Single Port Outlet 1/2" NPT Outlet
1/2" NPT Ports on top, front and back of block, bottom is 3/8" NPT for drain	
QP-9118-010T	Maxline Block with 1/2" FNPT Both Ends

ALUMINUM MANIFOLDS

Rapidair Aluminum Pneumatic Compressed Air Distribution Manifold Blocks

- 6061 Aluminum Construction
- NPT Ports
- 200 psi rated

Call SVI today for Custom Manifolds—800-321-8173

SVI Part #	Description
QP-0500M-25-4	1/2" Manifold x (4) 1/4 Outlets
QP-0500M-25-5	1/2" Manifold x (5) 1/4 Outlets
QP-0500M-50-4	1/2" Manifold x (4) 1/2" Outlets
QP-0500M-50-5	1/2" Manifold x (5) 1/2" Outlets
QP-0500MB-50-2	1/2" Manifold x (2) 1/2" Outlets
QP-0750M-50-3	3/4" Manifold x (3) 1/2 Outlets
QP-0750M-50-4	3/4" Manifold x (4) 1/2 Outlets
QP-0750M-50-5	3/4" Manifold x (5) 1/2 Outlets
QP-0750M-75-3	3/4" Manifold x (3) 3/4" Outlets
QP-0750M-75-4	3/4" Manifold x (4) 3/4" Outlets
QP-0750M-75-5	3/4" Manifold x (5) 3/4" Outlets
QP-1000M-75-3	1" Manifold x (3) 3/4 Outlets
QP-1000M-75-4	1" Manifold x (4) 3/4 Outlets
QP-1000M-75-5	1" Manifold x (5) 3/4 Outlets





Tools / Accessories



MAXLINE TUBING BENDER TOOL QP-9108-096 • Bender Tool Includes:

- Case
- Dies for 1/2"-3/4" and 1" Maxline
- Hand Ratchet Mechanism
- Make perfect bends in MaxLine tubing with the Maxline Tubing Bender Tool.
- MaxLine Semi-Flexible Rolled Compressed Air Plastic Tubing will hold any bent shape so use this tool for a professional looking installation

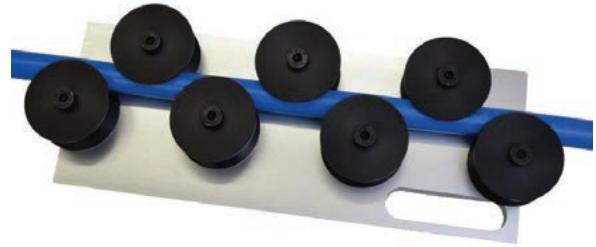

MAXLINE WHEEL STRAIGHTENER TOOL

QP-9108-097 • Bender Tool Includes:

- Use the MaxLine Wheel Straightener Tool to straighten the semi-flexible MaxLine tubing, which will make it easier to mount on a wall.
- Clamp in a vise or to a bench and pull the MaxLine tubing through these rotating wheels.
- Adjustable for 1/2", 3/4" and 1" this tool for a professional looking installation
- Also see our bending tool (sold separately), used to help bend the tubing to the precise angles needed.

MAXLINE BEVELING TOOL QP-9108-095 • 1/2", 3/4", AND 1"

Use to prep the end of the Maxline tubing before inserting the fitting.
Chamfers tubing sizes 1/2, 3/4, 1"



MAXLINE DEBURR TOOL QP-9108-595 • 2" ONLY

Bevels and Deburrs



PIPE CUTTER FOR MAXLINE / DURATEC

Required for installation.

QP-9108-051 • 1/2" – 3/4" – 1"

QP-9108-091 • 1/2" – 3/4"



MAXLINE CUTTER QP-9108-551 • 2" ONLY



MAXLINE CORDLESS PRESS TOOL

For installation of Maxline 2"
Fittings and Flex Aluminum Tubing.
QP-1609-020



PIPE WRAP TAPE • 10 mil Thick

Use for wrapping MaxLine Fittings in underground installation. Waterproof.

QP-9108-098 • 2" X 100 ft.



MAXLINE 2" CRIMP HEAD, WITH ALUMINUM EXPANDER PLUG

QP-9108-591

For use with Battery Power
Tool QP-1609-020.





1/2" • 3/4" • 1"

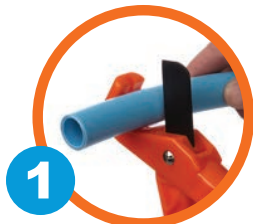

Cut the tubing square with the cutter, ROTATING wrist while cutting.



Bevel the inside of the tubing by inserting the reaming tool and rotating it at least 3 full turns. Remove nut and split ring from fitting and place on tubing.



Push the fitting onto the tubing and fully against the shoulder of the fitting (soapy water will help this process).



Turn the nut hand tight. Put a reference mark on the nut and fitting body.



Tighten nut with wrench a minimum 3/4 of a turn or until tight.

2"



Cut the tubing square with the wheelttype cutter, apply extra pressure so wheel does not walk out of cut groove.



Apply soapy water to the ALUMINUM plunger. Use a soft hammer to pound the plunger into the tubing and back out again (this makes the tubing round after cutting).



Bevel the inside of the tubing with the reaming tool. Rotating repeatedly until a large chamfer forms.



Apply soapy water to the fitting and tubing end. Put crimp sleeve on the tubing, and push fitting stem into the tubing fully.



Crimp fitting 3 times with hydraulic tool, each 120 degrees apart.



Completed crimp



⚠️ WARNINGS

- Compressed air is DANGEROUS if not used properly
- Always use EYE PROTECTION when using compressed air
- DO NOT POINT compressed air at your body or any person
- Pressurize system SLOWLY
- TURN OFF air compressor when not in use
- CHECK local building codes before installation
- ALWAYS RELIEVE the system pressure when installing or performing maintenance
- Systems must have a SAFETY RELIEF valve installed at the compressed air source to prevent over pressurization
- When using MaxLine in direct sunlight, cover or paint the plastic tubing to protect from UV exposure (Fittings need no covering and can be exposed)
- Keep children away from the system

MaxLine is NOT Designed:

- To be glued
- To take violent impacts
- To be used where the compressed air temperature is above 140° F
- For environments of caustic or corrosive chemicals

⚠️ **WARNING:** This product can expose you to chemicals including lead, which is known to the State of California to cause cancer. For more information, go to www.P65Warnings.ca.gov. **Wash hands after handling.**

CONTAINS LEAD: MAY BE HARMFUL IF EATEN OR CHEWED. MAY GENERATE DUST CONTAINING LEAD. KEEP OUT OF THE REACH OF CHILDREN.

Installation Tips & Recommendations

MAXLINE INSTALLATION TRAINING: Care must be taken on any installation of the MaxLine system. Tubing will be carrying compressed air / gas up to 200 psi. The MaxLine system is only as safe as a thorough installation. Read all installation instructions before starting. Below are some tips for a safe installation. Each shipment will contain installation instructions, if you do not receive them please call immediately. We strongly recommend that the installer contact with installation questions PRIOR to the installation.

- **CUT** the tubing **STRAIGHT** with the supplied cutter; do not use a hacksaw.
- **CHAMFER** the end of the tubing with the supplied tool. When pushing the tubing into the fitting, the o-ring must insert smoothly. If the end of the tube is sharp, it will cut the o-ring and **CAUSE LEAKS**. Use a spray bottle with a couple of drops of dish soap and fill it with water for lubrication.
- **TUBING** must be **INSERTED** into the fitting fully to the shoulder inside.
- Fitting nuts must be tightened to a minimum of 3/4 of a turn.
- Support the tubing with clips/ hangers.
- Any machine/compressor plumbed to the system must have a JUMPER HOSE to reduce vibration.
- **DO NOT USE** MaxLine for **PULSING** desiccant dryers or other like equipment.
- **CAUTION** installing inert gas bulk tank systems, gas must be warmed up to MaxLine temperature range.
- **DO NOT** connect quick couplings for air hoses to reducing elbows or tee fittings. The constant connecting/ disconnecting and pulling or air hoses could loosen the fitting. Use the MaxLine **WALL OUTLET** which can be secured to a wall or post. Any hoses attached in the ceiling area to a fitting must use a strain relief attached to the building structure.
- Assemble all NPT **PIPE THREADS** with two wraps of Teflon tape and then pipe sealant which prevents thread galling.
- **CHECK** that all fittings are tightened before pressurizing the system for the first time.
- For initial installation, pressurize system **SLOWLY** to 50 psi and check for leaks, then pressurize slowly to MAX 190 psi.
- **AFTER 24 HOURS** of being pressurized, depressurize the system and **RETIGHTEN** the compression nuts. Some settling of components may have occurred. **This is not optional, it must be done.**
- Make sure compressor output temperature does not exceed **140° F**.
- Products manufactured by the seller carry a limited one year warranty. Contact SVI for more details.



Compressed Air Piping System

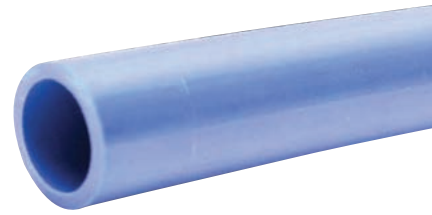

*Single Layer Nylon
Compressed Air Tubing for
Single Air User/Home Garage*

RapidAir Home Garage

Single Layer Tubing
Blue - Nylon Material

1/2" OD x 3/8" ID
Available in 100 ft rolls

TECHNICAL SPECS

Compressed Air: 150 psi max
Operating Working Pressure:
150 pxi @70° F

Temp Range: -40° to 180° F
Compatible with common
compressor oils

Fittings: Push-to-Connect Style
Nickel Plated Brass / Nylon

For outside installation, cover or
paint the tubing and fittings to
protect from direct sunlight (UV rays)

**Distance from the compressor
to the farthest outlet point**
up to 50 ft
For building sizes
under 1200 sq. ft.



IDEAL FOR: Home Garage or Workshop, Hobbyist
Woodworking Applications, Powering Personal Tools,
Easy In-Wall or On-Wall Installation, Single Air Users...

- Fast and Easy to Install
- Cost Effective
- Corrosion Resistant

RapidAir is a complete compressed air distribution system that is designed to easily install beneath walls of new construction, or on wall surfaces of existing workshops.

AIR ANYWHERE

No more dragging the compressor behind you and untangling the air hose and electrical cords. Reduce shop clutter and have constant compressed air instantly, anywhere. The RapidAir garage air line kit allows you to design and install your own pressurized air system, any way you want it. You won't find an easier to install system than RapidAir.

RapidAir Nylon Tubing is lightweight, corrosion / abrasion-resistant and extremely durable. Compressor oils have no effect on it's performance.

EASY-TO-INSTALL

The RapidAir system includes professional quality Rapid Fittings, air distribution manifolds, air outlets, and nylon tubing. Installation is fast, easy and customizable. The system is engineered to maintain 150 psi. Our systems include several types of mounts to suit your needs.

- SURFACE MOUNT:** Air Line is mounted to the wall.
HIDDEN MOUNT: Air Line is inside the wall.
EXTERIOR MOUNT: Air Outlet is mounted outdoors.
CEILING MOUNT: Air Outlet is mounted on the ceiling.

Install it yourself. You can easily disassemble and re-modify your system. There are no special tools required to make your workspace more efficient and professional looking.

ECONOMICAL

An alternative to black or copper pipe installations, the modular design makes it less expensive to install than the traditional methods. With the RapidAir system there is no interior pipe corrosion, which results in longer tool life.



Compressed Air Piping System

RAPIDAIR TUBING

RapidAir compressed air tubing is a single-layer blue nylon tubing.

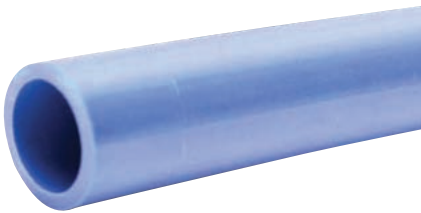

1/2"
SYSTEM



SVI #	Description
QP-5590-500 RapidAir 1/2 in. 1/2" Home Garage Master Kit • 100 ft.	
Kit Contains:	
(1)	QP-5520-100 100 ft. x 1/2" RapidAir Tubing and Cutter
(2)	QP-5590-120 Aluminum Block
(1)	QP-5590-220 Aluminum Manifold Block
(6)	QP-5550-100 3/8" NPT Straight Fitting
(4)	QP-5550-300 Union Elbow
(2)	QP-5550-120 3/8" NPT Drain Valve
(2)	QP-5550-125 1/4" NPT Brass Nipple
(2)	QP-5550-130 1/4" NPT Brass 45° Fitting
(3)	QP-5550-135 3/8" NPT Brass Plug

The best, most efficient DIY compressed air solution for the home garage or workshop. This kit includes all you need to set your space up for convenient compressed air piping.

Install it yourself.
No special tools are required to make your workspace more efficient and professional looking. You can easily disassemble and re-modify your system. Reduce clutter with this complete home garage compressed air piping system.



BLUE RAPIDAIR TUBING FOR COMPRESSED AIR

Includes Nylon Tubing and Cutter

SIZE	PART #	OUTSIDE	INSIDE	LENGTH
1/2"	QP-5520-100	.5 in.	.375 in.	100 ft



Compressed Air Piping System



COMPRESSED AIR OUTLET KIT

For Use with
RapidAir Tubing 1/2" OD x 3/8" ID

QP-5590-100

3/8" NPT Ports on Top, Bottom
and Back of Block /
Face of Block has 1/4" NPT Port
Adapts to surface, in-wall, or
ceiling mount.

Kit contains:

- | | |
|-----|--|
| (1) | QP-5590-120 Aluminum Outlet Block |
| (1) | QP-5550-100 3/8" NPT Straight |
| (1) | QP-5550-300 Union Elbow |
| (1) | QP-5550-120 Drain Valve |
| (1) | QP-5550-125 1/4" NPT Brass Nipple |
| (1) | QP-5550-130 1/4" NPT Brass 45 Degree Elbow |
| (1) | QP-5550-135 3/8" NPT Brass Plug |

- Quick Coupler Air Chuck not included, sold separately.
- Remember to always add a Tee Fitting QP-5550-200 (sold separately) if adding an outlet kit.
- Use Quick Coupler QP-2260-221 or QP-2270-221.



COMPRESSED MANIFOLD KIT

For Use with
RapidAir Tubing 1/2" OD x 3/8" ID

QP-5590-200

Adapts to surface, in-wall, or
ceiling mount.

Kit contains:

- | | |
|-----|-------------------------------------|
| (1) | QP-5590-220 Aluminum Manifold Block |
| (4) | QP-5550-100 3/8" NPT Straight |
| (2) | QP-5550-300 Union Elbow |
| (1) | QP-5550-135 3/8" NPT Brass Plug |

- Includes 3/8" NPT Fitting to Connect Compress Regulator



COMPRESSED AIR OUTLET BLOCK ONLY

For Use with
RapidAir Tubing 1/2" OD x 3/8" ID

QP-5590-120

3/8" NPT Ports on Top, Bottom
and Back of Block /
Face of Block has 1/4" NPT Port



COMPRESSOR MANIFOLD BLOCK ONLY

For Use with
RapidAir Tubing 1/2" OD x 3/8" ID

QP-5590-220

(4) 3/8" NPT Ports



Compressed Air Piping System

FITTINGS AND ACCESSORIES

FOR USE WITH RAPID AIR TUBING 1/2" OD X 3/8" ID

RAPIDAIR FITTINGS are designed to make installation fast and easy. Simply push the tubing firmly into the fitting until seated. If removal is desired, push in evenly on release button and pull tubing out of fitting.



PIPE CLIPS

For use with
RapidAir Tubing 1/2" x 3/8" ID

QTY	SVI PART #
12-Pack	QP-5520-200



STRAIGHT FITTING

For use with
RapidAir Tubing 1/2" x 3/8" ID

SIZE	SVI PART #
3/8" MNPT	QP-5550-100
1/2" MNPT	QP-5550-110



TEE

For use with
RapidAir Tubing 1/2" x 3/8" ID

SVI PART #
QP-5550-200



UNION ELBOW

For use with
RapidAir Tubing 1/2" x 3/8" ID

SVI PART #
QP-5550-300



90° ELBOW FITTING X 3/8" NPT

For use with
RapidAir Tubing 1/2" x 3/8" ID

SIZE	SVI PART #
3/8" MNPT	QP-5550-400



UNION FITTING

For use with
RapidAir Tubing 1/2" x 3/8" ID

SIZE	SVI PART #
1/2" NPT	QP-5550-500



DRAIN VALVE

3/8" NPT Male x 3/8" NPT Female

SIZE	SVI PART #
3/8" NPT	QP-5550-120

Replacement Handle: QP-5550-120H



Accessories

BRASS FITTINGS AND ACCESSORIES



BRASS 45° STREET ELBOW

SIZE	SVI PART #
1/4" NPT	QP-5550-130
1/2" NPT	QP-5550-131
3/4" NPT	QP-5550-132



BRASS ALLEN HEAD PLUG

SIZE	SVI PART #
1/4" NPT	QP-5550-134
3/8" NPT	QP-5550-135
1/2" NPT	QP-5550-136 (Countersunk)



BRASS HEX NIPPLE

SIZE FNPT	SVI PART #
1/4" NPT	QP-5550-610
3/8" NPT	QP-5550-615
1/2" NPT	QP-5550-616
3/4" NPT	QP-5550-617
1" NPT	QP-5550-621



BRASS 90° STREET ELBOW

SIZE	SVI PART #
1/4" NPT	QP-5550-612
3/8" NPT	QP-5550-613
1/2" NPT	QP-5550-614
3/4" NPT	QP-5550-622



BRASS HEX HEAD PLUG

SIZE	SVI PART #
3/4" NPT	QP-5550-137
1" NPT	QP-5550-138

REDUCING

3/8" x 1/2"	QP-5550-618
3/4" x 1"	QP-5550-619
1/2" x 3/4"	QP-5550-620
3/8" x 1/4"	QP-5550-609
1/2" x 1/4"	QP-5550-611



CLOSE NIPPLE

SIZE FNPT	SVI PART #
1/4" NPT	QP-5550-125



BRASS/BRONZE TEE

SIZE	SVI PART #
1/4" NPT	QP-5550-910 Brass
3/8" NPT	QP-5550-911 Brass
1/2" NPT	QP-5550-912 Brass
3/4" NPT	QP-5550-913 Bronze
1" NPT	QP-5550-914 Bronze



BRASS FNPT ELBOW

SIZE FNPT	SVI PART #
3/8" x 3/8"	QP-5550-604
1/2" x 1/2"	QP-5550-607
3/4" x 3/4"	QP-5550-606

REDUCING

1/2" x 3/4"	QP-5550-605
-------------	-------------



Accessories

BRASS FITTINGS AND ACCESSORIES

BRASS HEX ADAPTER BUSHING



MNPT	FNPT	SVI PART #
1/4" MNPT x	3/8" FNPT	QP-5550-810
1/4" MNPT x	1/2" FNPT	QP-5550-811
3/8" MNPT x	1/2" FNPT	QP-5550-812
1/2" MNPT x	3/4" FNPT	QP-5550-813



HEX REDUCING BUSHING

All parts are brass except the QP-5550-704 is galvanized.

MNPT	FNPT	SVI PART #
3/8" MNPT x	1/4" FNPT	QP-5550-717
1/2" MNPT x	1/4" FNPT	QP-5550-716
1/2" MNPT x	3/8" FNPT	QP-5550-715
3/4" MNPT x	1/4" FNPT	QP-5550-714
3/4" MNPT x	3/8" FNPT	QP-5550-713
3/4" MNPT x	1/2" FNPT	QP-5550-712
1" MNPT x	3/8" FNPT	QP-5550-711
1" MNPT x	1/2" FNPT	QP-5550-710
1" MNPT x	3/4" FNPT	QP-5550-709
1-1/2" MNPT x	3/4" FNPT	QP-5550-708
1-1/2" MNPT x	1" FNPT	QP-5550-707
2" MNPT x	3/4" FNPT	QP-5550-706
2" MNPT x	1" FNPT	QP-5550-705
2" MNPT x	1-1/2" FNPT	QP-5550-704 Galvanized

AIR HOSE



- Rapidair Accessories
- Both ends 1/4" Rigid Male NPT
 - Tektok Rubber Air Hose
 - 250 PSI
 - With Bend Restrictors
 - Made in the USA

SVI Part #	Description
QP-1540-325	3/8" x 25 FT Air Hose 1/4" NPT M Ends
QP-1540-350	3/8" x 50 FT Air Hose 1/4" NPT M Ends

NPT COUPLING BRASS OR GALVANIZED (FEMALE X FEMALE)

All parts are brass except those listed as galvanized.

FNPT	FNPT	SVI PART #
1/4" FNPT x	1/4" FNPT	QP-5550-860
3/8" FNPT x	3/8" FNPT	QP-5550-861
1/2" FNPT x	1/2" FNPT	QP-5550-862
3/4" FNPT x	3/4" FNPT	QP-5550-863
1" FNPT x	1" FNPT	QP-5550-864 Galvanized
3/8" FNPT x	1/4" FNPT	QP-5550-870
1/2" FNPT x	1/4" FNPT	QP-5550-871
1/2" FNPT x	3/8" FNPT	QP-5550-872
3/4" FNPT x	1/2" FNPT	QP-5550-873
1-1/2" FNPT x	3/4" FNPT	QP-5550-877 Galvanized
1-1/2" FNPT x	3/4" FNPT	QP-5550-878 Galvanized
1-1/2" FNPT x	1" FNPT	QP-5550-879 Galvanized
2" FNPT x	1-1/2" FNPT	QP-5550-880 Galvanized
2-1/2" FNPT x	2" FNPT	QP-5550-883 Galvanized
3" FNPT x	2" FNPT	QP-5550-885 Galvanized



3/8 COIL HOSE 1/4" MALE NPT SWIVEL ENDS – REINFORCED POLYURETHANE

Lightweight and durable polyurethane material.

NPT	Length	SVI PART #
1/4" NPT x	6 FT	QP-2272-006
1/4" NPT x	20 FT	QP-2272-020





Accessories

ALUMINUM MANIFOLDS

Rapidair Aluminum Pneumatic Compressed Air Distribution Manifold Blocks

- 6061 Aluminum Construction
- NPT Ports
- 200 psi rated

Call SVI today for Custom Manifolds—800-321-8173

SVI Part #	Description
QP-0500M-25-4	1/2" Manifold x (4) 1/4 Outlets
QP-0500M-25-5	1/2" Manifold x (5) 1/4 Outlets
QP-0500M-50-4	1/2" Manifold x (4) 1/2" Outlets
QP-0500M-50-5	1/2" Manifold x (5) 1/2" Outlets
QP-0500MB-50-2	1/2" Manifold x (2) 1/2" Outlets
QP-0750M-50-3	3/4" Manifold x (3) 1/2 Outlets
QP-0750M-50-4	3/4" Manifold x (4) 1/2 Outlets
QP-0750M-50-5	3/4" Manifold x (5) 1/2 Outlets
QP-0750M-75-3	3/4" Manifold x (3) 3/4" Outlets
QP-0750M-75-4	3/4" Manifold x (4) 3/4" Outlets
QP-0750M-75-5	3/4" Manifold x (5) 3/4" Outlets
QP-1000M-75-3	1" Manifold x (3) 3/4 Outlets
QP-1000M-75-4	1" Manifold x (4) 3/4 Outlets
QP-1000M-75-5	1" Manifold x (5) 3/4 Outlets



VIBRATION DAMPENING PADS

Use SVI's Vibration Dampening Pads to reduce vibration noise from your air compressor and other equipment.

1" Thick Rubber Pads with 5/8" Hole • Choose 3" or 4" Square

AS-2200-53 and -54 Pads are constructed from extremely durable and long lasting, multiple-ply reinforced rubber.

SVI Part #	Description
AS-2200-53	Vibration Dampening Pad 3" Square x 1" Thick
AS-2200-53-4	Vibration Dampening Pads 3" Square x 1" Thick (Set of 4)
AS-2200-54	Vibration Dampening Pad 4" Square x 1" Thick
AS-2200-54-4	Vibration Dampening Pads 4" Square x 1" Thick (Set of 4)

Choose
Your Size!
**3" OR 4"
SQUARE**

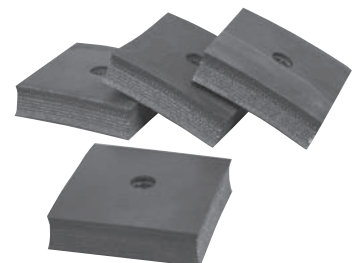

1/2" Thick Cork and Rubber Pads

Put between compressor and floor. 4" x 4" x 1/2" Thick • Set of 4

SVI Part #	Description
QP-2310-441-4X	Vibration Dampening Pads 4" Square x 1/2" Thick (Set of 4)

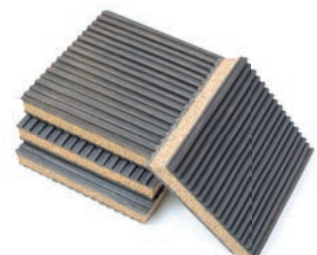



Accessories

PUSH-ON AIR HOSE AND FITTINGS

Rapidair Accessories, Rapidair Push-On Hose and Fittings

EASY TO USE

- Build your own custom length push-on pliable rubber air hose with a variety of fitting ends for machine hook-ups and to do drop lines, etc.
- No clamps needed—Simply place the end of the hose in boiling water to soften and push on the brass barb fitting
- Hose sold by the foot, maximum continuous roll length is 160 ft
- 200 psi rated



PUSH-ON RUBBER AIR HOSE

SVI Part #	Size	Length
QP-1540-238-160	3/8"	160' Roll
QP-1540-238-FT	3/8"	By the Foot
QP-1540-250-160	1/2"	60' Roll
QP-1540-250-FT	1/2"	By the Foot
QP-1540-230	3/8"	3' Jumper Hose



FEMALE SWIVEL NPT

SVI PART #	HOSE SIZE	THREAD SIZE
QP-1540-243	3/8"	1/4" NPT
QP-1540-244	3/8"	1/2" NPT
QP-1540-252	1/2"	1/2" NPT



MALE NPT

SVI PART #	HOSE SIZE	THREAD SIZE
QP-1540-240	3/8"	1/4" NPT
QP-1540-241	3/8"	3/8" NPT
QP-1540-242	3/8"	1/2" NPT
QP-1540-251	1/2"	1/2" NPT

AIR HOSE STRAIN RELIEF

Rapidair Strain Relief, Buss Strain Relief

When hanging air hose from the ceiling, the hose needs to be attached to the building structure with a strain relief.

Wire Mesh Material: Stainless

Lug Material: Galvanized Steel

QP-1540-239 • 3/8" AIR HOSE STRAIN RELIEF

FOR HOSE DIAM .50 – .70

- Mounting Hole is 3/8"
- Working Load: 80 lbs
- Mesh Length: 9 inches
- Overall Length: 11 inches

QP-1540-259 • 1/2" AIR HOSE STRAIN RELIEF

FOR HOSE DIAM .70 – 1.00

- Mounting Hole is 3/8"
- Working Load: 110 lbs
- Mesh Length: 12 inches
- Overall Length: 15 inches





Accessories

COUPLERS / PLUGS • INDUSTRIAL STYLE

SAFETY / QUICK COUPLER

No more hose whip from accidental disconnects, as the compressed air is released before the plug can be removed. This coupler is a good addition to your safety program as OSHA requires employers to provide a safe working environment.

EASY TO USE:

Push button once to release the compressed air, press the button again to release the plug.

SPECS:

Tough composite body with zinc plated steel threads

- 190 psi working pressure
- Designed for minimal pressure drop
- Industrial Style Profile 1/4" and 3/8" Body Size



MALE

FEMALE

SIZE	CFM	SVI PART #
30 CFM INDUSTRIAL TYPE M		
1/4" NPT Male	30	QP-2270-221
1/2" NPT Male	30	QP-2270-241
1/4" NPT Female	30	QP-2270-220

70 CFM INDUSTRIAL TYPE H		
3/8" NPT Male	70	QP-2290-231
1/2" NPT Male	70	QP-2290-241
3/8" NPT Female	70	QP-2290-230
1/2" NPT Female	70	QP-2290-240

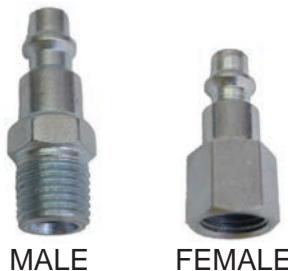

MALE

FEMALE

QUICK COUPLER PLUGS M-STYLE

SIZE	CFM	SVI PART #
30 CFM INDUSTRIAL TYPE M		
1/4" NPT Male	30	AS-0727
1/4" NPT Female	30	AS-0728

70 CFM INDUSTRIAL TYPE H		
1/4" NPT Male	70	QP-2280-221
3/8" NPT Male	70	QP-2280-231
1/2" NPT Male	70	QP-2280-241
1/4" NPT Female	70	QP-2280-220
3/8" NPT Female	70	QP-2280-230
1/2" NPT Female	70	QP-2280-240

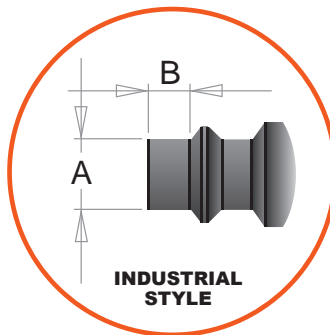

DIMENSION	A	B	TYPE
30 CFM			
1/4 BODY	5/16"	3/16"	M
70 CFM			
3/8 BODY	7/16"	5/16"	H



QUICK COUPLER PLUG PACK

- Industrial Style, Type M 30 CFM
- Includes (3) 1/4" Male Thread & (3) 1/4" Female Thread
- When ordering couplers, must use 30 CFM coupler
- Heat Treated Steel, Zinc Plated

SVI Part #	Description
QP-2250-226	1/4" NPT Quick Coupler Plug Pack (3 each Female & Male)



Accessories

COUPLERS / PLUGS • INDUSTRIAL STYLE *(continued)*

PUSH TO CONNECT M-STYLE COUPLER 30 CFM BODY

Brass / Industrial Style
Type M

When ordering mating
plugs, must use 30 CFM plug.

Push to connect style coupler allows the male
plug to be seated without “pulling back” the
sleeve. Simply push the male plug into the
coupler body until it clicks. Release by holding
male plug securely and pulling sleeve forward.

QP-2260-221 • 1/4" FNPT

QP-2260-221 • 1/4" MNPT

QP-2260-241 • 1/2" MNPT



RapidAir Blow Gun

These blow guns are comprised of a casted
aluminum body that is light and durable. Blow
Gun (QP-2271-025) is equipped with only the
safety nozzle, while Blow Gun (QP-2271-225) is
adjustable and provides a nozzle set as pictured.
These products meet OSHA Standards.



QP-2271-025



QP-2271-225

SPECS:

- Material: Aluminum
- Air Intake Thread: 1/4" M
- Maximum Pressure: 363PSI (25 Bar/2.5 mPa)
- Operation Temperature: 23~140°F (-5~60°C)

INLET	NOZZLE TYPE	SVI PART #
1/4" NPT	Adjustable	QP-2271-225
1/4" NPT	Safety	QP-2271-025

BALL VALVES

Brass NPT Ball Valve
Full Port



Female NPT x
Female NPT



Male NPT x
Female NPT

SVI Part #	Description	
FK-32-0500	1/2" FNPT Ball Valve Brass 600WOG	Female x Female
FK-32-0750	3/4" FNPT Ball Valve Brass 600WOG	Female x Female
FK-32-1000	1" FNPT Ball Valve Brass 600WOG	Female x Female
FK-32-1500	1-1/2" FNPT Ball Valve Brass 600WOG	Female x Female
QP-2235-200	2" FNPT Ball Valve Brass 600WOG	Female x Female
QP-2235-300	3" FNPT Ball Valve Brass 400WOG	Female x Female
QP-2235-050M	1/2" FNPT Ball Valve Brass	Male x Female
QP-2235-075M	3/4" FNPT Ball Valve Brass	Male x Female
QP-2235-100M	1" FNPT Ball Valve Brass	Male x Female



Accessories

CHEMAIRE ADAPTER

Convert an old, obsolete Chemaire ABS compressed air piping system to female pipe thread to attach to any threaded system.

Use cleaner QP-2300-108 and glue QP-2300-109

We can custom build any components needed. See 4 inch valve replacement pictured ► SVI makes no claims of the integrity of your current Chemaire system—install with caution.



SVI Part #	Description
QP-2300-101	1/2" ChemAir x 1/2" FNPT .840 OD
QP-2300-102	3/4" ChemAir x 3/4" FNPT 1.050 OD
QP-2300-103	1" ChemAir x 1" FNPT 1.315 OD
QP-2300-104	1-1/2" ChemAir x 1-1/2" FNPT 1.900 OD
QP-2300-105	2" ChemAir x 2" FNPT 2.375" OD
QP-2300-108	ChemAir Cleaner - 16 oz.
QP-2300-109	ChemAir Cement - 16 oz. 24 Hour Cure

PIPE MARKER LABELS

Rapidair Pipe marker label tells maintenance personnel what is inside the pipe, direction of flow and hazardous condition. Sticker Dimensions: 7-1/2" Wide x 1" Tall



SVI Part #	Description
QP-2310-0100	Compressed Air Pipe Blue Label
QP-2310-0101	Nitrogen Pipe Green Label
QP-2310-0102	Inert GAS Pipe Green Label
QP-2310-0103	Argon Pipe Green Label
QP-2310-0104	Carbon Dioxide Green Label



Accessories

AIR TOOL HOLDER

This Air Tool Holder is designed to hold both "Style T" and "Style I-M" 1/4" air couplers. A loading and unloading port is provided so the T or IM couplers can be placed on the pins and then rotated into the locking channel. It may be rotated to the next pin or stopped between pins to lock all tools in place.

- This easily moveable storage device will store and carry up to 6 tools and is compatible with the most common air fittings
- Simple loading and retrieval of tools when you need them – saving you time and energy
- Magnetic base holds firm and attaches to any metal surface, and also includes a metal backer plate to attach to any wall.
- Rust proof and corrosion resistant
- Rugged design for long lasting use
- Size 4 inch x 4 inch x 4 inch / 1 lb



MAGNETIC BASE

SVI Part #	Description
QP-2310-0150	Air Tool Holder

AUTOMATIC SHUTOFF TIRE INFLATOR GAUGE

The Rapidair Automatic Tire Inflator with Shutoff feature is a professional quality handheld unit.

Preset the desired pressure and hit start. Unit fills the tire automatically and stops at preset pressure.

If the tire is overfilled, or has too much pressure, the unit will relieve the air to the desired set pressure.

- Saves time and allows tires to be filled accurately
- (7) AA Batteries included and 6 ft filling cord
- Air Compressor required
- Inflation Range to 175 psi pressure

SVI Part #	Description
QP-2230-015	Auto Fill Tire Inflator with Shutoff

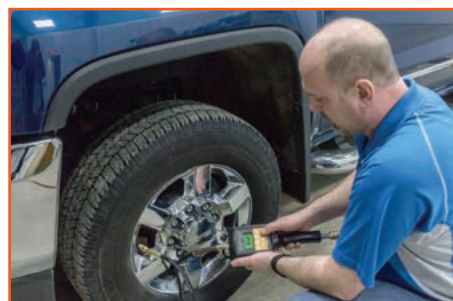



Accessories

COMBINATION FILTER REGULATORS



HORIZONTAL PORTS

TECH SPECS:

- Compressed Air Applications
- 175 psi Maximum Inlet Pressure
- 0–150 psi Adjustable Pressure Range
- Temperature Range 32°F to 140°F
- 5 Micron Filtration
- Includes Mounting Brackets

GENERAL RATINGS:

- Manual Bowl Drain
- Square Embedded Gauge
- Flow Direction, Reversible for Horizontal Port Units
- Flow Direction, Top to Bottom for Vertical Port Units
- Zinc Die Cast Body
- Compatible with Common Compressor Lubricants



VERTICAL PORTS

SVI Part #	Ports	Flow	Description
HORIZONTAL PORTS:			
QP-2293-215	3/8" NPT	100 CFM	Filter Regulator Unit with Gauge
QP-2293-216	1/2" NPT	150 CFM	Filter Regulator Unit with Gauge
QP-2293-217	3/4" NPT	300 CFM	Filter Regulator Unit with Gauge
QP-2293-218	1" NPT	350 CFM	Filter Regulator Unit with Gauge
VERTICAL PORTS:			
QP-2296-050	1/2" NPT	150 CFM	Vertical Filter Regulator with Gauge
QP-2296-075	3/4" NPT	300 CFM	Vertical Filter Regulator with Gauge

IN-LINE REGULATORS



- Mounting Bracket
- Operating Pressure 175 PSI – MAX
- Set Pressure 0–150 PSI
- Can be installed Vertically or Horizontally, Flow can be switched if needed

SVI Part #	Ports	Description
QP-2293-210	1/4" NPT	In-Line Regulator with Gauge SMC
QP-2293-211	3/8" NPT	In-Line Regulator with Gauge
QP-2293-212	1/2" NPT	In-Line Regulator with Gauge

FILTER UNIT ONLY



- Inline filter units only, no regulator built in
- Comes with mounting bracket
- Max PSI 175
- 5 micron filter

SVI Part #	Ports	Description
QP-2290-215	3/8" NPT	Air Filter Unit with Bracket
QP-2290-216	1/2" NPT	Air Filter Unit with Bracket
QP-2290-217	3/4" NPT	Air Filter Unit with Bracket



Accessories

FRL • FILTERS - REGULATORS - LUBRICATORS

Mounting Bracket
Manual Water Drain
Operating Pressure 175 PSI – MAX
Set Pressure 0–150 psi
5 Micron Filter

SVI Part #	Size	Description
QP-2292-215	3/8" NPT	Filter Regulator Lubricator Unit
QP-2292-216	1/2" NPT	Filter Regulator Lubricator Unit
QP-2292-217	3/4" NPT	Filter Regulator Lubricator Unit



LUBRICATORS

Use standard air tool lightweight oil

We do not recommend using a lubricator at the start of the air system. Oil will accumulate in the lines, making them useless for painting or even blowing off dust (surfaces will be blown with oil from the lines).

Best to use QP-2293-215–QP-2293-218 Series Filter Regulator at the start of the system.



SVI Part #	Ports	Description
QP-2291-215	3/8" NPT	Lubricator Unit with Mounting Bracket
QP-2291-216	1/2" NPT	Lubricator Unit with Mounting Bracket
QP-2291-217	3/4" NPT	Lubricator Unit with Mounting Bracket

FILTER / REGULATOR REPLACEMENT GAUGE



REPLACEMENT GAUGE FOR:

QP-2293-215 • QP-2293-216 • QP-2293-217 • QP-2293-218 • QP-2296-075

SVI Part #	Description
QP-2210-215-218G	Square Pressure Gauge

REGULATOR TO LUBRICATOR MOUNT BRACKETS

SVI Part #	Description
QP-2230-000T	Regulator To Lubricator Mount Bracket 3000
QP-2240-040T	Regulator To Lubricator Mnt Brckt 4000
QP-2250-050T	Regulator To Lubricator Mnt Brckt 4000-06



Accessories

REGULATOR BOWL

- Bottom drain is not replaceable, it is pressed into the bowl
- Connection on the bottom drain is 5/16" (8mm) Tubing

SVI Part #	Description
QP-2210-215B	Regulator Bowl for 3/8" QP-2293-215
QP-2210-216-218B	Bowl for 1/2" QP-2293-216, 3/4" QP-2293-217, 1" QP-2293-218, 3/4" QP-2296-075 Vertical



ADJUSTMENT CAP

SVI Part #	Description
QP-2210-215C	Adjustment Cap for Filter Regulator 3/8" QP-2293-215
QP-2210-216-218C	Adjustment Cap for Filter Regulators 1/2" QP-2293-216, 3/4" QP-2293-217, 1" QP-2293-218, 3/4" QP-2296-075 Vertical



REPLACEMENT FILTER FOR RAPIDAIR FILTER REGULATORS

5 micron



SVI Part #	Description
QP-2210-215F	Filter Only for 3/8" QP-2293-215 Filter Regulator
QP-2210-216-217F	Filter Only for 1/2" QP-2293-216, 3/4" QP-2293-217, 3/4" QP-2296-075 Vertical
QP-2210-218F	Filter Only for 1" QP-2293-218

REPLACEMENT PLUNGER DIAPHRAGM

Inner Plunger Diaphragm for RapidAir Filter/Regulator



SVI Part #	Description
QP-2210-215P	Plunger Diaphragm 3/8" QP-2293-215 Filter Regulator
QP-2210-216-218P	Plunger Diaphragm for 1/2" QP-2293-216, 3/4" QP-2293-217, 1" QP-2293-218, 3/4" QP-2296-075 Vertical

PRESSURE GAUGES

0-200 PSI • 1/4" Male NPT

4-1/2" Diameter Face • Dry with Plastic Lens

Choose Rear Mount or Bottom Mount

SVI Part #	Description
QP-2314-525-L	Pressure Gauge Bottom Mount 0-200 PSI 1/4" M
QP-2314-525-R	Pressure Gauge Rear Mount 0-200 PSI 1/4" M



BOTTOM MOUNT
QP-2314-525-L



REAR MOUNT
QP-2314-525-R

DIRECTFIT™ *Service, Value, and Innovations* Top-line products and solutions.

Accessories

POWER STATION™ AIR / ELECTRIC UTILITY BOX

Ideal for Automotive Lifts, CNC Machining Centers, Machine Tools, Assembly Stations, and More!



FEATURES:

- Your choice of four attractive powder coat finishes. Choose your own personalized combination. If your lift is blue, choose blue or consider yellow or red for that stand-out look. Black is another popular option to fit any color scheme.
- Easy-to-install. Adapts to most surface-mount lifts or any nearby wall.
- 20 amp (20-5R) outlets with GFCI protection are standard.
- Electrical outlets are positioned above the filter to prevent moisture problems (common with others).
- Air system provides both filtered non-lubricated and lubricated air—one for tire inflation and blow guns, the other for your pneumatic tools.

Simply install the PowerStation™ on your surface-mount lift or nearby wall, bring in your air and electric service, and watch the results. You'll see improved performance and a more organized shop. No longer worry about trip hazards associated with cords and hoses stretched for great distances across your floor.

What better step-saving tool is there? Reward service technicians with a product that will make their jobs easier and more efficient. Increase shop productivity today.



4 Color Choices Available!
Coordinate with your shop.

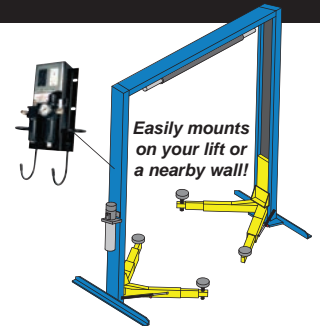

BENEFITS:

- Air lines and electrical cords are within easy reach.
- Your surface mount lifts become more service tech friendly.
- Enhances your overall shop appearance and performance.

ASK FOR A POWERSTATION! • BH-7070-K / BH-7069-K SERIES

DIRECTFIT™

Automatic Tank Drain Valve for Champion®* and other brand Air Compressors

AS-2201-04 (Ref ZTD1) Automatic Tank Drain Valve

AS-2201-03 (Ref # Z5941) Repair Kit for Automatic Tank Drain Valves

For repair of SVI's AS-2201-03 or Champion's® ZTD1*



Made in America!

Only Air Compressors equipped with centrifugal unloaders or unloader-type pressure switches can use this drain valve.

*All names, numbers, symbols and descriptions are used for reference purposes only. It is not implied that any part listed is the product of these manufacturers. SVI does not represent and is not associated in any way with any other companies. Champion® is a registered trademark of Gardner Denver.



Accessories

COMPRESSOR SHUT OFF VALVE 110V

- 110 Volt
- Actuated Valve to Remote Shut Off Your Air System
- 3/4" Female NPT Ports

SVI Part #	Description
QP-2310-0190	Compressor Shut Off Valve 110V



AUTO TANK DRAIN 115V

- 115 Volts
- 1 to 45 minute cycle time
- 1 to 10 second open blow off time
- 1/2" NPT Male Inlet
- 1/4" NPT Female Outlet



Electrical Timer Eliminates Manually Draining Air Tank

SVI Part #	Description
QP-2310-0177	Auto Tank Drain 115V



AUTOMATIC TANK DRAIN VALVE / TIMER DRAIN VALVES

Kingston Condensate Drain Products are designed to provide efficient drainage of condensate from compressor tanks. The product line offers a mechanical valve to be used on compressors with an unloader port and an electric timer drain valve that can be used on all compressors.



Automatic Drain Valve
3/8" NPT Inlet • 1/4" NPT Outlet
SVI Part #: FK-620-375

- Designed for use on all compressors with an unloader port
- Complete drainage is assured by double action of the valve (which opens when the compressor starts and stops)
- Long, trouble-free service is provided
- Through simplicity of design and the use of rust-resisting materials
- Pressure Range 30–400 psi
- -40° F to 225° F

FK-KTD • Kingston Timer Drain Valves

- Designed for use on all compressors
- Pressure range up to 300 PSI IP65 when installed
- Interval time is 0.5-45 Minutes, Adjustable
- Discharge time is 0.5-10 Seconds, Adjustable
- Temperature range is -40° to 140° F



Electronic Timer Drain
1/4" FxF NPT, 110 VAC, 60 Hz
SVI Part #: FK-KTD-B-02

Electronic Timer Drain
1/2" FxF NPT, 110 VAC, 60 Hz
SVI Part #: FK-KTD-B-04



Electronic Timer Drain with Ball Valve and Strainer
1/2" Male & 1/4" Female NPT inlet x 1/2" Female NPT outlet, 110 VAC, 60 Hz
SVI Part #: FK-KTD-S-B-24



Accessories

PIPE SEALANT AND TAPE

Assemble all NPT threads with two wraps of Teflon Tape and then Pipe Sealant which prevents thread galling.

- Seals and lubricates metal or plastic threaded joints
- Will not harden or separate
- Withstands up to 3,000 psi on gases from -50° to +400°F and 6,000 psi on liquids from -50° to +400°F
- For use with plastic or metal threaded pipe carrying water, steam, caustics or dilute acid
- Formulated for lines carrying gas
- Includes brushtop applicator lid



SVI Part #	Description
QP-2750-700	Harvey Seal 4 Oz. and Teflon Tape (1 each)
QP-5550-702	Harvey Seal 4 Oz.
D3620	Teflon Tape 1/2" Wide x 520" Long

MEGA BUBBLE LEAK DETECTOR

Hercules® Megabubble® Leak Detector uses a high-viscosity formula that produces large, high-strength blue bubbles for easier detection of gas leaks on pipes, fittings, tanks, coils, cylinders, pressure vessels and valves

Small compressed air leaks are hard to find with conventional soap—use Megabubble! Call SVI today.

SVI Part #	Description
QP-5550-750	Megabubble Leak Detector 8 OZ





**TERMS AND CONDITIONS OF THE
SALES ORDER
FOR SVI INTERNATIONAL, INC.**

1. **GENERAL.** The terms and conditions of sales order outlined herein shall apply to the sale by SVI INTERNATIONAL, INC. (hereinafter referred to as "Company") of the items described on the facing page (hereinafter referred to as "Merchandise") to Purchaser.
2. **DELIVERY.** Delivery shall be deemed to be complete when the Merchandise has been shipped F.O.B. Company's plants in DeKalb, Illinois, and Montclair, California; ("Company's plants"). Shipments are subject to delays from causes or contingencies beyond the reasonable control of the Company. When otherwise not specified, shipments will be made in standard containers via carrier which, in the judgment of the Company, will result in the most practical method. Title and right of possession will pass to the Purchaser upon receipt by the carrier at the shipping point. If a customer of the Company should specify a specific carrier's method of shipment (i.e., UPS Next Day Air) and that carrier does not perform to the customer's expectations, freight credit to a customer's account will not be issued unless the Company can first obtain a credit.
3. **RISK OF LOSS.** Identification of the Merchandise under Uniform Commercial Code (hereinafter referred to as "UCC") Section 2-501 shall take place at the moment of shipment F.O.B. Company's plants. Risk of loss shall pass to the Purchaser when the Merchandise is shipped from the Company's plants.
4. **TITLE.** Title to the merchandise shall transfer to the Purchaser when the Merchandise is shipped from the Company's plants.
5. **WARRANTIES.** The Company guarantees its products to be free from defects in workmanship and raw materials for a period of one year from date of purchase. THIS WARRANTY IS EXPRESSLY IN LIEU OF ANY AND ALL WARRANTIES EXPRESS OR IMPLIED. COMPANY DOES NOT WARRANT THE MERCHANDISE IS MERCHANTABLE OR FIT FOR ANY PARTICULAR PURPOSE. Company's liability for breach of the terms of this Agreement, including any warranty, is limited to either refund of the invoice price of the Merchandise or at Company's option, replacement of the Merchandise free of charge, including transportation charges but not including the cost of labor. Purchaser has not relied on any statement or upon the conduct of Company with respect to the prospective use of the merchandise. Company shall not be liable for, and Purchaser waives any and all claims for any loss or damage, directly or indirectly, arising from the use of the Merchandise and for punitive, incidental or consequential damages, including, but not limited to, damages to property, for loss of use, loss of time, loss of profit or loss of income. The Company does not authorize the sale of our products under any other warranty, expressed or implied. **Please note:** Electrical components and cylinder or shaft seals are not covered under warranty.
6. **SETOFF.** All claims for money due or to become due from the Company shall be subject to deduction by the Company for any setoff or counterclaim arising out of this or any other claims of the Company or its affiliated companies, whether such setoff or counterclaim arose before or after any assignment by Purchaser.
7. **INDEMNIFICATION.** Purchaser agrees to indemnify the Company and hold it harmless from and against all claims, liability, loss, damage, or expense, including reasonable counsel fees, arising from or by reason of any modifications or alterations made by Purchaser. If a customer of the Company modifies or alters any part, in any manner whatsoever, or uses any part in departure from recommended performance specifications, said customer agrees to indemnify and hold the Company harmless from and against all liability and expenses based on damage to property or injury to or death of any person arising out of or attributable to such modified or altered part. Further, the Company will not accept any such modified or altered part for credit to a customer's account.
8. **FREIGHT POLICY.** Freight charges are prepaid and added to invoice or collect FOB shipping point. Note: All customers are responsible for all carrier shipping costs, fees, surcharges, etc. including order refusal and return fees.
9. **RETURN POLICY.** To return a part for credit or inspection, Purchaser must first contact our Main Office in Illinois, to obtain a Return Merchandise Form. Once Purchaser has obtained this form, the parts can be returned freight prepaid only. The Return form must be included with the shipment. Parts returned to the Company without the approved form will be returned freight collect to the shipper or refused. Returns must be initiated within 30 days of the invoice date. The Return Forms are valid for 30 days, from the date of issue. All Returns are subject to restocking charges. Return parts brought into our remote warehouses, will not be accepted by our personnel, without a Return Merchandise Form from the Main Office. Parts which have been used in any way or manner, including any installation or incorporation into a lift, hoist, or other equipment, shall NOT be eligible for return whether or not a Return form has been assigned. **Please note:** Electrical parts or components are not returnable for credit. This includes all switches, pushbuttons, relays, electric motors, capacitors, fuses, solenoids, power units with wiring issues or any other electrical items. Custom, built to order, special order, and non-stocked genuine parts are non-returnable.
10. **RESTOCK CHARGE.** Returns are subject to a restocking charge. Refusals are subject to the same restocking charge plus the cost of outbound and return freight charges and/or fees incurred by the Company due to shipment refusal.
11. **PRICES AND PAYMENTS.** All prices are subject to change without notice. All prices are F.O.B. shipping point. The Company standard terms are net 30 days, C.O.D. company check, C.O.D. cash, VISA, MasterCard, Discover or American Express. However, if in the judgment of the Company, the financial condition of the Purchaser at any time does not justify shipment according to standard terms of payment, the Company may require full or partial payment in advance.
12. **INTERPRETATION.** This sales order is intended by the parties as a complete and exclusive statement of the terms of their agreement. It supersedes all prior agreements, written or oral. No course of prior dealings between the parties and no usage of the trade shall be relevant to supplement or explain any terms used in this sales order. Acceptance or acquiescence in a course of performance rendered under this purchase order shall not be relevant to determine the meaning of this sales order even though the accepting or acquiescing party has knowledge of the nature of the performance and opportunity for objection. Whenever a term defined by the UCC is used in this sales order the definition contained in the UCC shall control.
13. **MODIFICATION.** This sales order can be modified or rescinded only by a writing signed by both parties.
14. **WAIVER.** No claim or right arising out of a breach of this sales order can be discharged in whole or in part by a waiver or renunciation of the claim or right unless such waiver or renunciation is supported by consideration and is in writing signed by the aggrieved party.
15. **ASSIGNMENT.** No right or interest in this sales order shall be assigned by either party without the written consent of the other and no delegation of any obligation owed, or of the performance of any obligation by either the Company or Purchaser shall be made without the written consent of the other party. Any attempted assignment or delegation not made in conformity with this paragraph shall be wholly void and totally ineffective for all purposes.
16. **TIME TO PERFORM AND BRING ACTION.** Time is of the essence of this sales order. Any action for breach of this sales order shall be commenced within two (2) years after the cause of action has accrued. Any party who loses any litigation shall reimburse the other party for costs including reasonable attorney's fees. The exclusive jurisdiction for any legal action shall be the Circuit Court of DeKalb County, Illinois.
17. **APPLICABLE LAW.** This sales order shall be governed by the UCC of Illinois as effective and in force on the date of this sales order.



DIRECT FIT™ BRAND

SVI International, Inc.

Catalogs and Information Online: www.sviinternational.com

AUTO LIFT REPAIR PARTS FOR ALL MAKES & MODELS

~NO MATTER THE AGE OF THE LIFT!

- Arm Restraint Kits & Parts
- Cables—Lifting and Equalizing
- Chain
- doorjammerPRO - Door Protection Pad
- Height Extensions and Rubber Pads
- Installation Products & Tools
- Power Units and Parts
- Pulleys and Chain Rollers
- Seal Kits for In-Ground & Surface Mount
- Safety Legs / Non-Rotators
- Replacement Lift Kits
- Power Post Lifting Systems
- Tanks for In-Ground Lifts
- Turf Attachments for 2-Post Lifts

SURFACE MOUNT LIFT PARTS FOR:

Acanus	Gemini	Quality
Ammco**	Gilbarco	Ranger
Alamo /		Globe
ASSSA	Grand	Rotary Lifts
ALM	Hofmann	Silent Tech
AMI	Hydralift	Slift
Ashawia	Ime Istobal	Somers Souriau
Ben Pearson	Kismet	Stenhøj
BendPak	Kimm	Stertil Koni
Benwil	Koni	Sun
Bishamon	Launch	Tecalemit
Boston	Laycock	Titan
Bradbury	Lincoln	Weaver
Cascos	Maha	Werther
Consul	Manitowoc Lifts	Western
Challenger	Mohawk	Westinghouse
Force	Nussbaum	Wheeltronic
Ford Smith	OMA	Worth
Forward	OMCN	Zippo
Fuchs / Zippo	PMW	

IN-GROUND LIFT PARTS FOR:

Benwil	Gilbarco	PKS Lifts
Challenger	Globe	Rotary
Cochin	HDL/ISS Innovative	US Hoist
Curtis	Joyce	Weaver
Ford Smith	Manitowoc Lifts	Western

AIR COMPRESSOR PARTS

- Air Receiver Tanks • Compressor Mufflers
- Automatic Tank Drain Valve for Champion Compressors
- Filters—Many OEM Ref Available!
- Filters, Regulators, Lubricators
- Intake Filter Products
- Milton Air System Products
- Re-Coil Hose • Valves
- Vibration Dampening Pads & much more!

BRAKE LATHES REPAIR PARTS

- Brake Lathe Repair Parts and Accessories for **All Makes** 

EXHAUST REMOVAL SYSTEMS & PRODUCTS

FLUID DELIVERY SYSTEMS

- Lenz Fittings
- Steel Hydraulic Line Tubing and Fittings
- Strut and Hangers

HOSE REELS

HYDRAULIC CYLINDERS

- Custom Single-Acting Large Bore Cylinders
- Also see "Lifting Equipment"

LIFTING EQUIPMENT

- New In-Ground Lifts—Car, Truck & Bus
- Small Equipment Shop Maintenance (SESM) Lifts for lifting Landscape Equip. ATVs / UTVs, Motorcycles, Lawn Mowers, Golf Carts and More!
- Custom Lifting Equipment incl. Production Line Lifts, Rail Car Lifts and More
- Custom Hydraulic Cylinders for Various Applications
- Turf Attachments for 2-Post Lifts
- In-Ground Lift Sections and Kits
- And more!

EASY TO ORDER:

800-321-8173
815-748-0200

Fax: 800-899-1784 • 815-748-0210

E-Mail: parts@sviintl.com
www.sviinternational.com

LUBRICATION & PAINT / FOAM SPRAY REPAIR PARTS & KITS FOR:

- Alemite • ARO • Balcrank • Graco • Lincoln

PETROLEUM EQUIPMENT & REPAIR PARTS FOR:

- Gas Pump & Meter Kits and Parts for Gasboy • Tokheim • Fill-Rite
- Including Parts for Older Pumps: Wayne • Bennett • Gilbarco • Bowser A.O. Smith (Geosource) • Southwest

HYDRAULIC SEALS AND KITS

SHOP EQUIPMENT

- Hein-Werner Products • Omega Products
- Porto-Power • Pro-Lift

TIRE EQUIPMENT REPAIR PARTS

- Tire Changer and Wheel Balancer Parts for **All Makes**

Accu-Turn	Coats**	John Bean /	Sicam
All Tool	Corgi	(JBC)	Sice
Ammco**	FMC	Kwik-Way	Snap-On
BaseLine**	Giuliano	Launch	Teco
Bosch	Hofmann	Nussbaum	Tuxedo
Cemb	Hunter	Ranger	

VALVES

- Air Compressor Valves of All Types
- Air and Hoist Control Valves • Ball Valves
- Check Valves • Kingston Valves
- Pressure Relief Valves • Relief Valves
- Safety Valves • Solenoid Valves
- Tire Changer Valves • And More!

CUSTOM PRODUCTS

And let us know if you want something you use in your shop to be added to our product line!

DIRECT FIT™

In addition to SVI's DIRECT FIT™ BRAND, we are proud to be a one-stop shop for many other great products including:



B-Line
by **F.T.N**



2 Ready-Ship Warehouses for Faster Shipping! | CHICAGO • LOS ANGELES

Main Office: 155 Harvestore Drive • DeKalb, IL 60115

All names, numbers, symbols and descriptions are used for reference purposes only. It is not implied that any part listed is the product of these manufacturers. 01.10.2024

SVI does not represent and is not associated in any way with any other companies. Entire contents copyright © January 10, 2024 3:27 PM, SVI International, Inc. Prices subject to change without notice.

*AMMCO, BASELINE, COATS and DUCKHEAD are registered trademarks of Hennessy Industries, Inc. SVI International, Inc. is not associated in any way with Hennessy Industries, Inc.

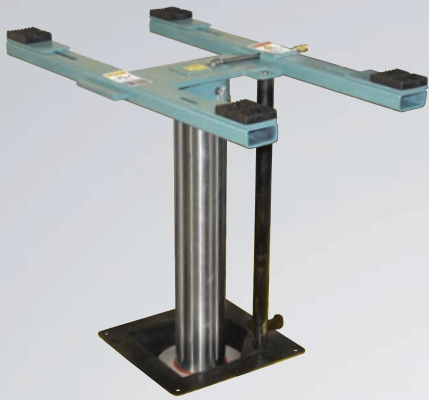

**SPECIALTY
LIFTS**



**LUBRICATION
EQUIPMENT
REPAIR PARTS**



**STEEL HYDRAULIC
LINE TUBING AND
FITTINGS**

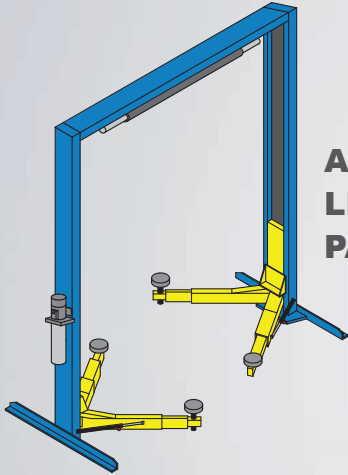

**AUTOMOTIVE
LIFT REPAIR
PARTS**



CALL TODAY
800-321-8173



**EV CHARGING
STATION
CLAMPS**

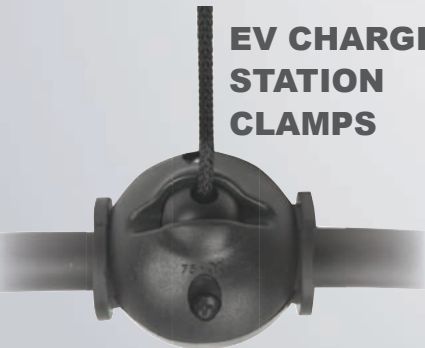

**AIR SYSTEM
PRODUCTS**



**TIRE CHANGER
REPAIR PARTS**



**CUSTOM EXTENSIONS FOR
4-POST'S ROLLING JACKS**



...and so much more!

SVI INTERNATIONAL, INC.
CHICAGO • LOS ANGELES

www.sviinternational.com



SVI IS YOUR ANSWER

DIRECTFIT™
SVI's DIRECT FIT™ BRAND

- Air System and Compressor Parts
- Auto Lift Parts for Any Brand
- Auto Lift Cables and Chain
- Auto Lift Power Units and Parts
- Auto Lift Sheaves / Pulleys and Chain Rollers
- Brake Lathe Repair Parts for All Makes
- Exhaust System Products
- Fluid Delivery Repair Parts
- Hose Reels and Hose Stops
- In-Ground Auto Lifts
- Lubrication Equipment Repair Parts
- Petroleum / Service Station Pump and Tank Products
- Repair Parts for Gasboy Consumer Series
- SESM Lifts for ATV/UTV, Golf Cart and More!
- Tire Changer Repair Parts
- Turf Attachments for 2-Post Lifts
- Vehicle Lifting Systems
- Wheel Balancer Accessories



SVI International, Inc.

155 Harvestore Drive • DeKalb, IL 60115

Contact Us!

800-321-8173

815-748-0200

FAX: 800-899-1784 • 815-748-0210

E-MAIL: parts@sviintl.com

Entire contents copyright © 2024,
SVI International, Inc.
QP1000 - 2.7.24

Information and Catalogs Online:
www.sviinternational.com