



October 2017

*Always the same or better than the OEM.*

# SVI New Product Notice...

## Swivel Joint Repair Kits for OPW



Distributor input remains one of the most beneficial ingredients to industry-wide cost and solution options. Demand for SVI to put its engineering to work making more petroleum and industrial-use repair products has never been greater. Distributors across many industry sectors are asking that more and more new products are added to the ever-growing vast SVI product line.

SVI is now pleased have incorporated its ingrained philosophy of "Resource Engineering" to provide everyone with a lower cost, but equally quality impressive line of repair kits for OPW swivel joints. Swivel joints are widely found in use across virtually all types of industries and many different applications. They can be found used in conjunction with hose reels, bulk loading arm applications and often in piping systems that require a great deal of flexibility. You don't have look very hard to find swivel joints in the numerous other industries SVI serves such as petroleum, agricultural, pharmaceutical, batch mixing manufacturing operations, paint, food and beverage producers, oil refineries, bulk tanker ships and railcars and so on. Look toward any fluid or dry bulk products used today that are transferred safely from one container to another and you will find swivel joints.

Broadening our capabilities as one of industry's most trusted supplier has lead SVI on an unparalleled expansion. Petroleum equipment repair solutions is now one of the most sought after segments within SVI's capabilities. Resource Engineering? SVI operates with a staff of fully degreed mechanical engineers, and resource engineering is a practice employed to provide customers with alternative solutions for parts and products that others simply abandon or price too expensively. This means SVI will re-continue parts that others have discontinued or make overpriced parts available for a reasonable cost. All you have to do to experience the benefits of SVI is provide input on parts or kits that could be available from SVI, and engineering goes to work.

Right now, SVI is fast at work on a selection of repair products for Tokheim / Gasboy model 77 resets. This will mean these resets will have a friend supporting their proper operation for many years to come. Watch for more news on model 77 reset parts and for New Product Additions. Don't forget to participate in the fun and provide SVI with your suggestions for future products so SVI can put its Resource Engineering team to work for you. SVI is your Answer!



PICTURED:

**4" Swivel Joint**

**Repair Kit for OPW**

**BP-5732-24 (Ref 3002K-2400)**

SVI Part #	For	OEM Ref		Description
BP-5731-10	OPW	3001K-1000	<b>BUNAIN</b>	3/4" & 1" Swivel Joint Repair Kit
BP-5731-11	OPW	3001K-1100		1-1/4" & 1-1/2" Swivel Joint Repair Kit
BP-5731-12	OPW	3001K-1200		2" Swivel Joint Repair Kit
BP-5731-13	OPW	3001K-1300		2-1/2" & 3" Swivel Joint Repair Kit
BP-5731-14	OPW	3001K-1400		4" Swivel Joint Repair Kit
BP-5732-20	OPW	3002K-2000	<b>VITON</b>	3/4" & 1" Swivel Joint Repair Kit
BP-5732-21	OPW	3002K-2100		1-1/4" & 1-1/2" Swivel Joint Repair Kit
BP-5732-22	OPW	3002K-2200		2" Swivel Joint Repair Kit
BP-5732-23	OPW	3002K-2300		2-1/2" & 3" Swivel Joint Repair Kit
BP-5732-24	OPW	3002K-2400		4" Swivel Joint Repair Kit
BP-5733-30	OPW	3003K-3000	<b>TEFLON</b>	3/4" & 1" Swivel Joint Repair Kit
BP-5733-31	OPW	3003K-3100		1-1/4" & 1-1/2" Swivel Joint Repair Kit
BP-5733-32	OPW	3003K-3200		2" Swivel Joint Repair Kit
BP-5733-33	OPW	3003K-3300		2-1/2" & 3" Swivel Joint Repair Kit
BP-5733-34	OPW	3003K-3400		4" Swivel Joint Repair Kit

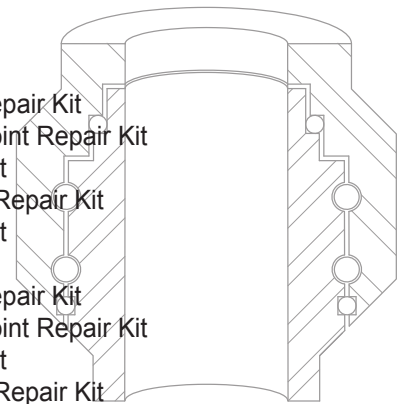

**SVI International, Inc.**

**New Product Notice**

155 Harvestore Drive • DeKalb, IL 60115

**800-321-8173 • 815-748-0200**

fax: 800-899-1784 • 815-748-0210

**E-Mail: [parts@sviintl.com](mailto:parts@sviintl.com)**