

**DIRECTFIT™**

# Service Station Pump & Tank Products

SVI International, Inc. | Pump &amp; Tank Products

***Direct Fit Brand Products for Many Makes and Models***

<b>Retractor Cables and Accessories .....</b>	<b>2-5</b>
Retractor Hose Clamps for Hose or Cable .....	2
Retractor Cable Assemblies, Bulk Cable & Tools .....	3
Retractor Cable Clamps for EV Charging Stations.....	4-5
<b>Hose Reel Hose Stops .....</b>	<b>6</b>
<b>Time Delay Relays .....</b>	<b>7</b>
<b>Lead and Wire Meter Seals .....</b>	<b>8-9</b>
<b>Pin Kit and E-Clip Kit.....</b>	<b>10</b>
<b>Pump Island Accessories .....</b>	
Signal Bells and Accessories.....	11
<b>Rebuilt Meters and Computers .....</b>	<b>12</b>
<b>Remanufactured Registers, Printers, Presets .....</b>	<b>13</b>
<b>Meter Gaskets and Kits for:.....</b>	<b>14-28</b>
Meter & Pump Unit Lip Seals .....	14
Bennett .....	14-16
Bowser .....	17
Gasboy .....	18
Fill-Rite .....	18
Gilbarco .....	14, 19-21
A.O. Smith .....	14, 22
Southwest.....	14, 23
Tokheim .....	24-26
Wayne.....	27-28
<b>Underground Storage Tank Accessories .....</b>	<b>29</b>

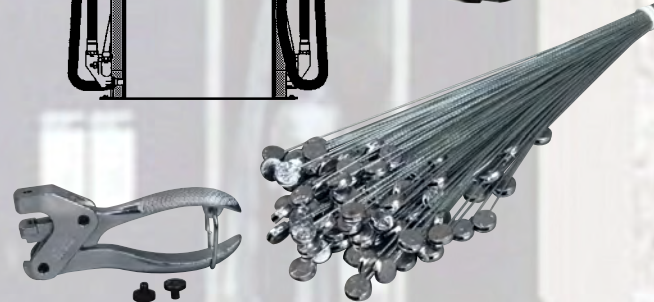
**ALSO AVAILABLE FROM SVI:**Repair Parts for  
Gasboy Consumer  
SeriesHose Reels  
and Hose StopsPortable 110V  
Transfer Pumps  
PTP-1140**SVI International, Inc.**  
155 Harvestore Drive • DeKalb, IL 60115**800-321-8173**  
**815-748-0200****www.sviinternational.com****BALTIMORE • CHICAGO • LOS ANGELES**



## Retractor Hose Clamps

**SVI Curb Pump Hose Clamps** are made of a high quality black nylon material that resists the elements. Each Clamp is free rotating, preventing the hose and retractor cable from binding or twisting. All Clamp Kits come individually packaged with all the necessary hardware along with an installation diagram. For your Hose Clamp requirements, SVI can meet all your needs. Retractor cable assemblies are sold separately. Blanket orders and quantity discounts are available upon request. **SVI is your answer.**

Also see SVI's Retractor Cable Clamps for EV Charger Cable Clamps.

### EASY AS 1 2 3

- 1 Determine Hose or Cable OD.
- 2 Choose Ball-Shaped or Clamshell Clamp Style.
- 3 Contact SVI to discuss the options—800-321-8173

#### RETRACTOR CLAMPS FOR STRAIGHT WALL CURB PUMP HOSE / SINGLE HOSE OR CABLE

SVI Part #	Style	Description	For OD (mm)	For OD (inches)	Insert Color
BP-1373-079	Ball Shaped	Retractor Clamp for:	7,9mm OD	5/16" OD	Black
BP-1373-095	Ball Shaped	Retractor Clamp for:	9,5mm OD	3/8" OD	Black
BP-1373-127	Ball Shaped	Retractor Clamp for:	12,7mm OD	1/2" OD	Black
BP-1373-142	Ball Shaped	Retractor Clamp for:	14,2mm OD	9/16" OD	Black
BP-1373-158	Ball Shaped	Retractor Clamp for:	15,8mm OD	5/8" OD	Black
BP-1373-190	Ball Shaped	Retractor Clamp for:	19,0mm OD	3/4" OD	Black
BP-1373	Ball Shaped	Retractor Clamp for:	25,4mm OD	1" OD	—
BP-1375	Ball Shaped	Retractor Clamp for:	26,2mm OD	1-1/32" OD	—
BP-1375-T	Ball Shaped	Retractor Clamp for:	25,4 to 26,2mm	1" to 1-1/32" OD	—
BP-1378-324	Ball Shaped	Retractor Clamp for:	32,4mm OD	1-1/4" OD	Black
BP-1378-355	Ball Shaped	Retractor Clamp for:	35,5mm OD	1-3/8" OD	Black
BP-1378-390	Ball Shaped	Retractor Clamp for:	39,0mm OD	1-1/2" OD	Black
BP-1394-170	Clamshell	Retractor Clamp for:	17,0mm OD	—	Black
BP-1394-237	Clamshell	Retractor Clamp for:	23,7mm OD	15/16" OD	Purple
BP-1395	Clamshell	Retractor Clamp for:	26,2mm OD	1-1/32" OD	Blue
BP-1394-264	Clamshell	Retractor Clamp for:	26,4mm OD	—	Orange
BP-1394/95	Clamshell	Retractor Clamp for:	26,9mm OD	1-1/16" OD	Blue/Black
BP-1394-282	Clamshell	Retractor Clamp for:	28,2mm OD	—	White
BP-1394	Clamshell	Retractor Clamp for:	28,5mm OD	1-1/8" OD	Black
BP-1394-287	Clamshell	Retractor Clamp for:	28,7mm OD	1-1/8" OD	White
BP-1394-290	Clamshell	Retractor Clamp for:	29,0mm OD	—	Gray
BP-1396-290	Clamshell	Retractor Clamp for:	29,0mm OD	—	White
BP-1394-294	Clamshell	Retractor Clamp for:	29,4mm OD	1-5/32" OD	Gray
BP-1394/98	Clamshell	Retractor Clamp for:	30,1mm OD	1-3/16" OD	Red/Black
BP-1396	Clamshell	Retractor Clamp for:	34,9mm OD	1-3/8" OD	Black
BP-1398	Clamshell	Retractor Clamp for:	31,7mm OD	1-1/4" OD	Red
BP-1396-324	Clamshell	Retractor Clamp for:	32,4mm OD	—	Blue
BP-1396-326	Clamshell	Retractor Clamp for:	32,6mm OD	—	Blue
BP-1396-355	Clamshell	Retractor Clamp for:	35,5mm OD	—	Orange
BP-1396-360	Clamshell	Retractor Clamp for:	36,0mm OD	—	Black
BP-1372	Clamshell	Retractor Clamp for:	36,5mm OD	1-7/16" OD	Green
BP-1397	Clamshell	Retractor Clamp for:	38,1mm OD	1-1/2" OD	Red
BP-1396-390	Clamshell	Retractor Clamp for:	39,0mm OD	—	Gray
BP-1393	Clamshell	Retractor Clamp for:	42,0mm OD	1-21/32" OD	—
BP-1396-430	Clamshell	Retractor Clamp for:	43,0mm OD	1-11/16" OD	Black



#### SPECIALTY HOSE CLAMPS

NOTE these specialty hose clamps below have not yet been tested for RoHS 3. Contact SVI for options.

SVI Part #	Style	Description	For	Insert Color
BP-1340	Clamshell	Hose Clamp for:	5/8" OD Dayco Coaxial Hose	Black
BP-1341	Clamshell	Hose Clamp for:	Goodyear Coaxial Hose	Black
BP-1344	Clamshell	Retractor Clamp for:	Goodyear Premier Hose	Black
BP-1345	Clamshell	Retractor Clamp for:	3/4" Gasoline Hose	Black
BP-1346	Clamshell	Retractor Clamp for:	1" Gasoline Hose	Black
BP-1347	Clamshell	Retractor Clamp for:	VST Coaxial Hose	Black





## Retractor Cable and Cable Assemblies

### BULK Retractor Cable (Steel or Nylon)

BP-1400 SERIES

#### Nylon Covered Steel Retractor Cable

SVI Part #	OD	Length
BP-1400-100	1/8"	100 ft. Long
BP-1400-500	1/8"	500 ft. Reel
BP-1401-100	5/32"	100 ft. Long
BP-1401-500	5/32"	500 ft. Reel
BP-1402-100	3/16"	100 ft. Long
BP-1402-500	3/16"	500 ft. Reel

BP-1400A SERIES

#### Black Braided Nylon Retractor Cable

SVI Part #	OD	Length
BP-1400A-100	1/8"	100 ft. Long
BP-1400A-500	1/8"	500 ft. Reel
BP-1400A-1000	1/8"	1000 ft. Reel
BP-1400A-3000	1/8"	3000 ft. Reel



### Retractor Cable Assemblies

For Use on all Retractor and Non-Retractor Gasoline Dispensers  
Pre Packaged and Ready to Install

SVI Part #	Material	Description	OD	Length
BP-1374	Black Braided Nylon	Cable Assembly with Hook on one end.	1/8" OD	8 ft. Long
BP-1376	Black Braided Nylon	Cable Assembly with Stop Sleeve one end.	1/8" OD	10 ft. Long
BP-1371	Nylon Covered Steel	Cable Assembly. Stop Sleeve, hook one end.	1/8" OD	8 ft. Long
BP-1384	Nylon Covered Steel	Cable Assembly with Stop Sleeve one end.	1/8" OD	7 ft. Long
BP-1385	Nylon Covered Steel	Cable Assembly with Stop Sleeve both ends.	1/8" OD	10 ft. Long
BP-1377	Nylon Covered Steel	Cable Assembly with Stop Sleeve one end.	5/32" OD	10 ft. Long



## Retractor Cable Oval Sleeves, Stop Sleeves and Tools

Oval Sleeves  
for making Loops

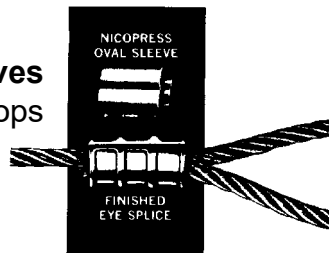

Stop Sleeves

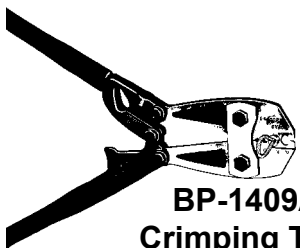

**BP-1409A**  
Crimping Tool

### OVAL SLEEVES

BP-1403	9/16" long for 1/8" Black Nylon Cable
BP-1403A	7/16" long for 1/8" Black Nylon Cable
BP-1405	11/32" long for 1/8" Nylon Steel Cable*

### STOP SLEEVES

BP-1407B	7/32" long for 1/8" Nylon Covered Steel Cable*
BP-1407C	1/8" long for 1/8" Black Nylon Cable*
BP-1408	for 5/32" and 3/16" Nylon Covered Steel Cable
BP-1408A	for 1/8" and 5/32" Nylon Covered Steel with Hook*
BP-1408B	for 5/32" Nylon Covered Steel Cable*

### TOOLS

BP-1409A	Crimping Tool (please specify sleeves to be used)
BP-1410A	Cable Cutter for Wire Rope and Nylon cable up to 1/4" diameter.

\* Indicates Sleeve used on SVI Cable Assemblies

## Retractor Clamps for Electric Vehicle (EV) Charging Stations

*Ideal for EV Charger Manufacturers, Distributors, and Installers*



Use SVI's EV Charging Cable Clamps for a well-kept professional experience.

## Electric Vehicle (EV) Charger Cable Clamps

**SVI Cable Clamps** are made of a high-quality black nylon material that resists the elements. Each EV Charger Cord Clamp is free rotating, preventing the cable or hose, and retractor cable from binding or twisting. All Clamp Kits come individually packaged with all the necessary hardware along with an installation diagram.

Change is happening fast and Electric Vehicle (EV) charging stations are starting to show up all over the place—at grocery stores, hospitals, government centers, pharmacies, parking garages, parks, hotels, and more.

SVI has kept pace with the changing needs. Long electrical cords need to be retracted up and away from the ground no differently than fuel hoses to prevent damage, and for safety.

SVI now supplies EV cord clamps. EV charger cables range in diameter size so a number of size options are becoming available. These EV clamps are supplied by SVI to some charging station manufacturers for production. For your Cable Clamp requirements, SVI can meet all your needs. **SVI is your answer.**

**Blanket orders and quantity discounts are available upon request.**

**DID YOU KNOW?** SVI offers Service Station Pump and Tank Products including Pump Island Accessories, Meter Gaskets & Kits, Time Delay Relay, Retractor Cable Assemblies, Retractor Clamps for Hose, Hose Reels, Hose Stops / Ball Stops, Lead and Wire Meter Seals, and much more!



*They need a retractor system.  
This is not a good situation.*

# Retractor Clamps for Electric Vehicle (EV) Charging Stations

## EASY AS 1 2 3

- 1 Determine EV Charger Cable OD or Hose OD.
- 2 Choose Ball-Shaped or Clamshell Clamp Style.
- 3 Contact SVI to discuss the options—800-321-8173



### RETRACTOR CLAMPS FOR CABLES / CORD / HOSE

SVI Part #	Style	Description	For OD (mm)	For OD (inches)	Insert Color
BP-1373-079	Ball Shaped	Retractor Clamp for:	7,9mm OD	5/16" OD	Black
BP-1373-095	Ball Shaped	Retractor Clamp for:	9,5mm OD	3/8" OD	Black
BP-1373-127	Ball Shaped	Retractor Clamp for:	12,7mm OD	1/2" OD	Black
BP-1373-142	Ball Shaped	Retractor Clamp for:	14,2mm OD	9/16" OD	Black
BP-1373-158	Ball Shaped	Retractor Clamp for:	15,8mm OD	5/8" OD	Black
BP-1373-190	Ball Shaped	Retractor Clamp for:	19,0mm OD	3/4" OD	Black
BP-1373	Ball Shaped	Retractor Clamp for:	25,4mm OD	1" OD	—
BP-1375	Ball Shaped	Retractor Clamp for:	26,2mm OD	1-1/32" OD	—
BP-1375-T	Ball Shaped	Retractor Clamp for:	25,4 to 26,2mm	1" to 1-1/32" OD	—
BP-1378-324	Ball Shaped	Retractor Clamp for:	32,4mm OD	1-1/4" OD	Black
BP-1378-355	Ball Shaped	Retractor Clamp for:	35,5mm OD	1-3/8" OD	Black
BP-1378-390	Ball Shaped	Retractor Clamp for:	39,0mm OD	1-1/2" OD	Black
BP-1394-170	Clamshell	Retractor Clamp for:	17,0mm OD	—	Black
BP-1394-237	Clamshell	Retractor Clamp for:	23,7mm OD	15/16" OD	Purple
BP-1395	Clamshell	Retractor Clamp for:	26,2mm OD	1-1/32" OD	Blue
BP-1394-264	Clamshell	Retractor Clamp for:	26,4mm OD	—	Orange
BP-1394/95	Clamshell	Retractor Clamp for:	26,9mm OD	1-1/16" OD	Blue/Black
BP-1394-282	Clamshell	Retractor Clamp for:	28,2mm OD	—	White
BP-1394	Clamshell	Retractor Clamp for:	28,5mm OD	1-1/8" OD	Black
BP-1394-287	Clamshell	Retractor Clamp for:	28,7mm OD	1-1/8" OD	White
BP-1394-290	Clamshell	Retractor Clamp for:	29,0mm OD	—	Gray
BP-1396-290	Clamshell	Retractor Clamp for:	29,0mm OD	—	White
BP-1394-294	Clamshell	Retractor Clamp for:	29,4mm OD	1-5/32" OD	Gray
BP-1394/98	Clamshell	Retractor Clamp for:	30,1mm OD	1-3/16" OD	Red/Black
BP-1396	Clamshell	Retractor Clamp for:	34,9mm OD	1-3/8" OD	Black
BP-1398	Clamshell	Retractor Clamp for:	31,7mm OD	1-1/4" OD	Red
BP-1396-324	Clamshell	Retractor Clamp for:	32,4mm OD	—	Blue
BP-1396-326	Clamshell	Retractor Clamp for:	32,6mm OD	—	Blue
BP-1396-355	Clamshell	Retractor Clamp for:	35,5mm OD	—	Orange
BP-1396-360	Clamshell	Retractor Clamp for:	36,0mm OD	—	Black
BP-1372	Clamshell	Retractor Clamp for:	36,5mm OD	1-7/16" OD	Green
BP-1397	Clamshell	Retractor Clamp for:	38,1mm OD	1-1/2" OD	Red
BP-1396-390	Clamshell	Retractor Clamp for:	39,0mm OD	—	Gray
BP-1393	Clamshell	Retractor Clamp for:	42,0mm OD	1-21/32" OD	—
BP-1396-430	Clamshell	Retractor Clamp for:	43,0mm OD	1-11/16" OD	Black

## Two Piece "Donut Style" Hose Reel Hose Stops



*Designed to provide slip-free performance on air, water, grease and oil hose.*

*Choose Standard or wide style. L style are the larger style equal to Lincoln style. All hardware is included. Huge Hose Stop Selection Available! Call today for our Hose Stop catalog!*

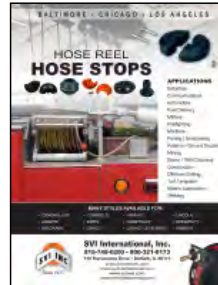

### APPLICATIONS

Industrial  
Communications  
Automotive  
Fuel Delivery  
Military  
Firefighting  
Maritime  
Paving / Sealcoating  
Aviation /  
Ground Support  
Mining  
Sewer / Well Cleaning  
Construction  
Offshore Drilling  
Turf / Irrigation  
Mobile Lubrication  
Welding

**SVI has the largest selection of in-stock hose stops at industry-best pricing.**

	<b>BP-1525 - Standard</b> <b>FOR 3/8" ID HOSE</b> Hose Stop Dimensions: 2.75" OD    0.611" ID    1.14" Thick		<b>BP-1525L - Larger OD Style</b> <b>FOR 3/8" ID HOSE</b> Hose Stop Dimensions: 3.625" OD    0.611" ID    1.14" Thick
	<b>BP-1526 - Standard</b> <b>FOR 1/2" ID HOSE</b> Hose Stop Dimensions: 2.75" OD    0.78" ID    1.14" Thick		<b>BP-1526L - Larger OD Style</b> <b>FOR 1/2" ID HOSE</b> Hose Stop Dimensions: 3.625" OD    0.78" ID    1.14" Thick
	<b>BP-1527 - Standard</b> <b>FOR 1/4" ID HOSE</b> Hose Stop Dimensions: 2.75" OD    0.522" ID    1.14" Thick		<b>BP-1527L - Larger OD Style</b> <b>FOR 1/4" ID HOSE</b> Hose Stop Dimensions: 3.625" OD    0.522" ID    1.14" Thick
	<b>BP-1528L - Larger OD Style</b> <b>FOR 11/16" ID HOSE</b> Hose Stop Dimensions: 4.25" OD    1.375" ID    2" Thick		<b>BP-1529L - Larger OD Style</b> <b>FOR 29/32" ID HOSE</b> Hose Stop Dimensions: 4.25" OD    1.875" ID    2" Thick
	<b>BP-1532-46</b> (Ref 237872, 237-872) <b>FOR 5/8" ID HOSE</b> Hose Stop Dimensions: 3.62" OD    1" ID    1.5" Thick		<b>BP-1531-10</b> (Ref 339389-2) <b>FOR 3/4" ID FUEL HOSE</b> Hose Stop Dimensions: 3.5" OD    1.031" ID    2.88" Thick <b>For 1.06" to 1.38" OD Fuel Hose</b>

**Many other styles and sizes available! Call today for our catalog!**

**MANY STYLES  
AVAILABLE FOR:**

• GENERAL USE  
• ALEMITE  
• BALCRANK

• COXREELS  
• DURO  
• GRACO

• HANNAY  
• HOSETRACT  
• LEGACY LEVELWIND

• LINCOLN  
• REELCRAFT  
• SAMSON



## Time Delay Relay (TDR)

### Leak Detector Time Delay Relay - Adjustable • BP-4170-FSD

**SVI's Leak Detector Time Delay Relay (TDR) BP-4170-FSD** helps eliminate thermal line contraction in service station pumps located where the temperatures dip into the chilly range. Leak detectors, which delay the product flow for two seconds, have some problems. When the air temperature is colder than the temperature inside the tank diaphragm style leak detectors do not stay primed. Pressure is not maintained in the lines from the submersible pump. Consequently, a two second delay is not long enough for the fuel to return and the leak detector misinterprets low pressure as a leak and slows the product flow. The BP-4170-FSD, which delays the product flow, **solves most of these problems**. *SVI is your answer!*

***The BP-4170-FSD is the best time delay relay available and at a great, low price.***

- At only 1-1/4" x 1-1/4" x 0.6" high it will fit in the tightest junction boxes.
- One feature which makes the BP-4170-FSD stand out is its **field selectability**. It contains a timing switch with 10 positions and indicator. The BP-4170-FSD is adjustable from a 1/2 second delay to 9-1/2 second delay. Select 0 for 1/2 second delay. Each subsequent position increases in 1 second increments. (Select 1 for 1-1/2 second delay, 2 for 2-1/2 second delay, etc.).
- The switch is easily visible and simple to adjust. No guess work is required.
- There is also no chance of losing the position while turning a pod.



**ADJUSTABLE /  
FIELD SELECTABILITY**

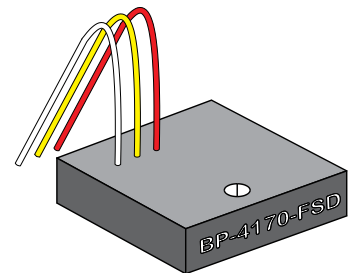

#### SPECIFICATIONS

<b>POWER INPUT</b>	130 VAC maximum @ 60 Hz, the internal circuitry uses 1.5 watts.
<b>OUTPUT CURRENT</b>	The module can deliver a maximum of 4 Amps to a load.
<b>TIMING RANGE</b>	From .5 seconds (switch at 0) to 9.5 seconds (switch at 9).
<b>TIMING ACCURACY</b>	Plus or minus 10 percent from actual switch setting.
<b>CASE SIZE</b>	1.25" x 1.25" x 0.6" Lead length approximately 8"
<b>MATERIAL</b>	<b>Potting Shell:</b> Glass-Filled Diallyl Phthalate <b>Potting Compound:</b> High density Polyurethane (meets U.L. 94 V-O) <b>Wire Insulation:</b> PVC

#### TECHNICAL DESCRIPTION

The **BP-4170-FSD** module in its simplest terms is a Solid State Relay with a time delay control circuit.

- The **RED** lead supplies power to the timer circuit and to the output switch (a triac).
- The **YELLOW** lead connects to the output of the triac switch.
- The **WHITE** lead is the power return connection for the delay circuit.
- The time delay circuit is controlled by a switched capacitor R-C timer. The switch allows setting the time delay in seconds.

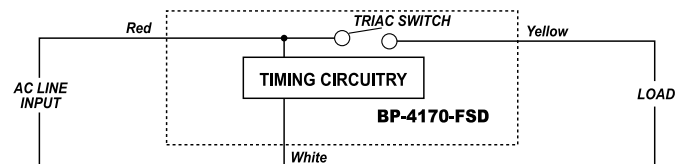

#### ALSO AVAILABLE:

#### **BP-4170-FSN Leak Detector Time Delay Relay - Adjustable**

**FSN Style is designed for Older Model Tokheim Pumps** with electric reset and the AC line voltage from the pump handle. It is designed for those situations that require the load (solenoid valve) to be switched to the neutral side of the line.

## TAMPER-EVIDENT SECURITY SEALS

### DISPENSER REPAIR PARTS

# Wire Meter Seals

Gasoline / Diesel Meter Calibration Seals

Aluminum or Lead Wire Seals

#### MANY APPLICATIONS:

METERS / UTILITIES  
AUTOMOTIVE  
AGRICULTURAL / FOOD  
AIRCRAFT  
CHEMICAL INDUSTRIES  
LAW ENFORCEMENT / MILITARY  
STORAGE / INVENTORY  
VALVE TAGS  
PUMPS  
TRANSFER HOPPERS  
SPRINKLER SYSTEMS  
SCALES  
AND MORE

### Lead and Wire Seals

Lead Wire Meter Security Seals are made in a combination of 1/2" diameter double-slotted seal with a 3-ply galvanized steel wire available in 12", 18", 24" and 36" lengths. Used for water and gas meters, connections, boxes, controls, valves, etc. Lead and Wire Meter Seals are effective only when properly sealed. Use of BP-1469 crimping tool assures correct sealing. Turnaround on lead and wire meter seals, crimpers, and recessed imprinted dies is very quick, as in same to next day shipping.

Lead Wire Seals are sold in Bags of 100

Bulk Lead Seals are sold in Bags of 100

Bulk Wire Available in 1000' Spools—30# AWG or 26# AWG

### Aluminum and Wire Seals

*Aluminum Seals are now available for those who cannot use the lead seals due to regulatory requirements!*

Whether you're in California or another location that doesn't allow lead seals, you now have a great alternative option. Aluminum Seals are resistant to higher temperatures than lead seals and are more resistant to chemicals than plastic seals. Aluminum Seals are available in two sizes including 5/16" (8mm) or 1/2" (12mm). The standard Aluminum and Wire Seals consist of a 12mm aluminum seal and 3-ply galvanized steel available in lengths of 10" 14", or 18". Used for water and gas meters, connections, boxes, controls, valves, etc. Lead / Aluminum and Wire Meter Seals are effective only when properly sealed. Use of BP-1469 crimping tool assures correct sealing.

**Important Note:** When using aluminum seals, use Blank Dies or must request BP-1459DS Raised Letter Imprinted Dies, sold separately. Recessed Imprinted Dies do not work for Aluminum Seals. Please note, raised letter imprinted dies have a 1-2 week turnaround. All other standard wire seals, crimpers and dies ship quickly, usually same day or next day.

Aluminum Wire Seals are sold in Bags of 250

Bulk Aluminum Seals are sold in Bags of 500

Bulk Wire Available in 1000' Spools—30# AWG or 26# AWG

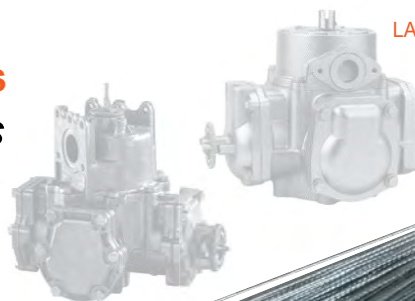

### LEAD AND WIRE SEAL

Wire Lengths:  
12" • 18" • 24" • 36"



### ALUMINUM AND WIRE SEAL

Wire Lengths:  
10" • 14" • 18"



#### USE WITH BLANK OR CUSTOM IMPRINTED DIES

#### 5" Chrome-Finished Crimper / Seal Press

BP-1469 • Furnished with hard cams for long life with special leverage for easy hand grip. 2 blank or recessed imprinted dies included.

**Important Note:** With Aluminum Seals, use Blank Dies. Or, use Raised Letter Imprinted Dies, Sold Separately.

**Blank Dies:** For use with Lead or Aluminum Seals. Turnaround is Very Quick, as in Same to Next Day Shipping.

**Recessed Imprinted Dies:** For use with Lead Seals Only. Turnaround is Very Quick, as in Same to Next Day Shipping.

**\*Raised Imprinted Dies:** For use with Aluminum or Lead Seals. Please Note: There is an approximate 1-2 week turnaround for raised imprinted dies.

Same-Day to Next-Day Shipping is our goal on all of these products with the only exception being raised letter imprinted dies, which have an approximate 1-2 week turnaround.\*

P Bulk Wire Spools and Seals Available!

a  
g  
e  
8

**Get your meter sealing supplies today—**

**Call Now: 800-321-8173**

**PEI**  
MEMBER  
Since 1977



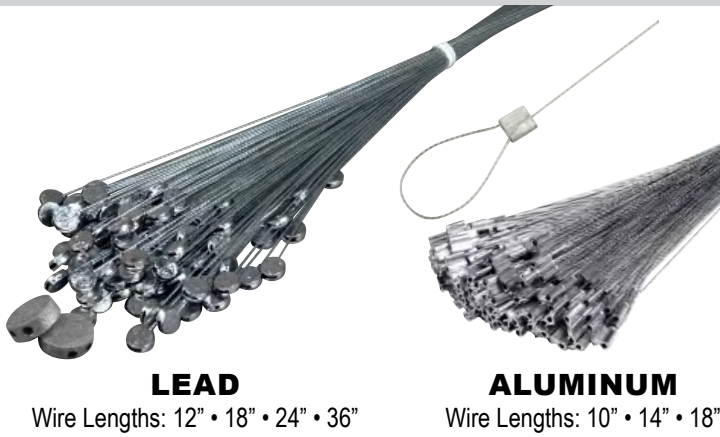

## LEAD

Wire Lengths: 12" • 18" • 24" • 36"

## ALUMINUM

Wire Lengths: 10" • 14" • 18"



## 5" Chrome-Finished Crimper / Seal Press

BP-1469 • Furnished with hard cams for long life with special leverage for easy hand grip. 2 blank or recessed imprinted dies included.

**Important Note:** With Aluminum Seals, use Blank Dies. Or, use Raised Letter Imprinted Dies, Sold Separately.

## USE WITH BLANK OR CUSTOM IMPRINTED DIES

**Blank Dies:** For use with Lead or Aluminum Seals. Turnaround is Very Quick, as in Same to Next Day Shipping.

**Recessed Imprinted Dies:** For use with Lead Seals Only. Turnaround is Very Quick, as in Same to Next Day Shipping.

**\*Raised Imprinted Dies:** For use with Aluminum or Lead Seals. Sold Separately. Please Note: There is an approximate 1–2 week turnaround for raised imprinted dies.

**Same-Day to Next-Day Shipping is our goal on all of these products with the only exception being raised letter imprinted dies, which have an approximate 1-2 week turnaround.**

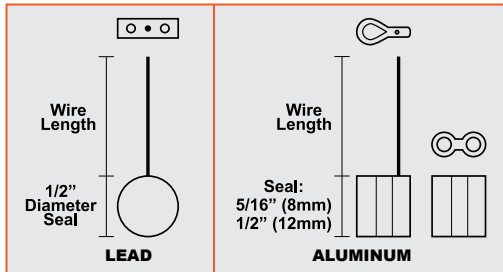

SVI Part #	Quantity	For:	Description
<b>LEAD SECURITY SEALS - Wire Seals Featuring 1/2" Lead Seal</b>			
BP-1468-12	Bag of 100	Meter Seal:	12" Wire with Lead Seal #26 AWG, 3-Ply
BP-1468-18	Bag of 100	Meter Seal:	18" Wire with Lead Seal #26 AWG, 3-Ply
BP-1468-24	Bag of 100	Meter Seal:	24" Wire with Lead Seal #26 AWG, 3-Ply
BP-1468-36	Bag of 100	Meter Seal:	36" Wire with Lead Seal #26 AWG, 3-Ply
<b>ALUMINUM SECURITY SEALS - Wire Seals Featuring 1/2" (12mm) Aluminum Seal</b>			
BP-1468A-10	Bag of 250	Meter Seal:	10" Wire with Aluminum Seal #30 AWG, 3-Ply
BP-1468A-14	Bag of 250	Meter Seal:	14" Wire with Aluminum Seal #30 AWG, 3-Ply
BP-1468A-18	Bag of 250	Meter Seal:	18" Wire with Aluminum Seal #30 AWG, 3-Ply
BP-1468AV-10	Bag of 250	Meter Seal:	10" Wire with Aluminum Seal #26 AWG, 3-Ply
BP-1468AV-14	Bag of 250	Meter Seal:	14" Wire with Aluminum Seal #26 AWG, 3-Ply
BP-1468AV-18	Bag of 250	Meter Seal:	18" Wire with Aluminum Seal #26 AWG, 3-Ply

## BULK SEALS - Choose Lead or Aluminum Seals • Bulk Wire Options and Crimpers Also Available

BP-1468-LEAD	Bag of 100	Meter Seal:	Lead Seals Only 1/2"
BP-1468A-SEAL	Bag of 500	Meter Seal:	Aluminum Seals Only 1/2" (12mm)
BP-1468AV-SEAL	Bag of 500	Meter Seal:	Aluminum Seals Only 5/16" (8mm)

## BULK WIRE - 3-Ply Galvanized Steel Wire • For use with Bulk Lead or Aluminum Seals

BP-1468-WIRE	Spool/1000'	Meter Seal:	1000' Wire Only #26 AWG, 3-Ply
BP-1468A-WIRE	Spool/1000'	Meter Seal:	1000' Wire Only #30 AWG, 3-Ply

## SEAL PRESS CRIMPER AND DIES

BP-1469		Meter Seal:	Crimper Tool With 2 Blank Dies
BP-1469D	Recessed Letters	Meter Seal:	Die Only Lead Seal (5 characters max)
BP-1469DA*	Raised Letters	Meter Seal:	Die Only Aluminum Seal (3 characters max)

**Same-Day to Next-Day Shipping is our goal on all of these products with the only exception being raised letter imprinted dies, which have an approximate 1-2 week turnaround.**



## Pin Kits and E-Clip Kits

### BP-4301 Pin Kits

### BP-4320 "E" Clip Kits

All the hard-to-find computer couplings, pump and dispenser handle pins, brass totalizer seals are available in one convenient kit. No more searching for odd sizes or ordering from a number of different sources just to be able to repair pumps and dispensers. Replacement pins are available in bags of 25.

#### BP-4301\* Pin Kit Contents:

<b>BP-4302</b>	Pin for Veeder-Root Computer Model #56-5/16"
<b>BP-4303</b>	Bennett drive gear pin
<b>BP-4304</b>	Coupling pin for Veeder-Root Model #36 and # 49
<b>BP-4305</b>	Tokheim handle and spring pin
<b>BP-4306</b>	Bennett handle and spring pin
<b>BP-4307</b>	Wayne handle spring pin
<b>BP-4308</b>	Veeder-Root groove pin, Tokheim reset coupling pin
<b>BP-4309</b>	Center groove pin for Veeder-Root, Gilbarco, Tokheim
<b>BP-4311</b>	Tokheim handle spring pin and Bennett handle pin
<b>BP-4312</b>	Bennett handle spring pin
<b>BP-4313</b>	Gilbarco handle spring pin
<b>BP-4314</b>	Center groove pin for Veeder-Root #56 and 56A
<b>BP-4315</b>	Pin for all couplings for reset on 3/8" shaft
<b>BP-4316</b>	Tokheim handle spring pin 1/8" x 1-1/8"
<b>BP-4317</b>	Tokheim handle spring pin 1/8" x 1-1/4"
<b>BP-4318</b>	Wayne handle spring pin

No Longer Included: **BP-4319** Brass Totalizer Seals (100 per kit or replacement bag)  
**BP-4310** Reset cam pin for Veeder-Root #36 and #49

#### BP-4320\* Clip Kit Contents:

<b>BP-4321</b>	3/16"	E Clip 25 pcs.
<b>BP-4322</b>	7/32"	E Clip 25 pcs.
<b>BP-4323</b>	1/4"	E Clip 25 pcs.
<b>BP-4324</b>	5/16"	E Clip 25 pcs.
<b>BP-4325</b>	3/8"	E Clip 25 pcs.
<b>BP-4326</b>	7/16"	E Clip 25 pcs.
<b>BP-4327</b>	13/16"	E Clip 25 pcs.
<b>BP-4328</b>	1/2"	E Clip 25 pcs.
<b>BP-4329</b>	5/8"	E Clip 25 pcs.

\*CONTENTS OF KIT ARE SUBJECT TO CHANGE  
 DUE TO PRODUCT AVAILABILITY. Please verify  
 contents of the kit before ordering.

**18-Compartment Plastic Box**  
 (BP-4301-01)

**Included with BP-4301 and BP-4320**

## Pump Island Accessories Signal Bells and Accessories

Complete enclosure of the entire drive lets station attendants know the instant a car crosses the sidewalk. Signal bell warnings are ideal for full service stations or for any facility where security demands that attendants are warned when a car approaches.



**BP-1515A**

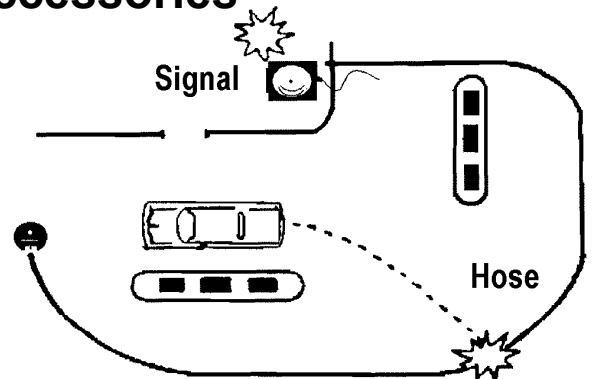

SVI offers a specially compounded Signal Bell hose which provides long life and withstands flexing, loads, temperature and ozone. Furnished in 100 ft. and 300 ft. coils.

<b>BP-1515A</b>	Electric Signal Bell - UL Approved with 3 Wire Ground Cord
<b>BP-1517</b>	Control Switch - All purpose unit for most signals. Has protector cover and mounting bracket. Works on 110 volt or 10 volt.
<b>BP-1517A</b>	Control Switch - Has no Bracket or Cover. Fits these signal bells only.
<b>BP-1517B</b>	Control Switch - Weathertite, Switch on FSBC Cover
<b>BP-1520</b>	Hose Anchor - End Weight
<b>BP-1521</b>	Hose Wye Fitting with Clamps
<b>BP-1522</b>	Hose Splicer with Clamps
<b>BP-1523</b>	Coil Plunger Assembly
<b>BP-1524-100</b>	100' Coil Driveway Signal Hose
<b>BP-1524</b>	300' Coil Driveway Signal Hose

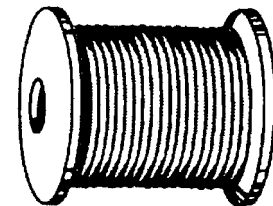

**BP-1517**

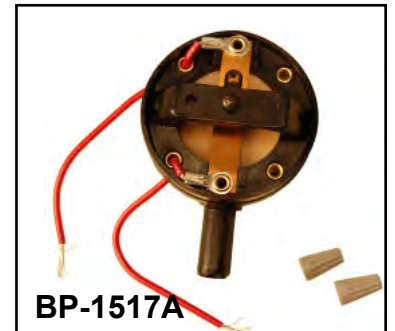

**BP-1517A**

*SVI also offers Milton Brand Signal Bells and Accessories—Series AS-0802  
Contact SVI Today!*

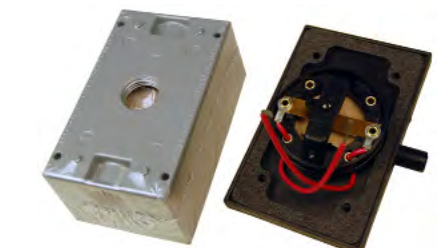

**BP-1517B** (hardware not pictured)



**BP-1520**



**BP-1523**





## Rebuilt Meters and Computers

### (Exchange or No Exchange)

This is a simple way to get quality rebuilt meters at a competitive price. It is no longer necessary to send a core for exchange just to get a remanufactured meter. SVI eliminates these hassles but keeps the option open should a core want to be returned.

- \* Pre-Calibrated at the Factory**
- \* No Exchange Needed**
- \* Can Ship via UPS**
- \* 12 Month No Charge Replacement Warranty**

<u>SVI Part #</u>	<u>The Meter</u>	<u>Shipping Weight</u>
BP-4571	Bennett 4000 Meter	40 lbs.
BP-4572	Gilbarco New Style Meter PA-24	15 lbs.
BP-4573	Gilbarco Electronic PA-24T	15 lbs.
BP-4574	A.O. Smith PM-2 Meter	15 lbs.
BP-4575	A.O. Smith Electronic	15 lbs.
BP-4576	Southwest E-435-B New Style	15 lbs.
BP-4577	Tokheim 898K Meter	43 lbs.
BP-4578	Wayne 2PM-4,5,6	10 lbs.
BP-4579	Wayne Electronic	10 lbs.

## SVI also offers Rebuilt 2002 and 2002E Computers

<u>SVI Part #</u>	<u>Computer</u>	<u>Shipping Weight</u>
BP-4580	Veeder - Root 2002	35 lbs.
BP-4581	Veeder - Root 2002E	35 lbs.

When ordering meters and computers please specify if there is a core to return or the sale is outright with no core. Our pricing is based on the outright sale of meters and computers.



## Remanufactured Registers, Printers, Presets

*Most of the following must be exchanged for an identical core.*

SVI #	OEM Ref. #	Description
<b>BP-4585-101</b>	788700-002	Meter Register - New Style
<b>BP-4585-102</b>	169200	Meter Register - Old Style
<b>BP-4585-103</b>	788700-002/187180	Meter Register - New Style with Pulser
<b>BP-4585-104</b>	169200/187180	Meter Register - Old Style with Pulser
<b>BP-4585-105</b>	789001-001	Meter Register - New Style/Accumulative Printer Two Handle Reset
<b>BP-4585-106</b>	789000-001	Meter Register - New Style/Zero Start Printer Two Handle Reset
<b>BP-4585-107</b>	789001-002	Meter Register - New Style/Accumulative Printer Single Handle Reset
<b>BP-4585-108</b>	789000-002	Meter Register - New Style/Zero Start Printer Single Handle Reset
<b>BP-4585-109</b>	789001-003	Meter Register - New Style/Accumulative Printer Single Handle Reset • No Weather Cover
<b>BP-4585-110</b>	789000-003	Meter Register - New Style/Zero Start Printer Single Handle Reset • No Weather Cover
<b>BP-4585-111</b>	169600	Meter Register - Old Style/Accumulative Printer Two Handle Reset
<b>BP-4585-112</b>	169300	Meter Register - Old Style/Zero Start Printer Two Handle Reset
<b>BP-4585-113</b>	169500	Meter Register - Old Style/Accumulative Printer Two Handle Reset • 1/10 Gallon Wheel
<b>BP-4585-114</b>	169400	Meter Register - Old Style/Zero Start Printer Two Handle Reset • 1/10 Gallon Wheel
<b>BP-4585-115</b>	169500	Meter Register - Old Style/Accumulative Printer Two Handle Reset • 1/10 Gallon Wheel • No Weather Cover
<b>BP-4585-116</b>	169400	Meter Register - Old Style/Zero Start Printer Two Handle Reset • 1/10 Gallon Wheel • No Weather Cover
<b>BP-4585-117</b>	788901	Meter Preset
<b>BP-4585-118</b>	788811-001	Ticket Printer (Accumulative)
<b>BP-4585-119</b>	788810-001	Ticket Printer (Zero Start)

## Meter and Pump Unit Lip Seals / Shaft Seals

**DIRECTFIT™**  
SVI's DIRECT FIT™ BRAND

*Each sold individually.*



**5/8" Meter Lip Seal - Viton**  
For Wayne  
BP-2602

**5/8" Pump Unit Seal - Viton**  
For Gilbarco  
BP-2603 (Ref K82472)



**3/4" Pump Unit Seal - Viton**  
For Southwest and others  
BP-2604



**1/2" Meter Lip Seal  
Viton**  
For A.O. Smith  
BP-2601



**3/4" Meter Lip Seal /  
Shaft Seal - Viton**  
For Bennett  
BP-2605 (Ref A323701)



**1" Gerotor Pump  
Shaft Seal - Viton**  
For Gilbarco  
BP-2606 (Ref N23196)

SVI is always working to improve your profit performance on each service call you make.

**The "V" in SVI stands for real value. . .**

DeKalb, Illinois—The SVI new product development team, in conjunction with the engineering department and distributor-driven input are pleased to expand our offering of Meter and Pump Unit Lip Seals. While most of these have been in our product offering for quite some time, we've added BP-2606 (ref N23196) for Gilbarco to better serve you. The seals pictured above (sold individually) are for use on pumps and meters such as A.O. Smith, Wayne, Gilbarco, Southwest, and Bennett. SVI's selection of repair/rebuild parts for gas pumps and meters has been growing and we welcome your business and suggestions for what kits and parts we should put on the development schedule.

Note: Distributor input is driving us and continues to increase. What pump related kits or problems do you need us to work on for you?

Contact an SVI representative with any questions, to place an order or to suggest other pump repair parts and kits you would like to see us add to our product line.



SVI Part #	For OEM	OEM Ref #	Description
BP-2601	A.O. Smith		1/2" Meter Lip Seal (1) - Viton
BP-2602	Wayne		5/8" Meter Lip Seal (1) - Viton
BP-2603	Gilbarco	K82472	5/8" Pump Unit Seal (1) - Viton
BP-2604	Southwest		3/4" Pump Unit Seal (1) - Viton
BP-2605	Bennett	A323701	3/4" Meter Lip Seal (1) - Viton
BP-2605T	Bennett	A323701	3/4" Meter Lip Seal (1) - TFE
BP-2606	Gilbarco	N23196	1" Gerotor Pump Shaft Seal (1) - Viton



# Gaskets and Kits for Bennett Meters

**DIRECTFIT™**  
SVI's DIRECT FIT™ BRAND

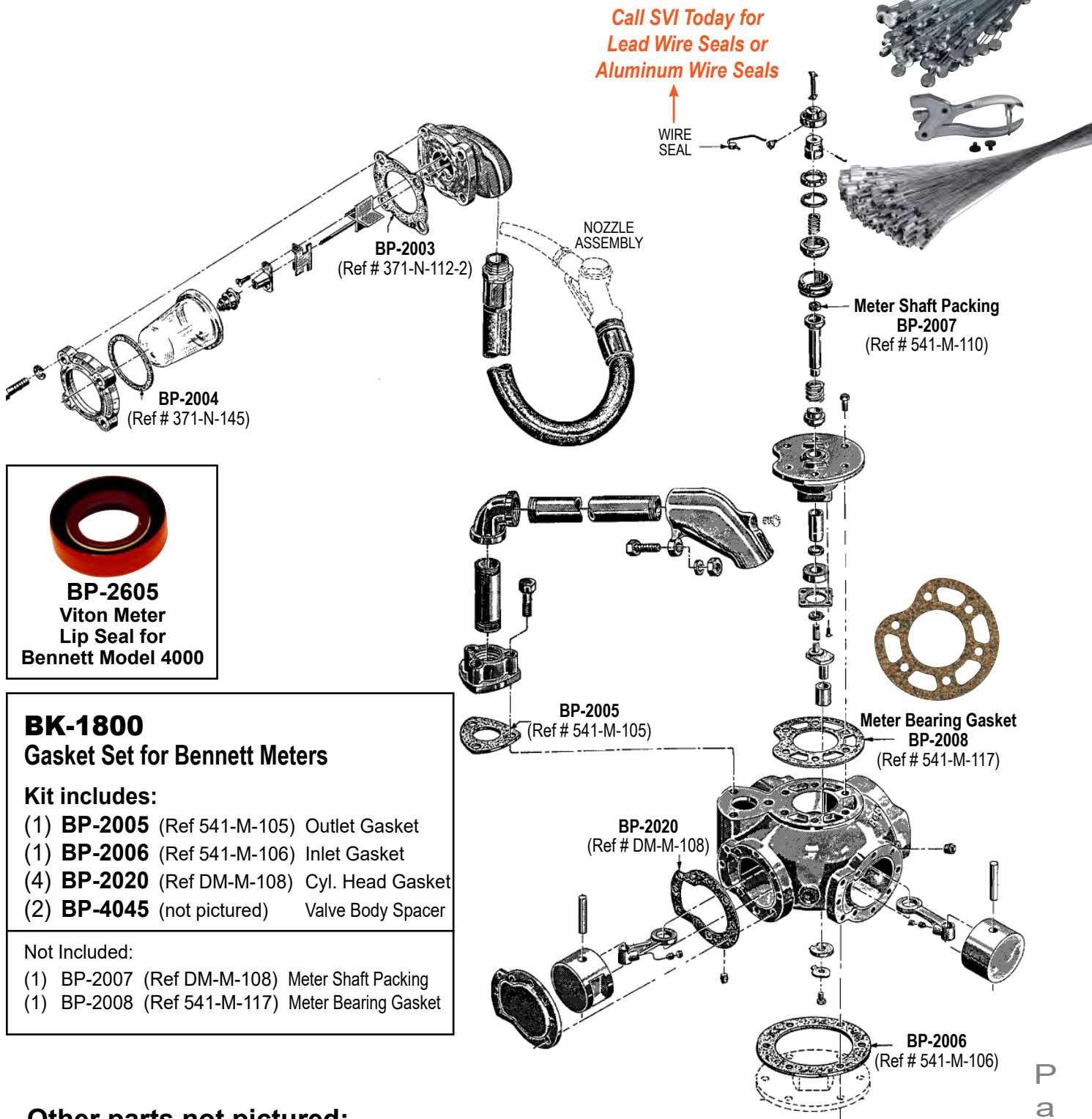

## Other parts not pictured:

SVI #	OEM #	Description
<b>BP-2017</b>	546-N-102	Visa Gauge Flange Gasket
<b>BP-2025</b>	764-N-108	Shut Off Valve Cover Gasket

## Gaskets and Kits for Bennett Pumping Units

For P-40 Pumping Unit and Air Eliminator Assemblies used in all self contained gasoline pumps.

**DIRECTFIT™**  
SVI's DIRECT FIT™ BRAND

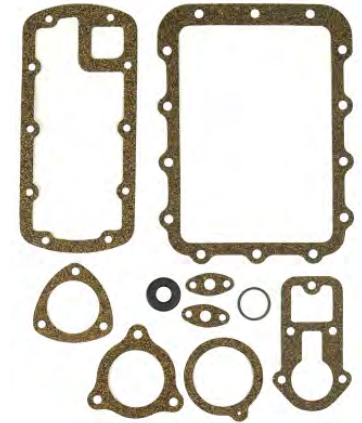

### BK-1802 Pump Unit Kit Includes:

- (1) **BP-2009** 541-N-100 Eliminator Cover Gasket
- (2) **BP-2010** 541-N-105 Float Valve Gasket
- (1) **BP-2011** 541-N-107 Chamber Gasket
- (1) **BP-2013** 541-N-124 Bypass Cover Gasket
- (1) **BP-2014** 541-N-125 Control Valve Cover Gasket
- (1) **BP-2015** 541-N-130 Strainer Cover Gasket
- (1) **BP-2021** DMA-N-160 Poppet Disk
- (1) **BP-4105** Strainer Cover Gasket for Blenders (not pictured)

### No Longer Included:

- (1) **BP-2012** 541-N-118 Pump Cover Gasket
- (1) **BP-2057** A2470-14 (not pictured) - NLA

*Call SVI Today for  
Lead or Aluminum Wire Meter Seals  
and Crimpers*

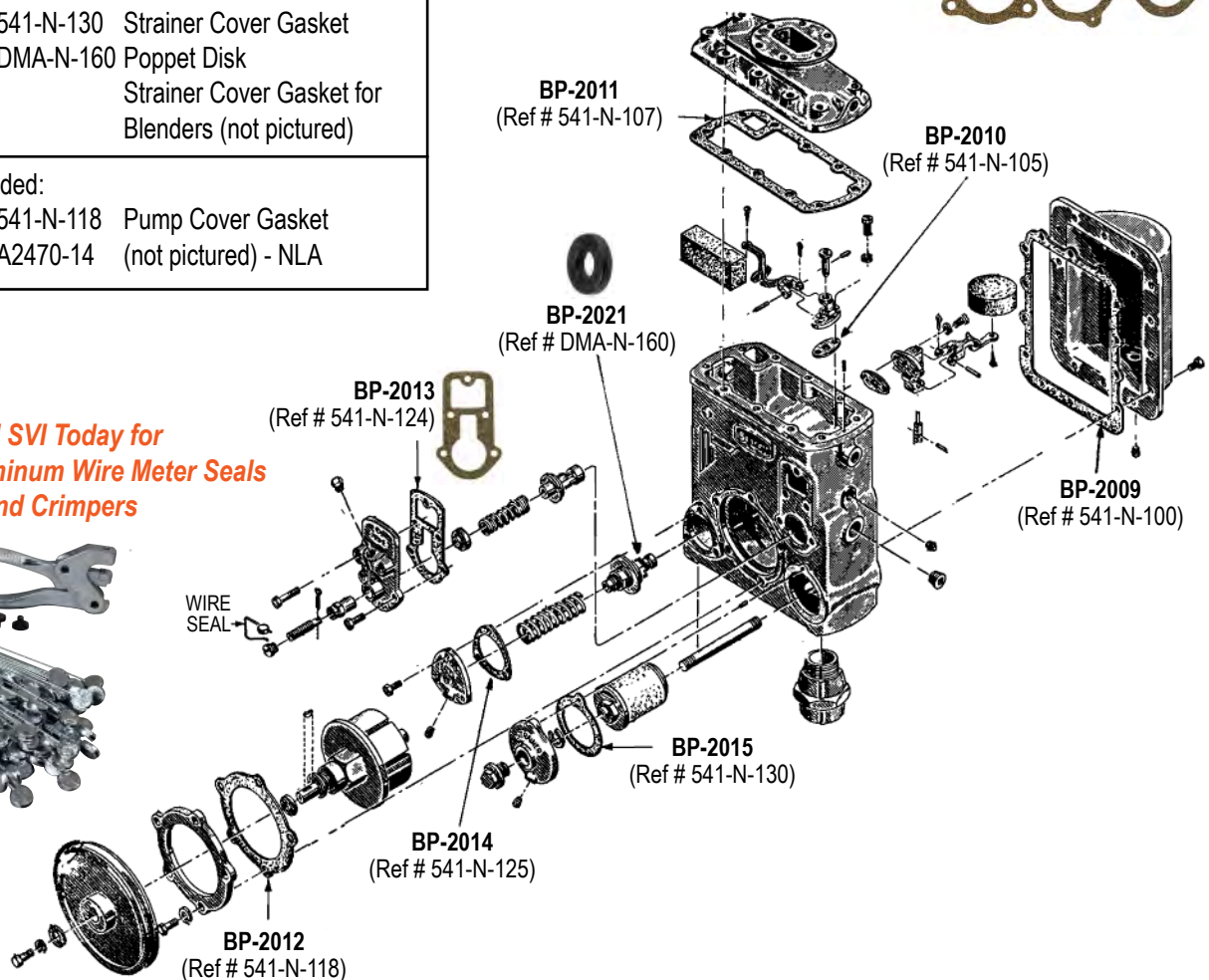

### ALSO AVAILABLE FOR BENNETT:



**Pump Vane /  
Rotor Blade for  
Bennett Model 40**

**BP-2021-01**  
(Ref S-41N100501)



**Pump Vane / Rotor  
Blade for Bennett  
70-75 Series**

**BP-2021-02**  
(Ref 110704)

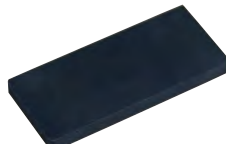

**Pump Vane Series  
T75 Carbon**

**BP-2021-03**  
(Ref 110704, N2382-01)



**Switch for Bennett  
3000 Series  
(3362, 3372, 3382)**

**BP-4109**  
(Ref A2759)



**Reset Switch for  
Bennett / Tokheim**

**BP-4101**  
(Ref A2782-01,  
1-126600)

# Gaskets, Meter Parts and Kits for Bowser Meters

**DIRECTFIT™**  
SVI's DIRECT FIT™ BRAND

## Bowser Meter Cross Section

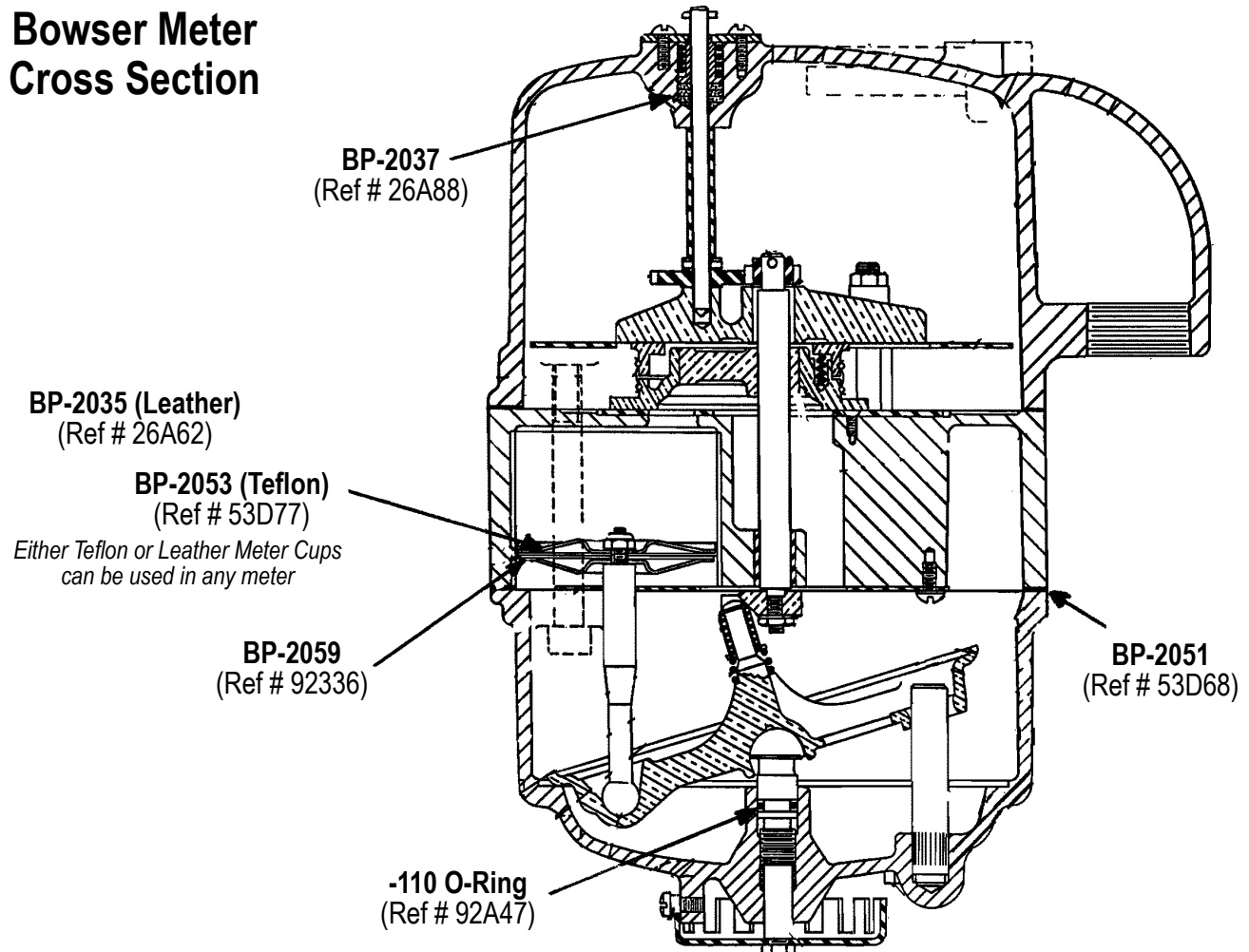

### Other Gaskets not pictured:

SVI #	OEM #	Description
<b>BP-2028</b>	11A75	Inlet/Outlet Meter Gasket
<b>BP-2030</b>	13D71	Meter Outlet Gasket
<b>BP-2036</b>	26A75	Meter Bowl Gasket
<b>BP-2038</b>	26A92	Seal Cap Gasket
<b>BP-2042</b>	31D52	Riser Triangle Gasket
<b>BP-2433</b>	51J20	Pump Seal Nut Gasket

### **BK-1804** Kit for 500 Series Meters *(not pictured)*

(1)	<b>BP-2028</b>
(1)	<b>BP-2030</b>
(2)	<b>BP-2036</b>
(5)	<b>BP-2037</b>
(1)	<b>BP-2038</b>
(1)	<b>BP-2042</b>

### **BK-1805** Kit for 48, 51, 405, 406, 407, 481, 482, 511, 512 and "R" Series, 1500 and 4800 Series Meters

(5)	<b>BP-2037</b>
(2)	<b>BP-2051</b>
(1)	<b>BP-2052</b>
(1)	<b>-110 O-Ring</b>
(1)	<b>BP-2059</b>

**Call SVI Today for Seal Press  
Crimper and Wire Meter Seals  
Available in Aluminum or Lead!**





## Repair Parts for Gasboy Consumer Series

*Call today for our Gasboy Consumer Series Repair Parts Catalog!*



**BP-4218-20**

(BP-4218-20R - Red)

Motor for 70 Series

1/3 HP Motor 60Hz. 48 Frame

(Available in Red, White or Beige)

(OEM Ref # F37332)

*Repair Parts for  
Gasboy and Tokheim  
are Available from SVI!*



**BP-4210-01**

Repair Kit for 1800, 70, 390  
(OEM # 032888)

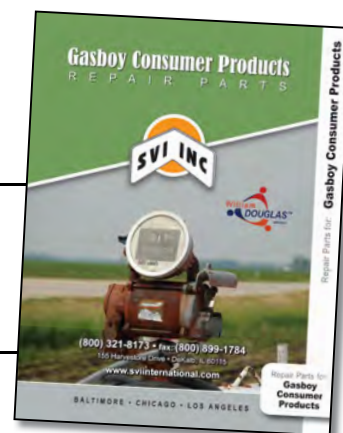

**BP-4210-22**

Rotor for 70 Series, 1800 & 390  
(OEM # 051475)



**BP-4210-28**

Check Valve Assembly  
(OEM # 066655)



**BP-4210-67**

Check Valve Assembly  
(OEM # 035319)



**BP-4211-08**

Check Valve - 60 Series  
(OEM # 066686)



**BP-4218-30R**

Nozzle Boot  
70 Series (Red)  
(OEM # 000325PG8)

Meter Register with Dial Glass  
**Order BP-4210-30KP**

Without Dial Glass,  
Order **BP-4210-30**

With Long Shaft  
Order **BP-4210-30LS**

(Dial Glass not  
pictured)

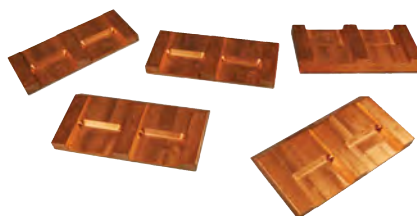
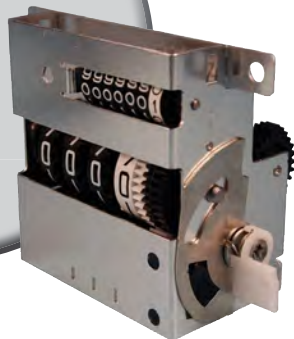

**BP-4210-07-5**

Vanes (5-pack)  
Series 20-26  
(OEM # 067061) (x5)



**BP-4211-07**

Vane - 60 Series  
(OEM # 067018)

Seal Kits, Repair Kits, Rotors, Vanes, Meter parts and **many more products** for Gasboy consumer series models are **ready-to-ship**.  
Check out our "Repair Parts for Gasboy" Catalog!

## Repair Parts for Fill-Rite Pumps

SVI also offers a selection of repair parts for Fill-Rite Pumps! Call Today: 800-321-8173



## Gaskets and Kits for use on Gilbarco Meters and Pump / Air Separator

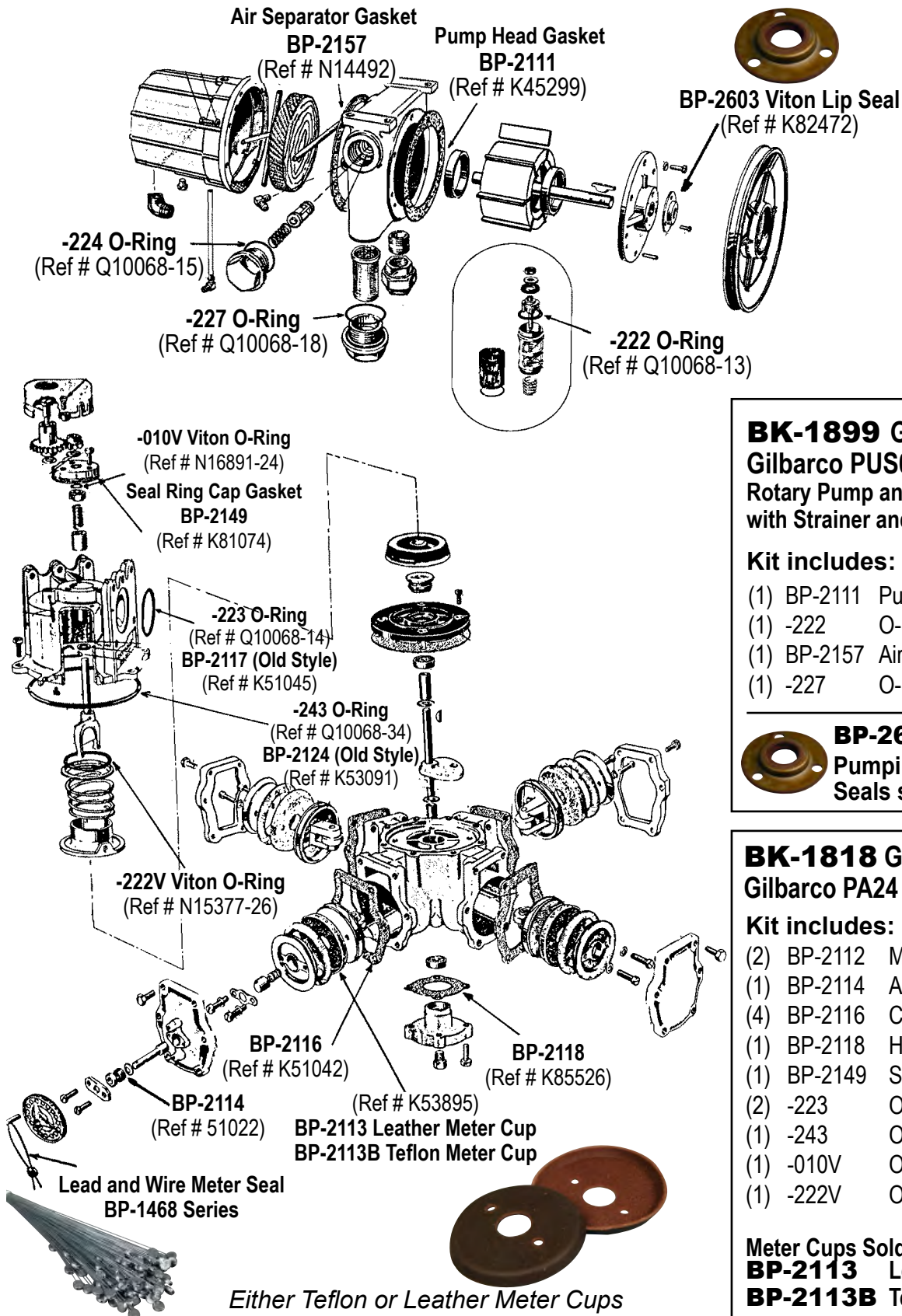

### **BK-1899 Gasket Set for Gilbarco PUS010-01,-03,-05 Rotary Pump and Air Separator with Strainer and Check Valve**

#### **Kit includes:**

- (1) BP-2111 Pump Head Gasket
- (1) -222 O-Ring
- (1) BP-2157 Air Separator Gasket
- (1) -227 O-Ring



**BP-2603** (ref K82472)  
**Pumping Unit Viton Lip  
Seals sold separately**

### **BK-1818 Gas-Kit Set for Gilbarco PA24 Standard Meter**

#### **Kit includes:**

- (2) BP-2112 Meter Stem Seal
- (1) BP-2114 Adj. Screw Packing
- (4) BP-2116 Cyl. Cover Gasket
- (1) BP-2118 Housing Gasket
- (1) BP-2149 Seal Ring Cap Gasket
- (2) -223 O-Ring
- (1) -243 O-Ring
- (1) -010V O-Ring
- (1) -222V O-Ring

**Meter Cups Sold Separately:**  
**BP-2113** Leather Meter Cups  
**BP-2113B** Teflon Meter Cups

## Quad Ring Kit for Gilbarco Advantage Meter

**DIRECTFIT™**  
SVI's DIRECT FIT™ BRAND



The SVI new product development team in conjunction with the engineering department and distributor driven input continually works for you to find more cost-saving products and solutions.



The kit pictured to the left is for use on Gilbarco Advantage Meters. It is equal to the K35222 kit less the alignment tools.

We offer this kit in two versions, one for moderate climate environments and one for extremely cold climates where quad ring hardness can become an issue.

LT = Low Temperature

SVI Part No.	For	OExref	Rebuild Kit Description	Effective Cold Hardness Range
BP-2159-01	Gilbarco	K35222	Quad Ring Kit w/Gaskets (10 ea in kit)	-15° F
BP-2159-01LT	Gilbarco	K35222x	Quad Ring Kit w/Gaskets (10 ea in kit)	-40° F & C

## Updated Rebuild Kits for Old and New Style Gilbarco Advantage Meters

In 2010, the SVI new product development team, in conjunction with the engineering department and distributor driven input introduced new and more complete kits for rebuilding Gilbarco meters.

The kits pictured are for use on Gilbarco Advantage Meters. Each kit comes complete and is supplied with both the old style and new style top shaft seal and gasket. You can also choose which type of formed piston cup material you need—leather or teflon.

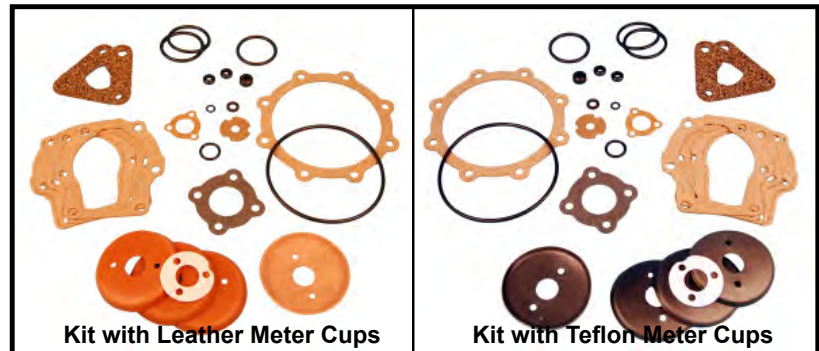

SVI's selection of repair/rebuild parts for gas pumps and meters has been growing and we welcome your business and suggestions for what kits and parts we should put on the development schedule.

SVI Part No.	For	Rebuild Kit Description
BP-2159-10L	Gilbarco	Meter Rebuild Kit (with leather cups)
BP-2159-10T	Gilbarco	Meter Rebuild Kit (with teflon cups)

**SVI also stocks formed Rulon Meter Cups for Gilbarco Meters**

**BP-2115R** (Ref N21252) • **BP-2115R-PK** (Ref K96659-01) for 35-Pack



SVI Part No.	For	Ref #	Rebuild Kit Description
BP-2158-11	Gilbarco	K35359x	Gasket and O-Ring Kit
BP-2158-11S	Gilbarco	K35359	Gasket and O-Ring Kit with Square Ring

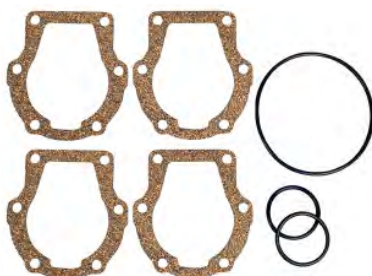



## Blade / Vane Kits for Gilbarco

*For use in Highline, Trimline and Legacy Pumps produced after 1987*

DIRECT FIT™ BRAND REPAIR PARTS AND SOLUTIONS

*SVI is a premier and well-known supplier of parts for Gilbarco Fuel Pumps and other Petroleum Equipment.*

SVI's **BP-2159-76 Blade / Vane Kit with Shaft Seal and Gasket** is a Direct Fit™ replacement for Gilbarco's K35212 for use in the Gilbarco Highline, Trimline and Legacy pumps produced after 1987.

SVI has specialized in service and repair parts for petroleum equipment since 1977 through supporting equipment manufactured by many companies including that of the Gilbarco Company. Gaskets, seals and parts for petroleum pumping and metering equipment have been available from SVI for decades. In addition to complete kits, SVI also offers components individually. New products are being added every day—let SVI know what you would like to see available.

SVI continues on supporting all existing and new Gilbarco pumps and automotive lifts. In 2011, SVI purchased what was formerly known as the Gilbarco Automotive Lift Division from Gilbarco's contract lift manufacturer in Manitowoc, WI called Consumers Inc. The home for the former Gilbarco lift company is now contained under the SVI umbrella. ***For repair parts for petroleum equipment and automotive lifts, SVI is your answer!***

### PUS020 Replacement Blade / Vane Kit

These vane pumps are used in single product, single hose or two product, two hose pumps with 1/3 horsepower electric motors. Normally the pumps feature a 3/4" NPT threaded outlet but can be ordered optionally with either a 1" NPT threaded outlet or two bolt flange outlet. These Gilbarco vane pumps with a numbering series that begins with PUS020 are very popular and easy to service to keep running reliably day in and day out.

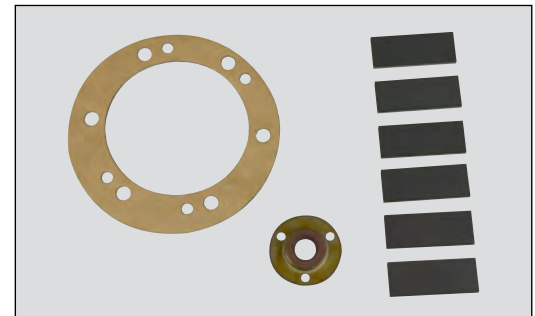

**Blade / Vane Kit with Shaft Seal and Gasket  
BP-2159-76 (ref K35212)**

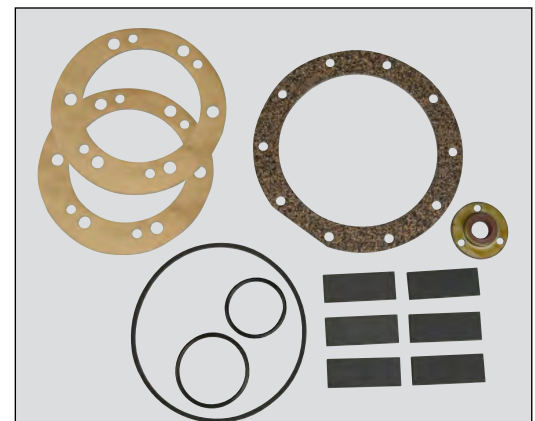

**Blade / Vane Kit with Shaft Seal and Gaskets  
BP-2159-76E (ref K35212x)**

SVI Part #	For:	xRef	Description
<b>BP-2159-75</b>	Gilbarco	K76657	Carbon Blade 15/16" x 2-3/8" x 3/16"
<b>BP-2159-76</b>	Gilbarco	K35212	Blade/Vane Kit with Shaft Seal and Gasket
<b>BP-2159-76E</b>	Gilbarco	K35212x	Blade/Vane Kit with Shaft Seal and Gaskets
<b>BP-2159-79</b>	Gilbarco	Q10068-15	2" OD O-Ring Seal - Viton
<b>BP-2159-80</b>	Gilbarco	Q10068-18	2-3/8" OD O-Ring Seal - Viton
<b>BP-2159-82</b>	Gilbarco	Q12508-156	Blade/Vane Housing Gasket
<b>BP-2157</b>	Gilbarco	N14492	Air Separator Gasket
<b>BP-2603</b>	Gilbarco	K82472	5/8" Pump Unit Seal-Viton

# Gaskets and Kits for use in A.O. Smith (Geosource) Meters

**DIRECTFIT™**  
SVI's DIRECT FIT™ BRAND

Call SVI Today for  
Lead Wire Seals or  
Aluminum Wire Seals



*Either Teflon or Leather Meter  
Cups Can be Used in Any Meter*

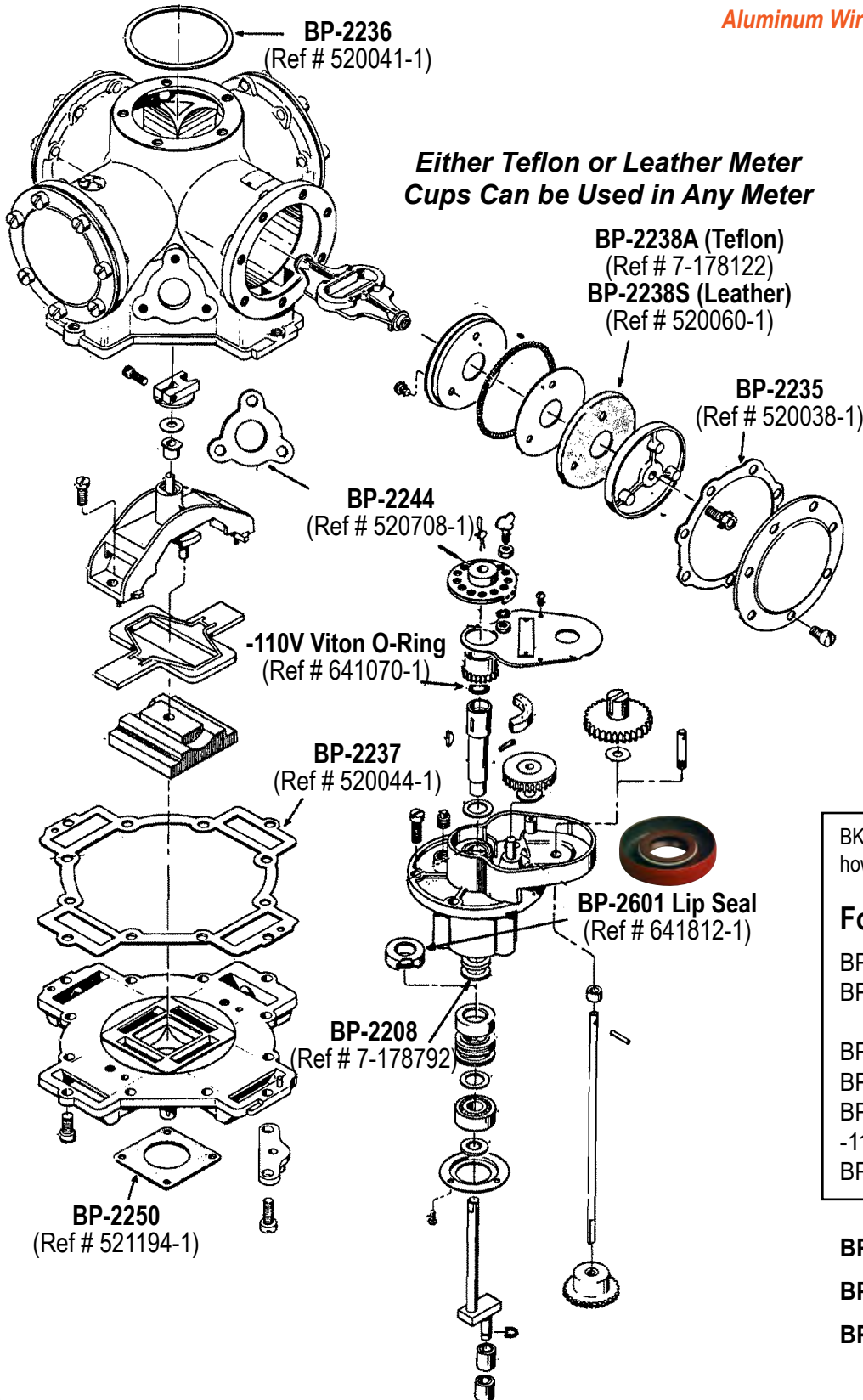

BK-1844 Kit is no longer available,  
however some of it's parts are available:

## For PM-2 Meter:

BP-2208 Smith-Erie: Felt Washer  
BP-2235 Smith-Erie End Cap  
Gasket (uses 4)  
BP-2236 Meter Adj. Cap Gasket  
BP-2237 Meter Base Gasket  
BP-2250 Flange Gasket  
-110V O-Ring  
BP-2244 Valve Cap Gasket

**BP-2601** Meter Lip Seal



**BP-2238A** Teflon Meter Cup

**BP-2238S** Meter Cup

## Gaskets and Kits for use in Southwest Meters and Pumping Units



### **BK-1853 Gasket Set for Southwest E-400-B Meter**

#### **Kit includes:**

- (1) BP-2265 Meter Valve Seat Gasket
- (1) BP-2266 Manifold Gasket
- (1) BP-2274 Dome Gasket
- (3) -012V Viton O-Rings
- (1) -010V Viton O-Ring

#### **Sold Separately:**

- BP-2264T** Teflon Meter Cups  
(Meter Cups not included in Kit)

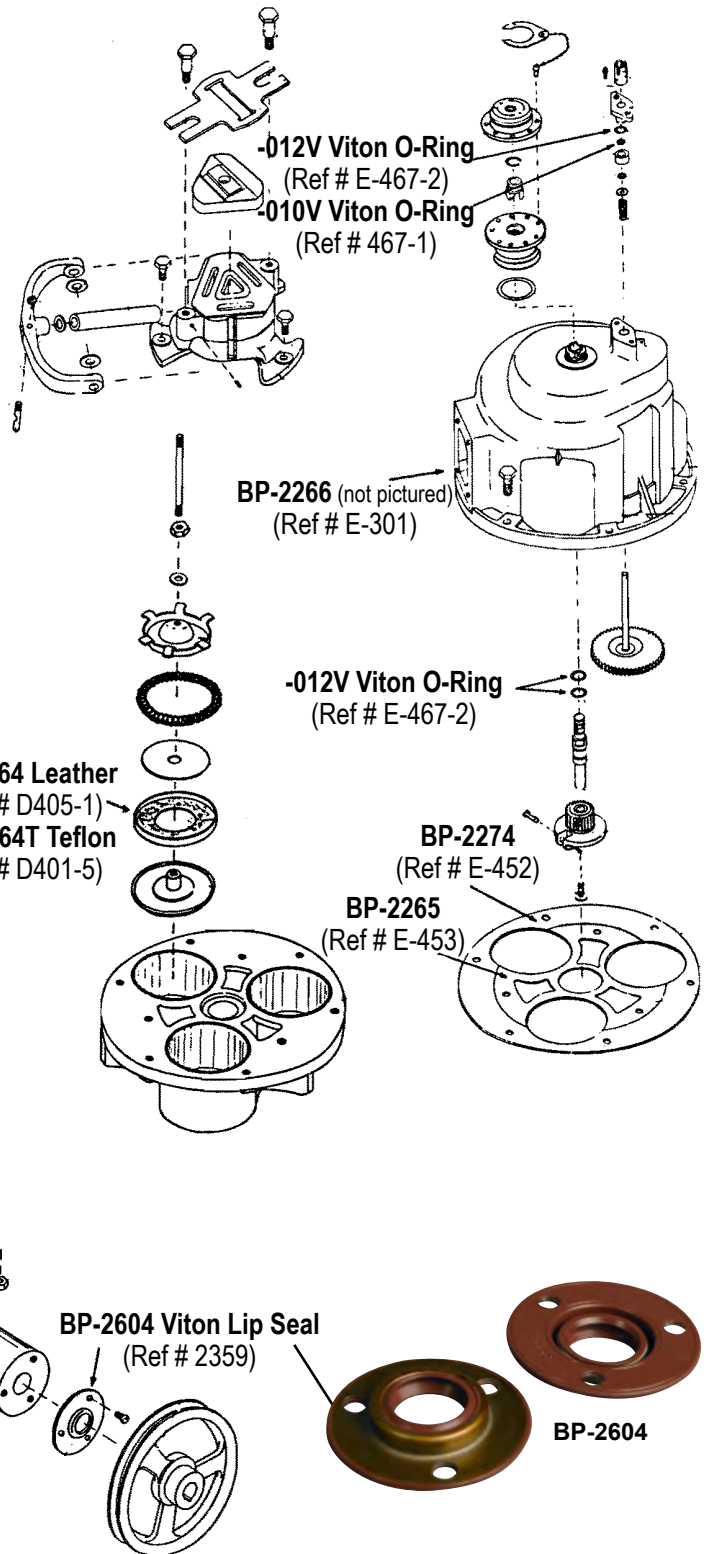

### **BK-1856 Gasket Kit for use in 25LV-E and 35LV Pumping Units**

#### **Kit includes:**

- (1) BP-2178 Mounting Pump Gasket
- (1) -237 O-Ring
- (1) BP-2433 Pump Shaft Gasket

**BP-2604 Viton Lip Seals** not included in Kit.  
Please order separately.



## Gaskets and Kits for use on Tokheim Meters

### BK-1900 Gasket Kit for Tokheim 898K Meter

#### Kit Includes:

Qty	SVI #	OEM Ref	Description
(1)	BP-2346	1-38083	Meter Body Gasket
(1)	BP-2347	1-38082	Meter Body Gasket
(1)			-110 O-Ring
(2)			-112 O-Rings
(1)	BP-4061	1-125359	Meter Drive Shaft Seal
(1)	BP-4061/63		Seal
(2)	BP-4063	1-125360	Meter Seal



BK-1900V Viton Kits also available. These include Viton O-Rings.

### BK-1861 Gasket Set for Tokheim 400 & 400A Older Style Meters

#### Kit Includes:

Qty	SVI #	OEM Ref	Description
(1)	BP-2346	1-38083	Meter Body Gasket
(1)	BP-2347	1-38082	Meter Body Gasket
(4)	BP-2345	1-216956	Drive Shaft Vee
(2)	BP-2280	1-18420	Packing Ring
(2)	BP-2293		Flange Gasket

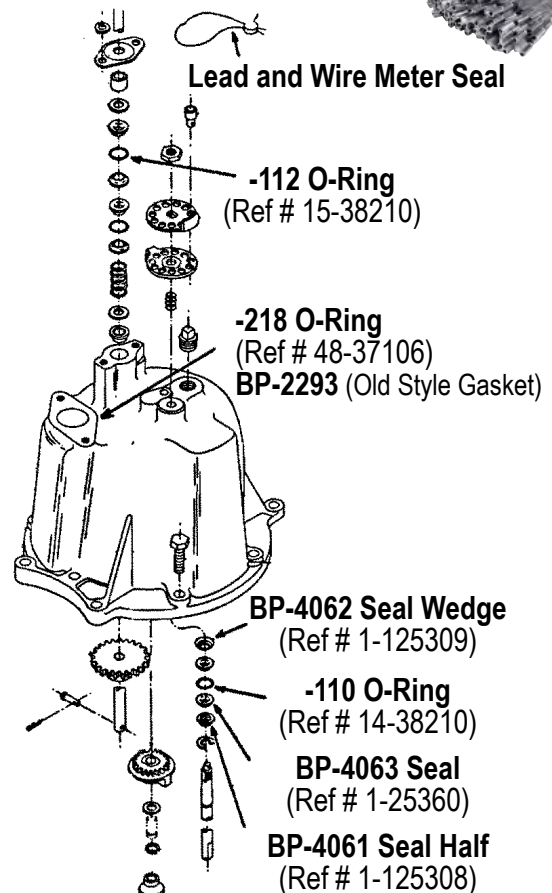

**BP-4071 Teflon Meter Cups**  
Not Included (requires 3)

### GASKETS NOT PICTURED

SVI #	OEM #	Description
BP-2280	1-18420	Adjusting Screw Packing Ring
BP-2345	1-216956	Meter Drive Shaft Vee
-218 O-Ring	48-37106	Flange Seal (Replaces BP-2293)

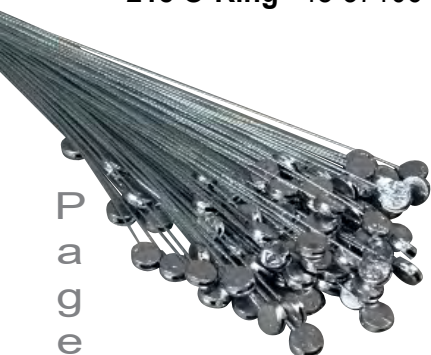

**Call SVI Today for  
Lead Wire Seals or  
Aluminum Wire Seals**

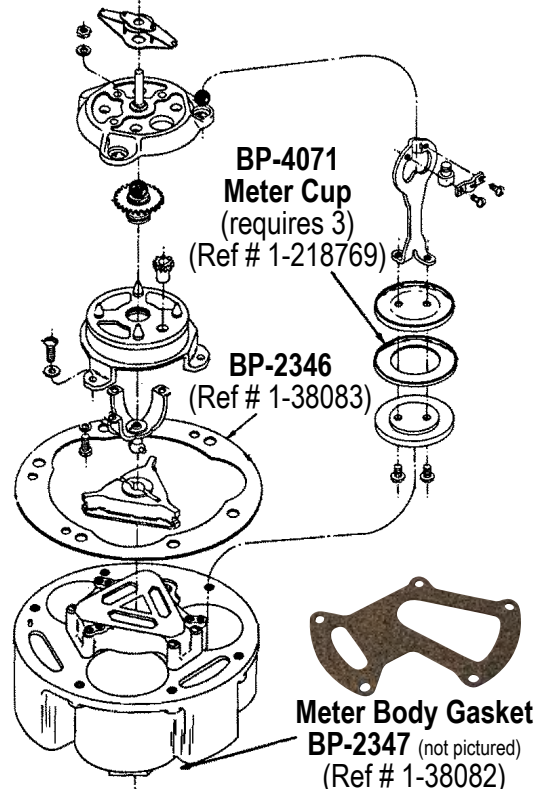

## Gaskets and Kits for use on Tokheim Rotary Pump and Air Separator

### BK-1901 Gas-Kit Set for Tokheim Pump

(For: 855-BB,CC,DD Rotary Pump and Air Separator (Models 162, 162-1, 1248A, 1250A))

#### Kit includes:

Qty	SVI #	OEM Ref	Description	Qty	SVI #	OEM Ref	Description
(1)	BP-2276	1-17526	Pump Head Gasket	(1)	BP-2296	1-113691	Cover Gasket
(2)	BP-2278	1-18792	Valve Cylinder Gasket	(1)	BP-2297	1-113819	Oil Well Felt
(1)	BP-2282	1-18961	Float Valve Gasket	(3)	BP-2311	1-121394	Pump Shaft Vee
(1)	BP-2306	1-25879	Bottom Head Gasket	(1)	BP-2352	13-313235	Inlet Gasket
(1)	OB-70-011	35-37106	-011 O-Ring	(2)	BP-4070	7-163502	Piston Cup
(1)	OB-70-218	48-37106	-218 O-Ring				

**Viton Style Gasket kits are also available!—Order BK-1901V**

*Viton kits include Viton O-Rings in place of the standard Buna N.*

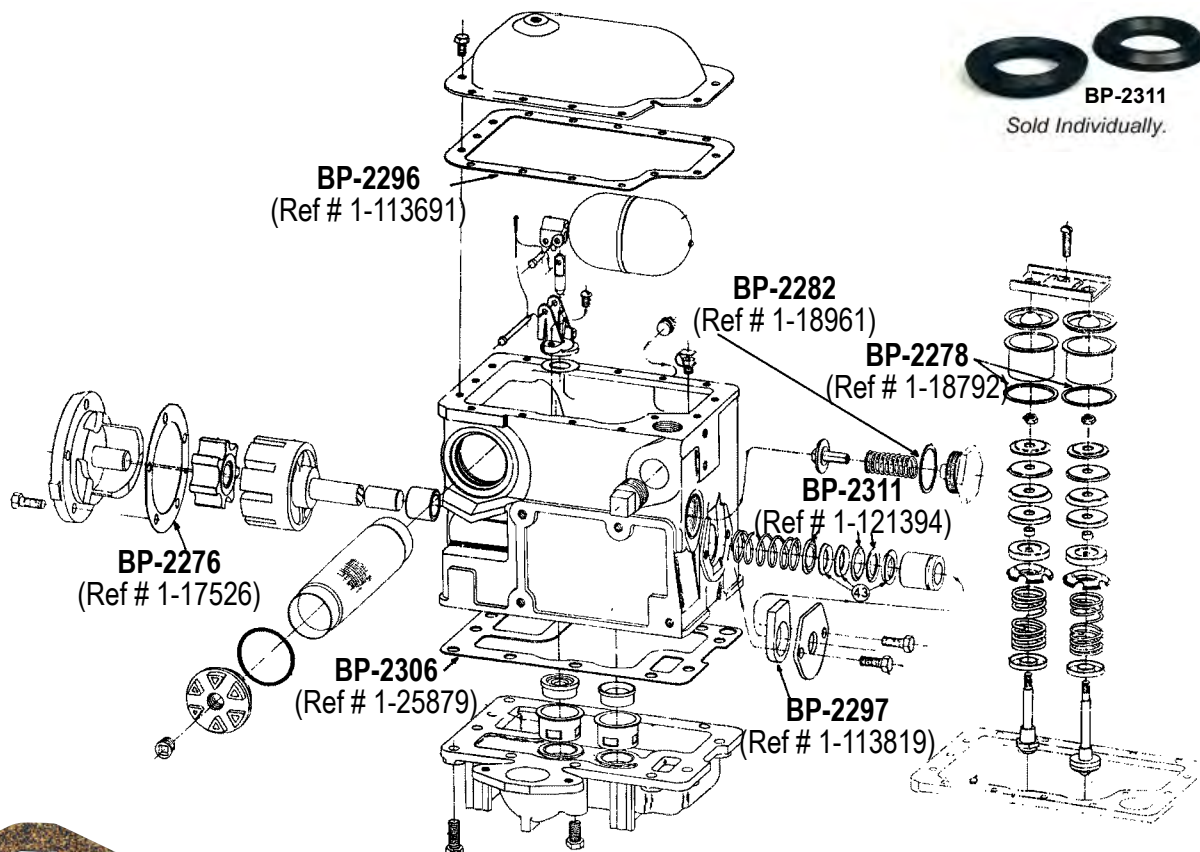

**Pump Inlet  
Gasket for  
Tokheim  
BP-2352**

(Ref 1-217902)

### GASKETS NOT PICTURED

SVI #	OEM #	Description
BP-2352	1-217902	Pump Inlet Gasket
-218 O-Ring	48-37106	Flange Seal (Replaces BP-2293)
-011 O-Ring	35-37106	Pilot Valve Stem O-Ring
BP-4070	218768-1	Regulator Valve Plunger Disc

**DIRECTFIT™**

## Gaskets and Kits for Use on Tokheim Hand Pumps

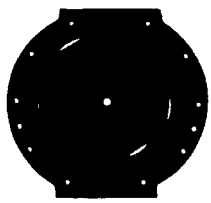

**BP-1579 Diaphragm**  
(Ref # 122311-1 set of 2)



**BP-1581**  
(Ref # 1-404690)



**BP-1582**  
(Ref # 1-122131)



**BP-1584**



**BP-1586A**  
(Ref # 1-215175)



### **BK-1571 Gas-Kit Set for Tokheim 588, 688, 698 Series Hand Pumps**

Kit includes:

- (1) **BP-1579** Diaphragms (set of 2)
- (2) **BP-1583** Shaft Packing
- (1) **BP-1584** Adapter Gasket
- (4) **BP-1586A** Cork Valve Gaskets



### **BK-1573 Gas-Kit Set for Tokheim for 964 Old Style Pump**

Kit includes:

- (1) **BP-1579** Diaphragms (set of 2)
- (2) **BP-1583** Shaft Packing
- (2) **BP-1582** Outlet Body Gaskets
- (1) **BP-1584** Adapter Gasket
- (0) **BP-1581** Body Gaskets (not included)

### **BK-1819 Gas-Kit Set for Tokheim 786, 798, 788 Diaphragm Series Double Acting Hand Pumps**

Kit includes:

- (1) **BP-4127** Gasket (Ref # 1-21867)
- (1) **BP-4128** Diaphragm (Ref # 1-223889)
- (1) **BP-4131** Gasket (Ref # 122-311105)

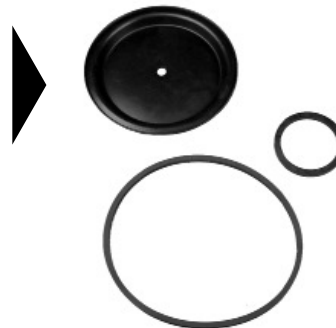

**BP-4128**  
**Diaphragm**  
for Tokheim 786, 787, 788  
(Ref # 1-223889)

## Commonly Requested Parts for Tokheim



**Reset Switch for Tokheim & Bennett BP-4101**



**Motor Switch for Tokheim BP-4104**



**Piston Cup for Tokheim BP-4129**  
(Ref 1-223892)



# Gaskets and Kits for use on Wayne Meters and Pumps

Call SVI Today for Seal Press  
Crimper and Wire Meter Seals  
Available in Aluminum or Lead!

## BK-1875

### Gas-Kit Set for Wayne 2 PM-2,3,4,5 Meters

#### Kit includes:

- (2) -114V O-Rings
- (1) -208V O-Ring
- (1) -227 O-Ring
- (1) -217 O-Ring
- (1) -248 O-Ring
- (2) -006V O-Rings
- (2) -340 O-Rings

## BK-1903 Gas-Kit for Wayne 760 Pumping Unit

(not pictured)

#### Kit includes:

- (1) -237 O-Ring
- (2) BP-2432 Gaskets
- (1) -270 O-Ring

## BK-1903V Viton Kit

- (1) -237V O-Ring
- (2) BP-2432 Gaskets
- (1) -270V O-Ring

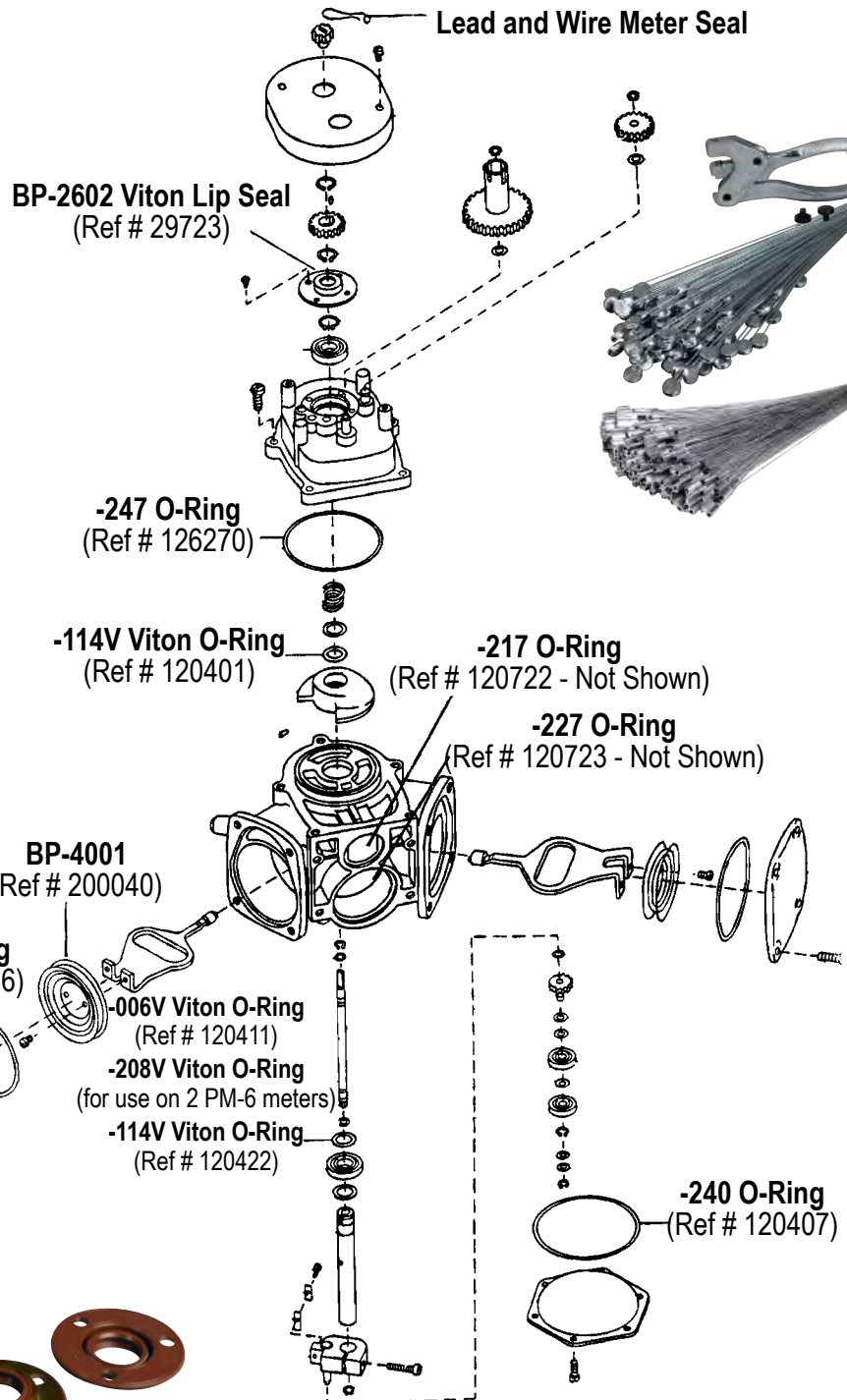

**BP-2602** Viton Meter Lip Seal and  
**BP-4001** Piston Cups are  
**not** included in BK-1875 Kit.  
**Please order separately.**

**BP-2604** Viton Pumping Unit Seals  
are also available.



To repair 2 PM-6 meters order  
**BP-2466** Viton Block Vee in  
addition to **BK-1875** Kit.

## Gaskets and O-Rings not pictured:

SVI #	OEM #	Description
-237V	118864	Pump Head O-ring
BP-2432	118869	Strainer Gasket
-270V	126874	Compact Pump Unit O-ring



## Gaskets and Kits for use on Wayne Meters and Pumps

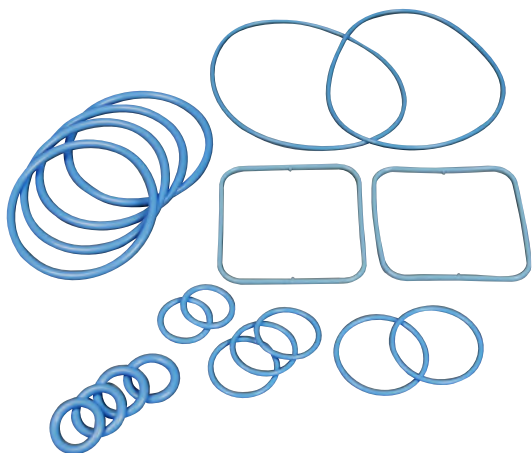

**O-Ring Kit for Wayne  
I-Meter Complete**  
*Blue Fluorosilicone (BFS)*  
**BP-2458-10SK**  
(Ref 80100)



## Underground Storage Tank Accessories

### GAUGING PASTE

#### **BP-4106G Gasoline Gauging Paste**

Gasoline Gauging Paste is light pink in color. It changes to a contrast of red upon contact with gasoline, naphtha, kerosene, gas oil, crude oil, jet fuels and various chemicals, etc. Just spread a small amount on the gauge stick where liquid level is expected and gauge as usual.

**2.25 ounces - Sold Individually or by the Case (12)**

#### **BP-4106P Water Finding Paste**

Water Finding Paste has been designed to determine the water level in gasoline, petroleum, and other tanks. When applied on the lower surface of the gauge stick, a red color will clearly show the water level in the tank. Use for accurate inventory of any liquid which floats on water. Works equally well in kerosene, oils (a few seconds longer will be required for heavy and dark oils), soap solutions, chlorides, ammonia, and most acids.

**3 ounces - Sold Individually or by the Case (12)**

#### **BP-4106M-3 Modified Water Finding Paste**

Modified Water Finding Paste is formulated for determining water levels in alcohol fuel blends. Modified Water Finding Paste turns from dark brown in color to bright red on contact with water.

Phase separated alcohol solutions with as little as 6% water will turn the paste yellow.

This product is designed for use in oxygenated fuel systems. Alcohol or de-icing agents in fuels have very little effect on the performance of the product. BP-4106M-3 meets Military Specification number MIL-W-B2779.

**2.5 ounces - Sold Individually or by the Case (12)**





# DIRECT FIT™ BRAND

## SVI International, Inc.

Catalogs and Information Online: [www.sviinternational.com](http://www.sviinternational.com)

### AUTO LIFT REPAIR PARTS FOR ALL MAKES & MODELS

~NO MATTER THE AGE OF THE LIFT!

- Arm Restraint Kits & Parts
- Cables—Lifting and Equalizing
- Chain
- doorjammerPRO - Door Protection Pad
- Height Extensions and Rubber Pads
- Installation Products & Tools
- Power Units and Parts
- Pulleys and Chain Rollers
- Seal Kits for In-Ground & Surface Mount
- Safety Legs / Non-Rotators
- Replacement Lift Kits
- Power Post Lifting Systems
- Tanks for In-Ground Lifts
- Turf Attachments for 2-Post Lifts

### SURFACE MOUNT LIFT PARTS FOR:

Acanus	Gemini	Quality
Ammco®*	Gilbarco	Ranger
Alamo /	Globe	Ravaglioli
ASSSA	Grand	Rotary Lifts
ALM	Hofmann	Silent Tech
AMI	Hydralift	Slift
Ashawa	Ime Istobal	Somers Souriau
Ben Pearson	Kismet	Stenhoj
BendPak	Kimm	Stertil Koni
Benwil	Koni	Sun
Bishamon	Launch	Tecalemit
Boston	Laycock	Titan
Bradbury	Lincoln	Weaver
Cascos	Maha	Werther
Consul	Manitowoc Lifts	Western
Challenger	Mohawk	Westinghouse
Force	Nussbaum	Wheeltronic
Ford Smith	OMA	Worth
Forward	OMCN	Zippo
Fuchs / Zippo	PMW	

### IN-GROUND LIFT PARTS FOR:

Benwil	Gilbarco	PKS Lifts
Challenger	Globe	Rotary
Cochin	HDL/ISS Innovative	US Hoist
Curtis	Joyce	Weaver
Ford Smith	Manitowoc Lifts	Western

### AIR COMPRESSOR PARTS

- Air Receiver Tanks • Compressor Mufflers
- Automatic Tank Drain Valve for Champion Compressors
- Filters—Many OEM Ref Available!
- Filters, Regulators, Lubricators
- Intake Filter Products
- Milton Air System Products
- Re-Coil Hose • Valves
- Vibration Dampening Pads & much more!

### BRAKE LATHES REPAIR PARTS

- Brake Lathe Repair Parts and Accessories for All Makes 

### EXHAUST REMOVAL SYSTEMS & PRODUCTS

### FLUID DELIVERY

- Lenz Fittings
- Steel Hydraulic Line Tubing and Fittings
- Strut and Hangers

### HOSE REELS BY REELCRAFT®

### HYDRAULIC CYLINDERS—

- Custom Single-Acting Large Bore Cylinders
- Also see "Lifting Equipment"

### LIFTING EQUIPMENT

- New In-Ground Lifts—Car, Truck & Bus
- Small Equipment Shop Maintenance (SESM) Lifts for lifting Landscape Equip. ATVs / UTVs, Motorcycles, Lawn Mowers, Golf Carts and More!
- Custom Lifting Equipment incl. Production Line Lifts, Rail Car Lifts and More
- Custom Hydraulic Cylinders for Various Applications
- Turf Attachments for 2-Post Lifts
- In-Ground Lift Sections and Kits
- And more!

EASY TO ORDER:

**800-321-8173**

**815-748-0200**

Fax: 800-899-1784 • 815-748-0210

E-Mail: [parts@sviintl.com](mailto:parts@sviintl.com)

[www.sviinternational.com](http://www.sviinternational.com)

### LUBRICATION & PAINT / FOAM SPRAY REPAIR PARTS & KITS FOR:

- Alemite • ARO • Balcrank • Graco • Lincoln

### PETROLEUM EQUIPMENT & REPAIR PARTS FOR:

- Gas Pump & Meter Kits and Parts for Gasboy • Tokheim • Fill-Rite
- Including Parts for Older Pumps: Wayne • Bennett • Gilbarco • Bowser A.O. Smith (Geosource) • Southwest

### SEAL KITS

### SHOP EQUIPMENT

- Hein-Werner Products • Omega Products
- Porto-Power • Pro-Lift

### TIRE EQUIPMENT REPAIR PARTS

- Tire Changer and Wheel Balancer Parts for All Makes

Accu-Turn	FMC	Nussbaum
All Tool	Giuliano	Ranger
Ammco®*	Hofmann	Sicam
BaseLine®*	Hunter	Sice
Bosch	John Bean /	Snap-On
Cemb	(JBC)	Teco
Coats®*	Kwik-Way	Tuxedo
Corgi	Launch	

### VALVES

- Air Compressor Valves of All Types
- Air and Hoist Control Valves
- Ball Valves • Check Valves
- Kingston Valves • Pressure Relief Valves
- Relief Valves • Safety Valves
- Solenoid Valves
- Tire Changer Valves • And More!

### CUSTOM PRODUCTS

And let us know if you want something you use in your shop to be added to our product line!

**DIRECT FIT™**

In addition to SVI's DIRECT FIT™ BRAND, we are proud to be a one-stop shop for many other great products including:



B-Line  
by EATON



and many more!

3 Ready-Ship Warehouses for Faster Shipping! | **BALTIMORE • CHICAGO • LOS ANGELES**

**Main Office:** 155 Harvestore Drive • DeKalb, IL 60115

All names, numbers, symbols and descriptions are used for reference purposes only. It is not implied that any part listed is the product of these manufacturers. 08.04.2021

SVI does not represent and is not associated in any way with any other companies. Entire contents copyright © 2021, SVI International, Inc. Prices subject to change without notice.

\*AMMCO, BASELINE, COATS and DUCKHEAD are registered trademarks of Hennessy Industries, Inc. SVI International, Inc. is not associated in any way with Hennessy Industries, Inc.

**TERMS AND CONDITIONS OF THE  
SALES ORDER  
FOR SVI INTERNATIONAL, INC.**

1. **GENERAL.** The terms and conditions of sales order outlined herein shall apply to the sale by SVI INTERNATIONAL, INC. (hereinafter referred to as "Company") of the items described on the facing page (hereinafter referred to as "Merchandise") to Purchaser.
2. **DELIVERY.** Delivery shall be deemed to be complete when the Merchandise has been shipped F.O.B. Company's plants in DeKalb, Illinois, Montclair, California; and Hanover, Maryland ("Company's plants"). Shipments are subject to delays from causes or contingencies beyond the reasonable control of the Company. When otherwise not specified, shipments will be made in standard containers via carrier which, in the judgment of the Company, will result in the most practical method. Title and right of possession will pass to the Purchaser upon receipt by the carrier at the shipping point. If a customer of the Company should specify a specific carrier's method of shipment (i.e. UPS Next Day Air) and that carrier does not perform to the customer's expectations, freight credit to a customer's account will not be issued unless the Company can first obtain a credit.
3. **RISK OF LOSS.** Identification of the Merchandise under Uniform Commercial Code (hereinafter referred to as "UCC") Section 2-501 shall take place at the moment of shipment F.O.B. Company's plants. Risk of loss shall pass to the Purchaser when the Merchandise is shipped from the Company's plants.
4. **TITLE.** Title to the merchandise shall transfer to the Purchaser when the Merchandise is shipped from the Company's plants.
5. **WARRANTIES.** The Company guarantees its products to be free from defects in workmanship and raw materials for a period of one year from date of purchase. THIS WARRANTY IS EXPRESSLY IN LIEU OF ANY AND ALL WARRANTIES EXPRESS OR IMPLIED. COMPANY DOES NOT WARRANT THE MERCHANDISE IS MERCHANTABLE OR FIT FOR ANY PARTICULAR PURPOSE. Company's liability for breach of the terms of this Agreement, including any warranty, is limited to either refund of the invoice price of the Merchandise or at Company's option, replacement of the Merchandise free of charge, including transportation charges but not including the cost of labor. Purchaser has not relied on any statement or upon the conduct of Company with respect to the prospective use of the merchandise. Company shall not be liable for and Purchaser waives any and all claims for any loss or damage, directly or indirectly, arising from the use of the Merchandise and for punitive, incidental or consequential damages, including, but not limited to, damages to property, for loss of use, loss of time, loss of profit or loss of income. The Company does not authorize the sale of our products under any other warranty, expressed or implied. **Please note:** Electrical components and cylinder or shaft seals are not covered under warranty.
6. **SETOFF.** All claims for money due or to become due from the Company shall be subject to deduction by the Company for any setoff or counterclaim arising out of this or any other claims of the Company or its affiliated companies, whether such setoff or counterclaim arose before or after any assignment by Purchaser.
7. **INDEMNIFICATION.** Purchaser agrees to indemnify the Company and hold it harmless from and against all claims, liability, loss, damage or expense, including reasonable counsel fees, arising from or by reason of any modifications or alterations made by Purchaser. If a customer of the Company modifies or alters any part, in any manner whatsoever, or uses any part in departure from recommended performance specifications, said customer agrees to indemnify and hold the Company harmless from and against all liability and expenses based on damage to property or injury to or death of any person arising out of or attributable to such modified or altered part. Further, the Company will not accept any such modified or altered part for credit to a customer's account.
8. **FREIGHT POLICY.** Freight charges are prepaid and added to invoice or collect FOB shipping point. Note: All customers are responsible for all carrier shipping costs, fees, surcharges, etc. including order refusal and return fees.
9. **RETURN POLICY.** To return a part for credit or inspection, Purchaser must first contact our Main Office in Illinois, to obtain a Return Merchandise Form. Once Purchaser has obtained this form, the parts can be returned freight prepaid only. The Return form must be included with the shipment. Parts returned to the Company without the approved form will be returned freight collect to the shipper or refused. Returns must be initiated within 30 days of the invoice date. The Return Forms are valid for 30 days, from the date of issue. All Returns are subject to restocking charges. Return parts brought into our remote warehouses, will not be accepted by our personnel, without a Return Merchandise Form from the Main Office. Parts which have been used in any way or manner, including any installation or incorporation into a lift, hoist, or other equipment, shall NOT be eligible for return whether or not a Return form has been assigned. **Please note:** Electrical parts or components are not returnable for credit. This includes all switches, pushbuttons, relays, electric motors, capacitors, fuses, solenoids, power units with wiring issues or any other electrical items. Custom, built to order, special order, and non-stocked genuine parts are non-returnable.
10. **RESTOCK CHARGE.** Returns are subject to a restocking charge. Refusals are subject to the same restocking charge plus the cost of outbound and return freight charges and/or fees incurred by the Company due to shipment refusal.
11. **PRICES AND PAYMENTS.** All prices are subject to change without notice. All prices are F.O.B. shipping point. The Company standard terms are net 30 days, C.O.D. company check, C.O.D. cash, VISA, MasterCard, Discover or American Express. However, if in the judgment of the Company, the financial condition of the Purchaser at any time does not justify shipment according to standard terms of payment, the Company may require full or partial payment in advance.
12. **INTERPRETATION.** This sales order is intended by the parties as a complete and exclusive statement of the terms of their agreement. It supersedes all prior agreements, written or oral. No course of prior dealings between the parties and no usage of the trade shall be relevant to supplement or explain any terms used in this sales order. Acceptance or acquiescence in a course of performance rendered under this purchase order shall not be relevant to determine the meaning of this sales order even though the accepting or acquiescing party has knowledge of the nature of the performance and opportunity for objection. Whenever a term defined by the UCC is used in this sales order the definition contained in the UCC shall control.
13. **MODIFICATION.** This sales order can be modified or rescinded only by a writing signed by both parties.
14. **WAIVER.** No claim or right arising out of a breach of this sales order can be discharged in whole or in part by a waiver or renunciation of the claim or right unless such waiver or renunciation is supported by consideration and is in writing signed by the aggrieved party.
15. **ASSIGNMENT.** No right or interest in this sales order shall be assigned by either party without the written consent of the other and no delegation of any obligation owed, or of the performance of any obligation by either the Company or Purchaser shall be made without the written consent of the other party. Any attempted assignment or delegation not made in conformity with this paragraph shall be wholly void and totally ineffective for all purposes.
16. **TIME TO PERFORM AND BRING ACTION.** Time is of the essence of this sales order. Any action for breach of this sales order shall be commenced within two (2) years after the cause of action has accrued. Any party who loses any litigation shall reimburse the other party for costs including reasonable attorney's fees. The exclusive jurisdiction for any legal action shall be the Circuit Court of DeKalb County, Illinois.
17. **APPLICABLE LAW.** This sales order shall be governed by the UCC of Illinois as effective and in force on the date of this sales order.



BALTIMORE • CHICAGO • LOS ANGELES



- Air Compressor and Air System Products
- Auto Lift Parts for Any Make or Model
- Auto Lift Cables and Chain
- Auto Lift Power Units and Parts
- Auto Lift Sheaves / Pulleys and Chain Rollers
- Brake Lathe Repair Parts for All Makes
- EV Electric Vehicle Charger Retractor Clamps
- Exhaust System Products
- Fluid Delivery Repair Parts
- Hose Reels and Hose Stops
- In-Ground Auto Lifts
- Lubrication Equipment Repair Parts
- Petroleum / Service Station Pump and Tank Products
- Repair Parts for Gasboy Consumer Series
- SESM Lifts for ATVs, UTVs, Golf Carts and More!
- Tire Changer Repair Parts
- Turf Attachments for 2-Post Lifts
- Vehicle Lifting Systems
- Wheel Balancer Accessories



## SVI International, Inc.

155 Harvestore Drive • DeKalb, IL 60115

**800-321-8173 • 815-748-0200**

Fax: 800-899-1784 • 815-748-0210

Entire contents copyright © 2021, SVI International, Inc.

Information and Catalogs Online:  
**[www.sviinternational.com](http://www.sviinternational.com)**