



In-Ground Lift Equalizer

Assemblies and Parts

DIRECTFIT™

Automotive Shop Equipment | Auto Lift Repair Parts

The Industry's Largest Selection of Auto Lift Repair Parts

For All Two Post
Side by Side
In-Ground Lifts

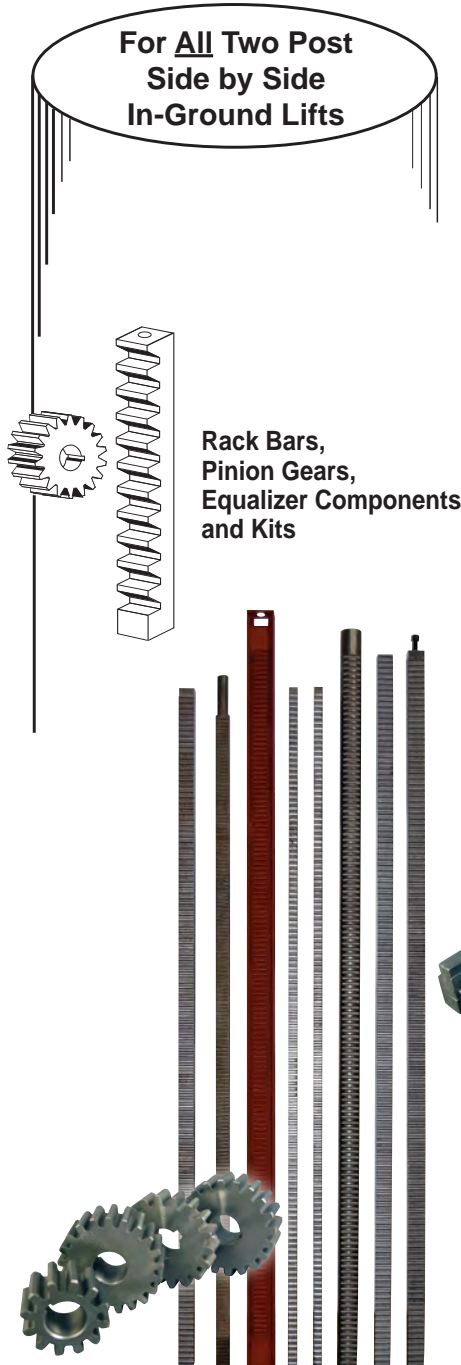

**Rack Bars,
Pinion Gears,
Equalizer Components
and Kits**

Rack Bar Identification by Dimensions

Width	Depth	Features	SVI Rack Bar Part # Plus the Lift Manufacturer
1-3/4"	x	1-3/4"	BH-9012 for Benwil Lifts
1-1/2"	x	1-1/2"	BH-9110 for Cochin Lifts
1-1/2"	x	1-1/2"	BH-9111 for Cochin Lifts
1-1/2"	x	1-1/2"	BH-9210 for Curtis Lifts
3"	x	1-1/2"	BH-9310 for Gilbarco / Manitowoc Lifts
1"	x	2"	BH-9409 for Globe Auto Lock
1"	x	2"	BH-9410 for Globe Manual Lock
2-1/2" Diameter		Round	BH-9610 for Joyce / Weaver
1-3/4"	x	1-1/4"	BH-9611 for Weaver
1-7/8"	x	1-7/8"	BH-9612 for Weaver / Rotary

Pinion Gear Identification by Dimensions

Gear Dimensions		No. of Teeth	SVI Pinion Gear Part # Plus the Lift Manufacturer
Width	Outside Dia.		
1-3/4"	x	4-1/4"	BH-9011 for Benwil Lifts
1-1/2"	x	2-5/8"	BH-9112 for Cochin Lifts
1-1/2"	x	2-5/8"	BH-9211 for Curtis Includes Collar/Lock Screw
1-1/2"	x	3-3/4"	BH-9311 for Gilbarco / Manitowoc Lifts
1"	x	4"	BH-9411 for Globe Lifts
1-1/2"	x	4-1/4"	BH-9613 for Joyce / Weaver / Rotary Lifts
2"	x	4"	BH-9411-Kit with Key for Globe Lifts / ISS / HDL Lifts

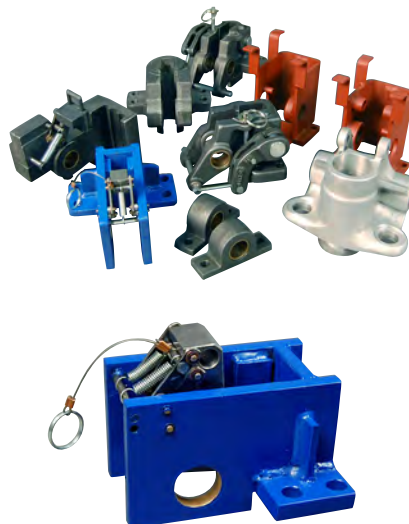

SVI International, Inc.

155 Harvestore Drive • DeKalb, IL 60115

800-321-8173

815-748-0200

www.sviinternational.com

BALTIMORE • CHICAGO • LOS ANGELES

For Benwil Lifts

DIRECTFIT™

SVI Part #	Ref. OEM Part #	Description and Contents
BH-9011	10133912	Pinion Gear
BH-9012	10133472	Rack Bar For Standard or Metric Shaft
BH-9013-77		77" Plunger Center Equalizer Assy. <u>Includes:</u> (1) 10146050 Equalizer Shaft (2) 80840501 Bearing Housings (2) 1-1/2" Snap Rings (2) Keys (2) Pinion Gears <i>Rack Bars Sold Separately</i>
Note: BH-9013-77 has standard (non-metric) shaft and gears.		



BH-9011 (Ref 10133912)
Pinion Gear for Benwil

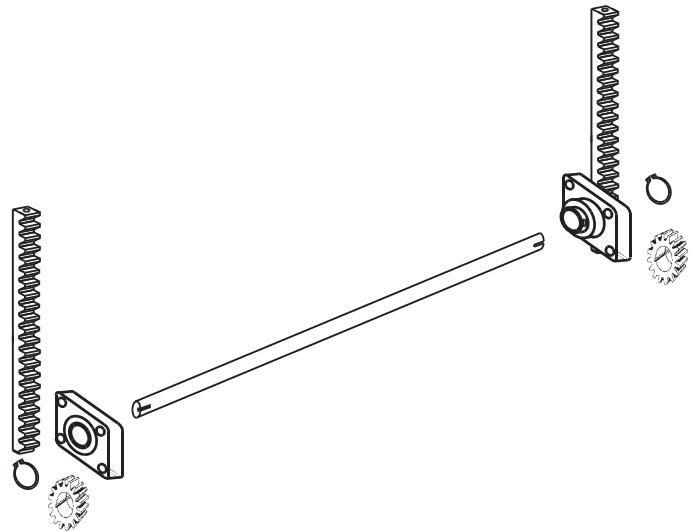

For Cochlin Lifts

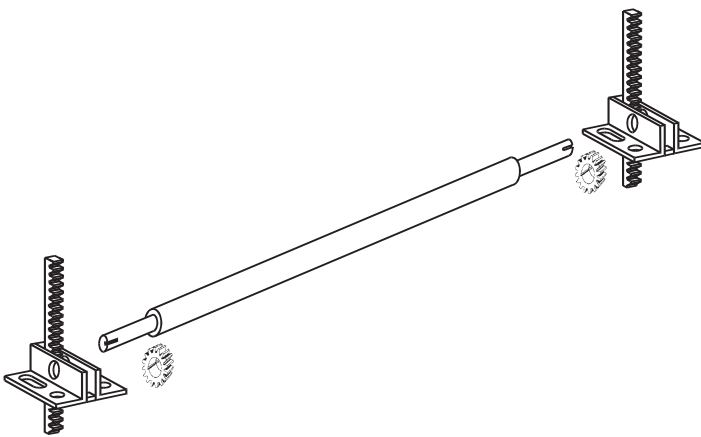

SVI Part #	Ref. OEM Part #	Description and Contents
BH-9112	10025N	Pinion Gear
BH-9110	A-21458	Rack Bar - 72" long
BH-9111	A-21458-84	Rack Bar - 84" long
BH-9113-40 BH-9113-57 BH-9113-85	50000-40 50000-57 50000-85	40" Plunger Center Equalizer Assy. 57" Plunger Center Equalizer Assy. 85" Plunger Center Equalizer Assy. <u>Includes:</u> (1) 40", 57", or 85" Equalizer Shaft (2) A-21459 Equalizer Brackets (4) Lock Collars with Set Screws (2) Keys (2) Pinion Gears
BH-9120-40 BH-9120-57 BH-9120-85	50000-40L 50000-57L 50000-85L	40" P.C. Locking Equalizer Assy. 40" P.C. Locking Equalizer Assy. 40" P.C. Locking Equalizer Assy. <u>Includes:</u> (1) 40", 57", or 85" Equalizer Shaft (1) A-21459 Equalizer Bracket (1) Locking Equalizer Bracket (1) BH-9120-02 Lock Assembly (1) BH-9120-01 Lock Handle (4) Lock Collars with Set Screws (2) Keys (2) Pinion Gears <i>Rack Bars Sold Separately</i>
For Complete Assembly with Rack Bars add "C" to P/N		

For Curtis Lifts

DIRECTFIT™

SVI Part #	Ref. OEM Part #	Description and Contents
BH-9211	A-15116	Pinion Gear
BH-9210	B-15096	Rack Bar with Machined End
BH-9212		Equalizer Assembly <u>Includes:</u> (1) BH-9212-01 Equalizer Shaft (2) BH-9212-05 Equalizer Brackets (2) Keys
<i>Rack Bars and Gears Sold Separate</i>		

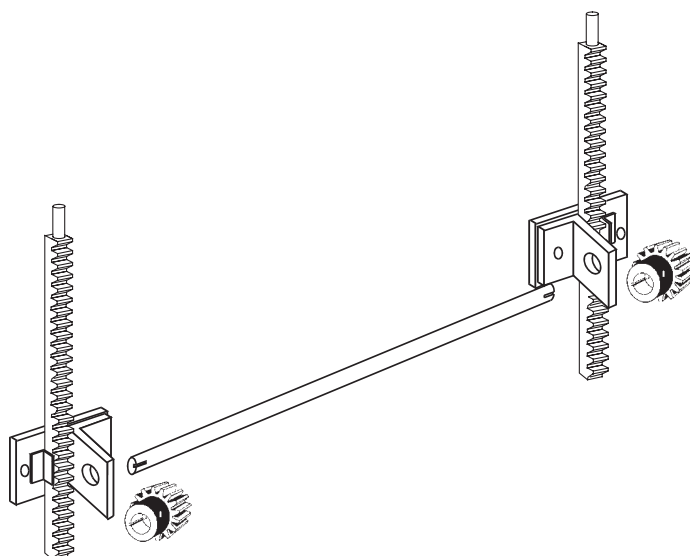

For Gilbarco/Manitowoc Lifts

SVI Part #	Ref. OEM Part #	Description and Contents
BH-9311	K87046	Pinion Gear
BH-9310	N19253	Rack Bar In Channel
BH-9312-40 BH-9312-57 BH-9312-89		40" Plunger Center Equalizer Assy. 57-1/2" Plunger Center Equalizer Assy. 89" Plunger Center Equalizer Assy. <u>Includes:</u> (1) 40", 57", or 89" Equalizer Shaft (1) BH-9314 Left Side Bracket (1) BH-9315 Right Side Bracket (2) Keys (2) Retaining Rings <i>Rack Bars and Gears Sold Separate</i>
BH-9312-40L BH-9312-57L BH-9312-89L		40" P.C. Locking Equalizer Assy. 57-1/2" P.C. Locking Equalizer Assy. 89" P.C. Locking Equalizer Assy. <u>Includes:</u> (1) BH-9313-23 Lock Latch (1) BH-9313-25 Lock Spring (1) BH-9313-24 Latch Shaft (1) BH-9313-26 Set Screw (1) BH-9313-21 Latch Handle (1) 40", 57", or 89" Equalizer Shaft (1) BH-9314 Left Side Bracket (1) BH-9315 Right Side Bracket (2) Keys (2) Retaining Rings and hardware <i>Rack Bars and Gears Sold Separate</i>
For Complete Assembly with Rack Bars and Gears add "C" to P/N		

P.C. = Plunger Centers

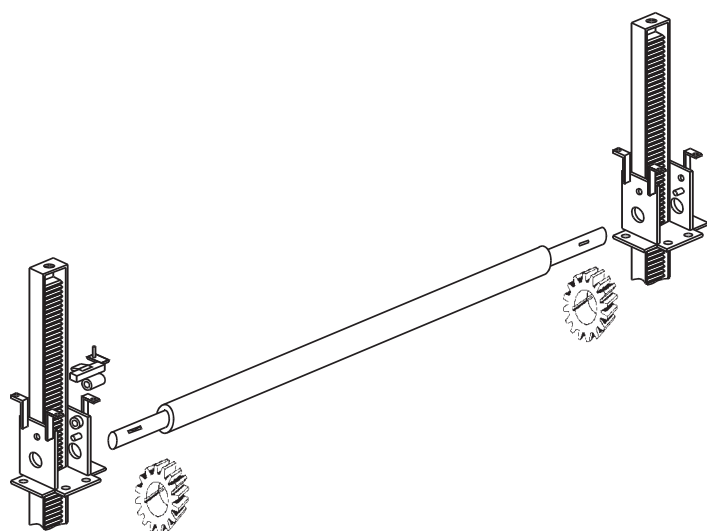

Model Number	Plunger Centers
12C	40-1/2"
12E, 12N	57-1/2"
12D, 12L	89-3/4"

For Globe Lifts

DIRECTFIT™

SVI Part #	Ref. OEM Part #	Description and Contents
BH-9411	B-39999	Pinion Gear
BH-9411-KIT	40826 212689	Pinion Gear 2" x 1-1/2" with Key for Globe and ISS / HDL Lifts
BH-9409	B-42580	Rack Bar for Auto Lock System
BH-9410	B-39818	Rack Bar for Manual Lock System
BH-9413-01K	35055x	Auto Lock Repair Kit
BH-9412-26 BH-9412-29 BH-9412-36 BH-9412-39 BH-9412-42* BH-9412-46 BH-9412-57 BH-9412-83 BH-9412-88		26-1/2" Plunger Center Equalizer Assy. 29-1/2" Plunger Center Equalizer Assy. 36" Plunger Center Equalizer Assy. 39" Plunger Center Equalizer Assy. 42" Plunger Center Equalizer Assy. 46" Plunger Center Equalizer Assy. 57-1/2" Plunger Center Equalizer Assy. 83-1/2" Plunger Center Equalizer Assy. 88" Plunger Center Equalizer Assy. <u>Includes:</u> (1) Shaft (2) BH-9412-01 Equalizer Brackets (2) BH-9412-12 Lock Pins and Keys <i>Rack Bars and Gears Sold Separate</i>
BH-9412-26L BH-9412-29L BH-9412-36L BH-9412-39L BH-9412-42L* BH-9412-46L BH-9412-57L BH-9412-83L BH-9412-88L		26-1/2" P.C. Locking Equalizer Assy. 29-1/2" P.C. Locking Equalizer Assy. 36" P.C. Locking Equalizer Assy. 39" P.C. Locking Equalizer Assy. 42" P.C. Locking Equalizer Assy. 46" P.C. Locking Equalizer Assy. 57-1/2" P.C. Locking Equalizer Assy. 83-1/2" P.C. Locking Equalizer Assy. 88" P.C. Locking Equalizer Assy. <u>Includes:</u> (1) Shaft (1) BH-9413-01L Left Lock Bracket (1) BH-9413-01R Right Lock Bracket (2) BH-9411-01 Keys <i>Rack Bars and Gears Sold Separate</i>
For Complete Assembly with Rack Bars and Gears add "C" to P/N		
*Note: Only the 42" shaft is available - no other parts.		

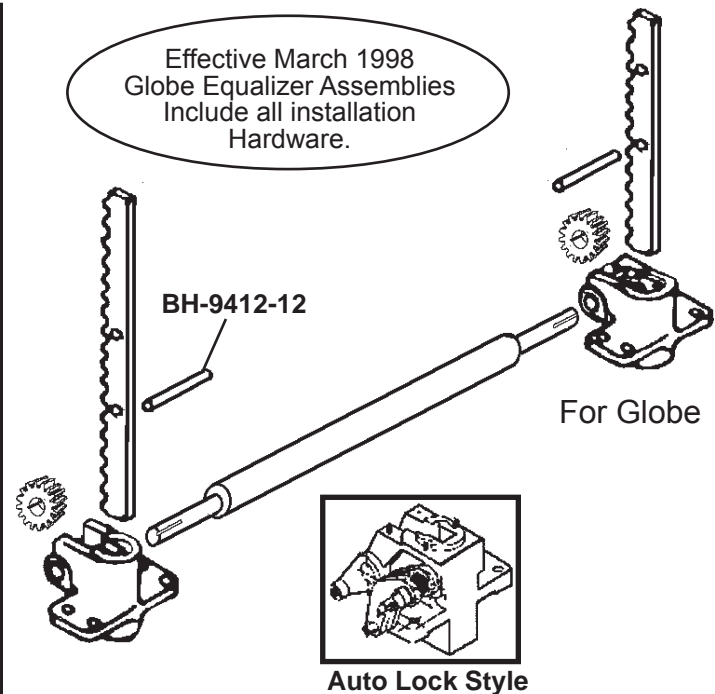

For Joyce Lifts

DIRECTFIT™

SVI Part #	Ref. OEM Part #	Description and Contents
BH-9613	18220	Pinion Gear
BH-9610	23431	Solid Round Rack Bar
BH-9515-10	23441	Safety Latch Trip
BH-9515-11	23442	Roll Pin
BH-9515-12	24755	Safety Latch Counter Weight
BH-9515-13	24756	Safety Latch Shoulder Bolt
BH-9515-40 BH-9515-48 BH-9515-57		40" Plunger Center Equalizer Assy. 48" Plunger Center Equalizer Assy. 57-1/2" Plunger Center Equalizer Assy. <u>Includes:</u> (1) 40", 48" or 57" Equalizer Shaft (2) BH-9515-05 Equalizer Brackets (2) BH-9515-06 Bushings (2) Keys <i>Rack Bars and Gears Sold Separate</i>
For Complete Assembly with Rack Bars and Gears add "C" to P/N		

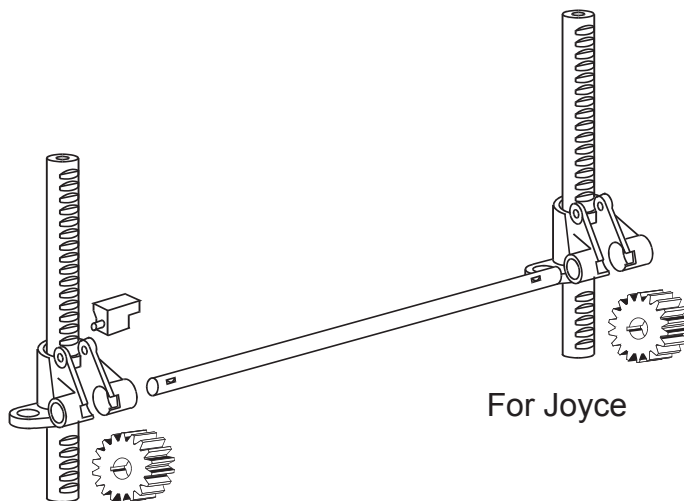

For Joyce

For Rotary Lifts

SVI Part #	Ref. OEM Part #	Description and Contents
BH-9760-01	FA279	Safety Latch Repair Kit (2 latches & pins)
BH-9760-02	FJ321-5	Slider Block
BH-9760-03	FJ37-40	Roller Assembly Kit
BH-9760-05	FJ37	Equalizer Frame
BH-9760-05R	FJ37R	Equalizer Frame with Rollers
BH-9760-06	FJ38	57-1/2" P.C. Equalizer Box for Sliders
BH-9760-06R	FJ311	57-1/2" P.C. Equalizer Box for Rollers
BH-9760-07	FJ38-11	Center Cover Plate (not pictured)

See the following two pages for Drop-In Rack and Pinion Equalizer Upgrade for DTO Lifts

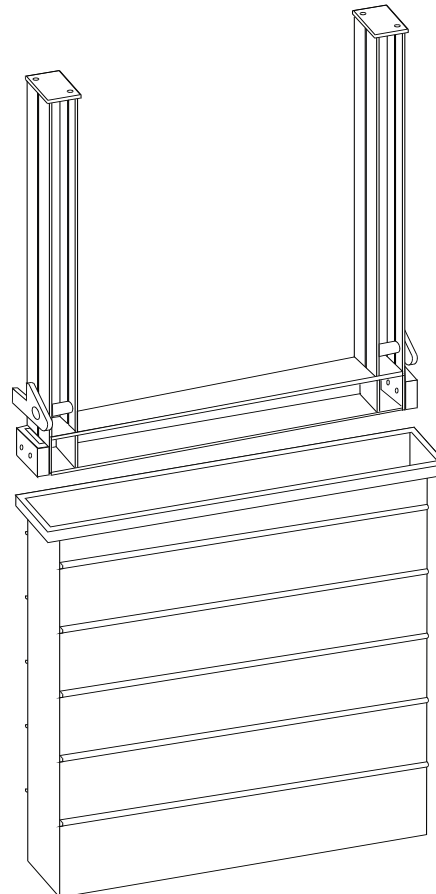

Continues on the following page... 5

For Rotary: DTO28 Rack and Pinion Equalizer Kits

SVI worked carefully with a distributor to design a system to extend the service life of DTO28 lifts produced by Rotary. Problems start when floor cleaners and moisture cause the equalizer box to corrode. This results in backfill pouring through the rusted openings and interfering with the equalizer operation, thus hanging the lift up.

In the past, there were only three ways to deal with the problem. You either excavate and replace the corroded box at great cost, scoop out the backfill every so often or condemn the lift. This is over with SVI's new **Drop-In Rack and Pinion Equalizer Assembly for DTO lifts.**

Order BH-9760-09 Kit for 4" Wide Box

BH-9760-09AL Drop-In Auto Lock for Equalizer Assembly

BH-9760-10 Kit for 4-3/4" Wide Box

Installation is a breeze:

- 1) Remove the old equalizer frame.
- 2) Clean out the bottom of the box at the ends so rack guides fit to the bottom.
- 3) Assemble the new rack bar guide tubes to cross supports, drop in the opening and square up.
- 4) Assemble the pinion housing and shaft assembly, set in box and line up with the guide tubes.
- 5) Drill (20) 3/8" holes in the concrete using the pinion housing as a template and bolt housing down using the anchors supplied. **Note:** make sure rack bars mate properly with pinions and fit easily through the housing before drilling and bolting.
- 6) Install rack bars making sure each starts with the same tooth and bolt to bolster. You may need to elongate the bolt hole in the bolster with a torch so the rack movement is perpendicular to the plunger.
- 7) Show your customer how good the lift works again and accept thanks for solving the problem.

Detailed Instructions are included with each kit.
(Instruction Sheet: BH-9760-09S)

New system includes:
rack bars, pinion gears, shaft, brackets, center cover, guide tubes, manual placement locks and fasteners.



Existing
Equalizer
Box

Manual Style Rack Bar Locks

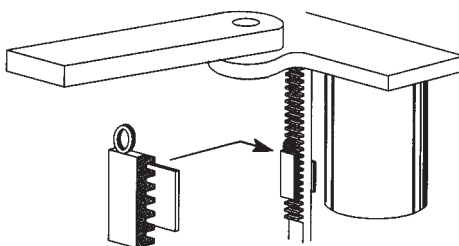

Order: BH-9612ML
Fits Rack Bar:
BH-9612

Manual Rack Bar Lock For:
Side-by-Side Lifts
w/ Square Rack Bar

For Rotary: Drop In Rack and Pinion Equalizer Upgrade for DTO28 Lifts

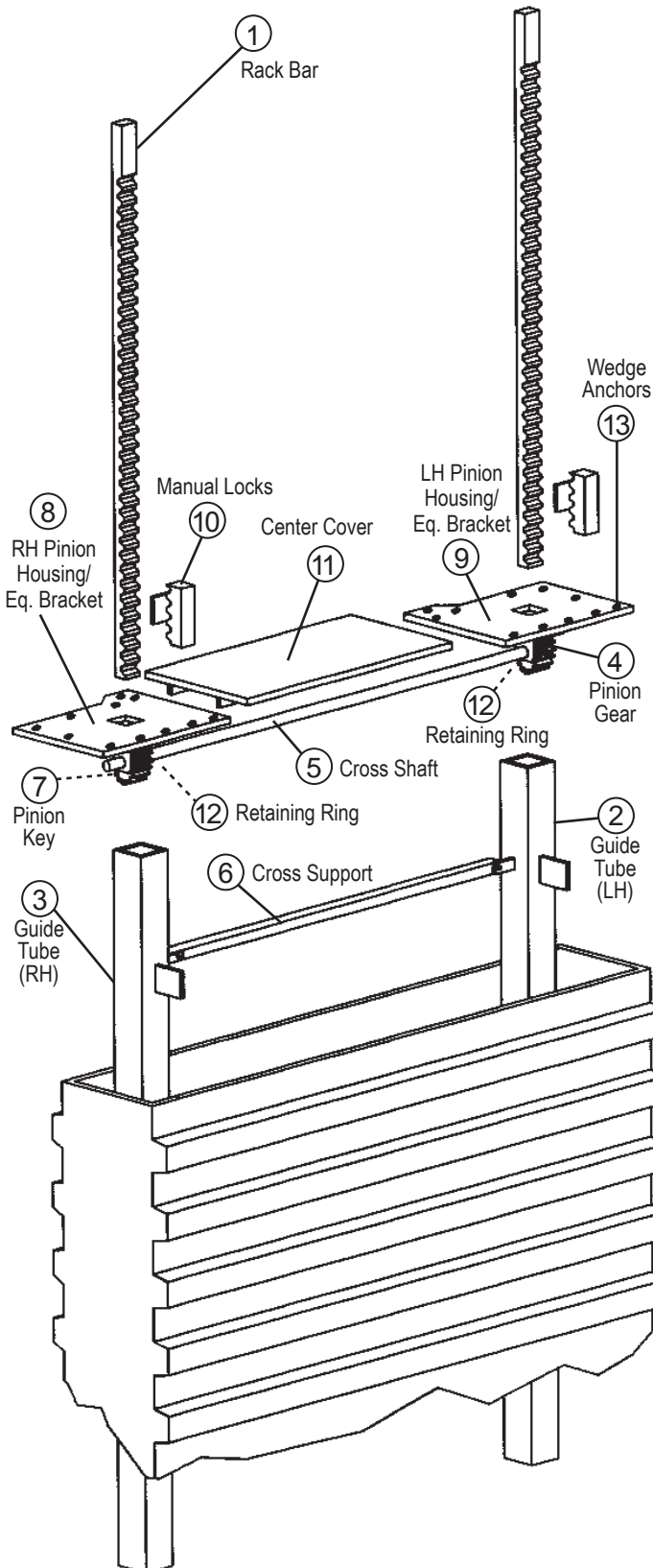
**BH-9760-09**

For 4" Wide Box

BH-9760-10

For 4-3/4" Wide Box

BH-9760-09AL

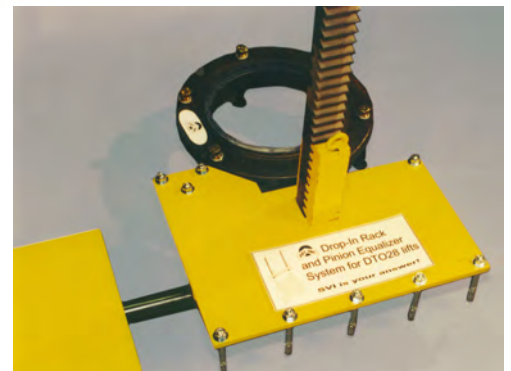

Auto Lock

Item	SVI Part #	Qty.	Description / (Kit Specified)
1	BH-9760-10R	2	Rack Bar
2	BH-9760-10XE	1	LH Guide Tube (BH-9760-09)
	BH-9760-10XE	1	LH Guide Tube (BH-9760-09AL)
	BH-9760-10E	1	LH Guide Tube (BH-9760-10)
3	BH-9760-10XH	1	RH Guide Tube (BH-9760-09)
	BH-9760-10XH	1	RH Guide Tube (BH-9760-09AL)
	BH-9760-10H	1	RH Guide Tube (BH-9760-10)
4	BH-9112	2	Pinion Gear
5	BH-9760-10C	1	Cross Shaft for Equalizer
6	BH-9760-10J	2	Cross Supports
7	BH-9614-06	2	Equalizer Pinion Key
8	BH-9760-10XB	1	RH Pinion Housing / Eq. Bracket
	BH-9760-10LOC	1	RH Eq. Bracket (BH-9760-09AL)
9	BH-9760-10XA	1	LH Pinion Housing / Eq. Bracket
	BH-9760-10PIA-C	1	LH Eq. Bracket with Lock (BH-9760-09AL)
10	BH-9611ML	1	Any Position Manual Locks (Pair)
11	BH-9760-10XG	1	Center Cover (BH-9760-09)
	BH-9760-10G	1	Center Cover (BH-9760-10)
12	BH-9614-05	2	Retaining Rings
13	F-WA-0375-3750	20	3/8" x 3-3/4" Wedge Anchors
14	BH-7512-90B		Shims (1/16") Pack of 20
Parts/Hardware Not Pictured:			
	F-HC-0375-16-1000	4	3/8"-16 x 1" Hex Head Capscrews
	F-HN-0375-16	4	3/8"-16 Hex Nuts
	F-HC-0500-13-2500	2	1/2"-13 x 2-1/2" Hex Head Capscrews
	F-LW-0500	2	1/2" Lockwashers
	BH-9620-37	1	Adpt Adjusting Handle (BH-9760-09AL)



For Weaver Lifts

DIRECTFIT™

SVI Part #	Ref. OEM Part #	Description and Contents
BH-9613	S-24522	Pinion Gear
BH-9610	S-18807	Round Rack Bar 
BH-9611	S-23134	Rectangular Rack Bar 
BH-9612	1080236	Square Rack Bar 
BH-9614 BH-9615 BH-9616 BH-9617		57-1/2" Square Rack Equalizer Assy. 57-1/2" Rect. Rack Equalizer Assy. 40" Rectangular Rack Equalizer Assy. 89" Square Rack Equalizer Assy. <u>Includes:</u> (1) 57-1/2", 40" or 89" Shaft, spacers, pillow blocks, square specers, keys, cap screws, retaining rings <i>Racks, Gears & Lock Sold Separate</i>
BH-9614-10	KL-345	Equalizer Lock (Square Rack System)
BH-9614-10R	KL-345R	Equalizer Lock (Rect. Rack System)
BH-9618		40" Round Rack Equalizer Assy. <u>Includes:</u> Coupler Shaft, Gear Shafts, Clevis Pins, Cotter Pins, Woodruff Keys <i>Racks, Gears & Lock Sold Separate</i>
For a Locking Equalizer Assy. including Lock add "L" to P/N. For a Complete Assembly including Rack Bars and Gears add "C" to P/N. For a Complete Locking Assy. including Rack Bars, Gears, and Lock add "LC" to P/N.		

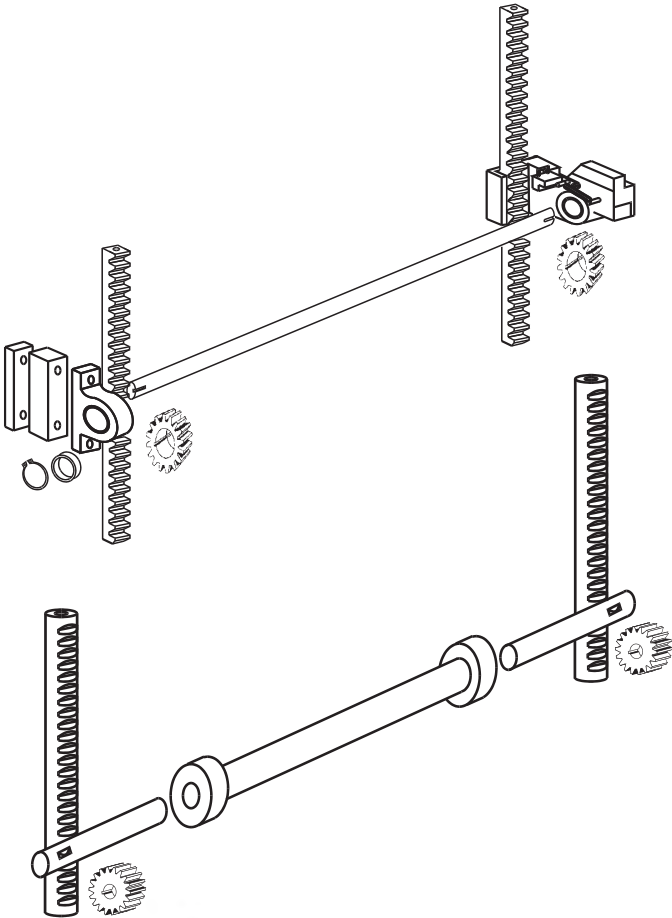

For Western Lifts

FOR TWO CABLE SYSTEMS SINCE JUNE 1985

DIRECTFIT™

SVI Part #	Ref. OEM Part #	Description and Contents
BH-9702-01	F-602	134" Equalizer Cable for WP-2
BH-9704-01	F-607	109" Equalizer Cable for P-2
BH-9702-02	F-617	Pulley and Axle Assembly
BH-9702-03	F-645	Pulley Bracket
BH-9701-08	U-606	Equalizer Strut with lock (round)
BH-9702-07	F-510	Pulley Box Cover for WP-2
BH-9702-08	F-515	Pulley Box Cover for P-2
BH-9702-10		Pulley and Axle Repair Kit

Note: SVI In-Ground Equalizer Cables for Western Lifts are Constructed Using Stainless Steel Wire Rope and Carbon Steel End Fittings.

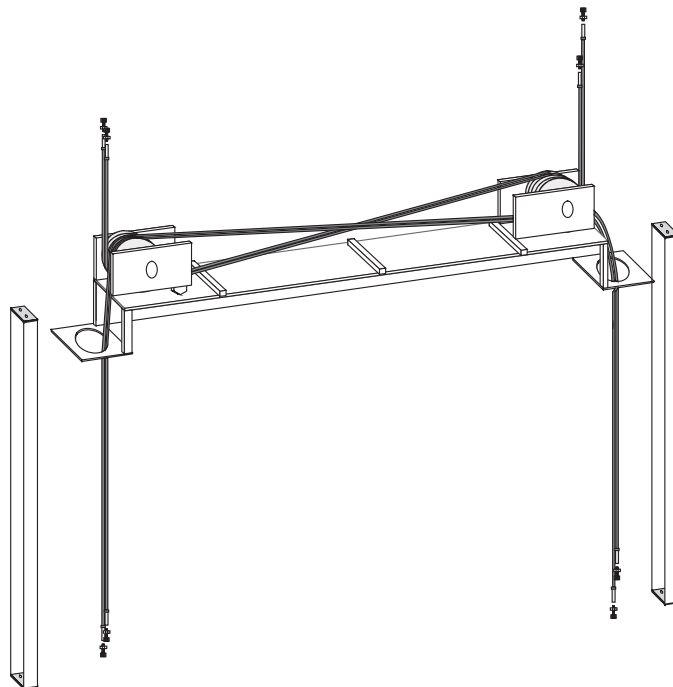
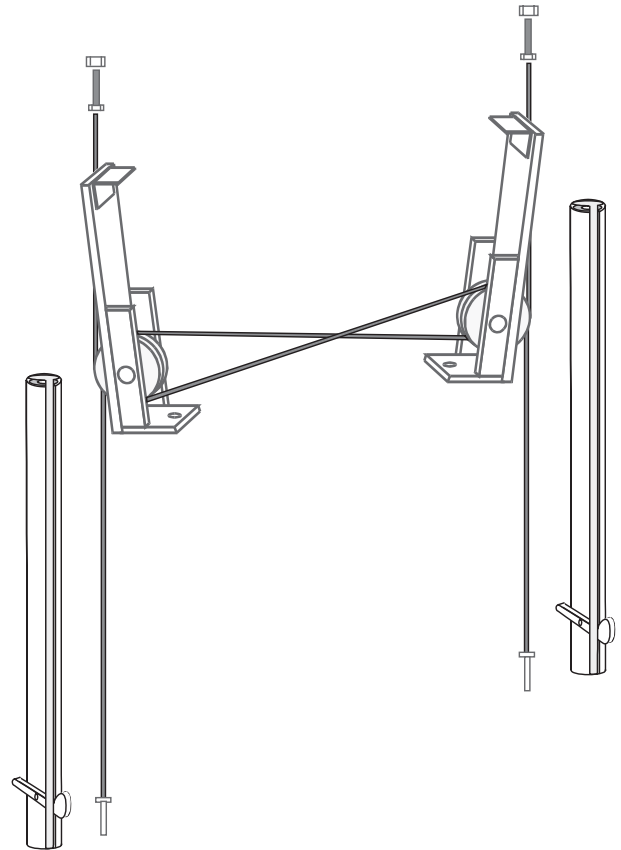

FOR FOUR CABLE SYSTEMS PRIOR TO JUNE 1985

SVI Part #	Ref. OEM Part #	Description and Contents
BH-9701-01	F-600	153-1/2" Equalizer Cable for WP-2
BH-9703-01	F-605	129-1/2" Equalizer Cable for P-2
BH-9701-02	F-615	Pulley and Axle Assy. (11/83 to 6/85)
BH-9701-03	F-610	Pulley and Axle Assy. (Prior to 11/83)
BH-9701-04	F-635	Equalizer Strut with lock (rectangular)
BH-9701-15	F-500	Pulley Box Cover for WP-2, AR-2
BH-9701-16	F-520	Pulley Box Cover for P-2
BH-9701-10		Pulley and Axle Repair Kit



DIRECT FIT™ BRAND

SVI International, Inc.

Catalogs and Information Online: www.sviinternational.com

AUTO LIFT REPAIR PARTS FOR

ALL MAKES & MODELS

~NO MATTER THE AGE OF THE LIFT!

- Arm Restraint Kits & Parts
- Cables—Lifting and Equalizing
- Chain
- doorjammerPRO - Door Protection Pad
- Height Extensions and Rubber Pads
- Installation Products & Tools
- Power Units and Parts
- Pulleys and Chain Rollers
- Seal Kits for In-Ground & Surface Mount
- Safety Legs / Non-Rotators
- Replacement Lift Kits
- Power Post Lifting Systems
- Tanks for In-Ground Lifts
- Turf Attachments for 2-Post Lifts

SURFACE MOUNT LIFT PARTS FOR:

Acanus	Gemini	Quality
Ammco®*	Gilbarco	Ranger
Alamo /	Globe	Ravaglioli
ASSSA	Grand	Rotary Lifts
ALM	Hofmann	Silent Tech
AMI	Hydralift	Slift
Ashawa	Ime Istobal	Somers Souriau
Ben Pearson	Kismet	Stenhoj
BendPak	Kimm	Stertil Koni
Benwil	Koni	Sun
Bishamon	Launch	Tecalemit
Boston	Laycock	Titan
Bradbury	Lincoln	Weaver
Cascos	Maha	Werther
Consul	Manitowoc Lifts	Western
Challenger	Mohawk	Westinghouse
Force	Nussbaum	Wheeltronic
Ford Smith	OMA	Worth
Forward	OMCN	Zippo
Fuchs / Zippo	PMW	

IN-GROUND LIFT PARTS FOR:

Benwil	Gilbarco	PKS Lifts
Challenger	Globe	Rotary
Cochin	HDL/ISS Innovative	US Hoist
Curtis	Joyce	Weaver
Ford Smith	Manitowoc Lifts	Western

AIR COMPRESSOR PARTS

- Air Receiver Tanks • Compressor Mufflers
- Automatic Tank Drain Valve for Champion Compressors
- Filters—Many OEM Ref Available!
- Filters, Regulators, Lubricators
- Intake Filter Products
- Milton Air System Products
- Re-Coil Hose • Valves
- Vibration Dampening Pads & much more!

BRAKE LATHES REPAIR PARTS

- Brake Lathe Repair Parts and Accessories for All Makes 

EXHAUST REMOVAL SYSTEMS & PRODUCTS

FLUID DELIVERY

- Lenz Fittings
- Steel Hydraulic Line Tubing and Fittings
- Strut and Hangers

HOSE REELS BY REELCRAFT®

HYDRAULIC CYLINDERS—

- Custom Single-Acting Large Bore Cylinders
- Also see "Lifting Equipment"

LIFTING EQUIPMENT

- New In-Ground Lifts—Car, Truck & Bus
- Small Equipment Shop Maintenance (SESM) Lifts for lifting Landscape Equip. ATVs / UTVs, Motorcycles, Lawn Mowers, Golf Carts and More!
- Custom Lifting Equipment incl. Production Line Lifts, Rail Car Lifts and More
- Custom Hydraulic Cylinders for Various Applications
- Turf Attachments for 2-Post Lifts
- In-Ground Lift Sections and Kits
- And more!

EASY TO ORDER:

800-321-8173

815-748-0200

Fax: 800-899-1784 • 815-748-0210

E-Mail: parts@sviintl.com

www.sviinternational.com

LUBRICATION & PAINT / FOAM

SPRAY REPAIR PARTS & KITS FOR:

- Alemite • ARO • Balcrank • Graco • Lincoln

PETROLEUM EQUIPMENT

& REPAIR PARTS FOR:

- Gas Pump & Meter Kits and Parts for Gasboy • Tokheim • Fill-Rite
- Including Parts for Older Pumps: Wayne • Bennett • Gilbarco • Bowser A.O. Smith (Geosource) • Southwest

SEAL KITS

SHOP EQUIPMENT

- Hein-Werner Products • Omega Products
- Porto-Power • Pro-Lift

TIRE EQUIPMENT REPAIR PARTS

- Tire Changer and Wheel Balancer Parts for All Makes

Accu-Turn	FMC	Nussbaum
All Tool	Giuliano	Ranger
Ammco®*	Hofmann	Sicam
BaseLine®*	Hunter	Sice
Bosch	John Bean /	Snap-On
Cemb	(JBC)	Teco
Coats®*	Kwik-Way	Tuxedo
Corgi	Launch	

VALVES

- Air Compressor Valves of All Types
- Air and Hoist Control Valves
- Ball Valves • Check Valves
- Kingston Valves • Pressure Relief Valves
- Relief Valves • Safety Valves
- Solenoid Valves
- Tire Changer Valves • And More!

CUSTOM PRODUCTS

And let us know if you want something you use in your shop to be added to our product line!

DIRECT FIT™

In addition to SVI's DIRECT FIT™ BRAND, we are proud to be a one-stop shop for many other great products including:



B-Line
by E.T.N

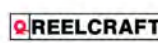

and many more!

3 Ready-Ship Warehouses for Faster Shipping! | **BALTIMORE • CHICAGO • LOS ANGELES**

Main Office: 155 Harvestore Drive • DeKalb, IL 60115

All names, numbers, symbols and descriptions are used for reference purposes only. It is not implied that any part listed is the product of these manufacturers.

SVI does not represent and is not associated in any way with any other companies. Entire contents copyright © 2020, SVI International, Inc. Prices subject to change without notice.

*AMMCO, BASELINE, COATS and DUCKHEAD are registered trademarks of Hennessy Industries, Inc. SVI International, Inc. is not associated in any way with Hennessy Industries, Inc.

**TERMS AND CONDITIONS OF THE
SALES ORDER
FOR SVI INTERNATIONAL, INC.**

1. **GENERAL.** The terms and conditions of sales order outlined herein shall apply to the sale by SVI INTERNATIONAL, INC. (hereinafter referred to as "Company") of the items described on the facing page (hereinafter referred to as "Merchandise") to Purchaser.
2. **DELIVERY.** Delivery shall be deemed to be complete when the Merchandise has been shipped F.O.B. Company's plants in DeKalb, Illinois, Montclair, California; and Hanover, Maryland ("Company's plants"). Shipments are subject to delays from causes or contingencies beyond the reasonable control of the Company. When otherwise not specified, shipments will be made in standard containers via carrier which, in the judgment of the Company, will result in the most practical method. Title and right of possession will pass to the Purchaser upon receipt by the carrier at the shipping point. If a customer of the Company should specify a specific carrier's method of shipment (i.e. UPS Next Day Air) and that carrier does not perform to the customer's expectations, freight credit to a customer's account will not be issued unless the Company can first obtain a credit.
3. **RISK OF LOSS.** Identification of the Merchandise under Uniform Commercial Code (hereinafter referred to as "UCC") Section 2-501 shall take place at the moment of shipment F.O.B. Company's plants. Risk of loss shall pass to the Purchaser when the Merchandise is shipped from the Company's plants.
4. **TITLE.** Title to the merchandise shall transfer to the Purchaser when the Merchandise is shipped from the Company's plants.
5. **WARRANTIES.** The Company guarantees its products to be free from defects in workmanship and raw materials for a period of one year from date of purchase. THIS WARRANTY IS EXPRESSLY IN LIEU OF ANY AND ALL WARRANTIES EXPRESS OR IMPLIED. COMPANY DOES NOT WARRANT THE MERCHANDISE IS MERCHANTABLE OR FIT FOR ANY PARTICULAR PURPOSE. Company's liability for breach of the terms of this Agreement, including any warranty, is limited to either refund of the invoice price of the Merchandise or at Company's option, replacement of the Merchandise free of charge, including transportation charges but not including the cost of labor. Purchaser has not relied on any statement or upon the conduct of Company with respect to the prospective use of the merchandise. Company shall not be liable for and Purchaser waives any and all claims for any loss or damage, directly or indirectly, arising from the use of the Merchandise and for punitive, incidental or consequential damages, including, but not limited to, damages to property, for loss of use, loss of time, loss of profit or loss of income. The Company does not authorize the sale of our products under any other warranty, expressed or implied. **Please note:** Electrical components and cylinder or shaft seals are not covered under warranty.
6. **SETOFF.** All claims for money due or to become due from the Company shall be subject to deduction by the Company for any setoff or counterclaim arising out of this or any other claims of the Company or its affiliated companies, whether such setoff or counterclaim arose before or after any assignment by Purchaser.
7. **INDEMNIFICATION.** Purchaser agrees to indemnify the Company and hold it harmless from and against all claims, liability, loss, damage or expense, including reasonable counsel fees, arising from or by reason of any modifications or alterations made by Purchaser. If a customer of the Company modifies or alters any part, in any manner whatsoever, or uses any part in departure from recommended performance specifications, said customer agrees to indemnify and hold the Company harmless from and against all liability and expenses based on damage to property or injury to or death of any person arising out of or attributable to such modified or altered part. Further, the Company will not accept any such modified or altered part for credit to a customer's account.
8. **FREIGHT POLICY.** Freight charges are prepaid and added to invoice or collect FOB shipping point. Note: All customers are responsible for all carrier shipping costs, fees, surcharges, etc. including order refusal and return fees.
9. **RETURN POLICY.** To return a part for credit or inspection, Purchaser must first contact our Main Office in Illinois, to obtain a Return Merchandise Form. Once Purchaser has obtained this form, the parts can be returned freight prepaid only. The Return form must be included with the shipment. Parts returned to the Company without the approved form will be returned freight collect to the shipper or refused. Returns must be initiated within 30 days of the invoice date. The Return Forms are valid for 30 days, from the date of issue. All Returns are subject to restocking charges. Return parts brought into our remote warehouses, will not be accepted by our personnel, without a Return Merchandise Form from the Main Office. Parts which have been used in any way or manner, including any installation or incorporation into a lift, hoist, or other equipment, shall NOT be eligible for return whether or not a Return form has been assigned. **Please note:** Electrical parts or components are not returnable for credit. This includes all switches, pushbuttons, relays, electric motors, capacitors, fuses, solenoids, power units with wiring issues or any other electrical items. Custom, built to order, special order, and non-stocked genuine parts are non-returnable.
10. **RESTOCK CHARGE.** Returns are subject to a restocking charge. Refusals are subject to the same restocking charge plus the cost of outbound and return freight charges and/or fees incurred by the Company due to shipment refusal.
11. **PRICES AND PAYMENTS.** All prices are subject to change without notice. All prices are F.O.B. shipping point. The Company standard terms are net 30 days, C.O.D. company check, C.O.D. cash, VISA, MasterCard, Discover or American Express. However, if in the judgment of the Company, the financial condition of the Purchaser at any time does not justify shipment according to standard terms of payment, the Company may require full or partial payment in advance.
12. **INTERPRETATION.** This sales order is intended by the parties as a complete and exclusive statement of the terms of their agreement. It supersedes all prior agreements, written or oral. No course of prior dealings between the parties and no usage of the trade shall be relevant to supplement or explain any terms used in this sales order. Acceptance or acquiescence in a course of performance rendered under this purchase order shall not be relevant to determine the meaning of this sales order even though the accepting or acquiescing party has knowledge of the nature of the performance and opportunity for objection. Whenever a term defined by the UCC is used in this sales order the definition contained in the UCC shall control.
13. **MODIFICATION.** This sales order can be modified or rescinded only by a writing signed by both parties.
14. **WAIVER.** No claim or right arising out of a breach of this sales order can be discharged in whole or in part by a waiver or renunciation of the claim or right unless such waiver or renunciation is supported by consideration and is in writing signed by the aggrieved party.
15. **ASSIGNMENT.** No right or interest in this sales order shall be assigned by either party without the written consent of the other and no delegation of any obligation owed, or of the performance of any obligation by either the Company or Purchaser shall be made without the written consent of the other party. Any attempted assignment or delegation not made in conformity with this paragraph shall be wholly void and totally ineffective for all purposes.
16. **TIME TO PERFORM AND BRING ACTION.** Time is of the essence of this sales order. Any action for breach of this sales order shall be commenced within two (2) years after the cause of action has accrued. Any party who loses any litigation shall reimburse the other party for costs including reasonable attorney's fees. The exclusive jurisdiction for any legal action shall be the Circuit Court of DeKalb County, Illinois.
17. **APPLICABLE LAW.** This sales order shall be governed by the UCC of Illinois as effective and in force on the date of this sales order.



BALTIMORE • CHICAGO • LOS ANGELES



Rack Bars, Pinion
Gears and Equalizer
Components and Kits

Insist on SVI Direct Fit™
brand Products!

DIRECTFIT™

- Air Compressor Parts and Filters
- Auto Lift Parts for Any Brand
- Auto Lift Cables and Chain
- Auto Lift Power Units and Parts
- Auto Lift Sheaves / Pulleys and Chain Rollers
- Brake Lathe Repair Parts for All Makes
- Exhaust System Products
- Fluid Delivery Repair Parts
- Hose Reels and Hose Stops
- In-Ground Auto Lifts
- Lubrication Equipment Repair Parts
- Petroleum / Service Station Pump and Tank Products
- Repair Parts for Gasboy Consumer Series
- SESM Lifts for ATV/UTV, Golf Cart and More!
- Tire Changer Repair Parts
- Transfer Pumps
- Turf Attachments for 2-Post Lifts
- Vehicle Lifting Systems
- Wheel Balancer Accessories

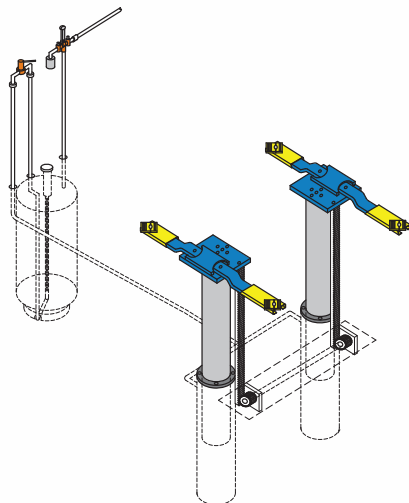
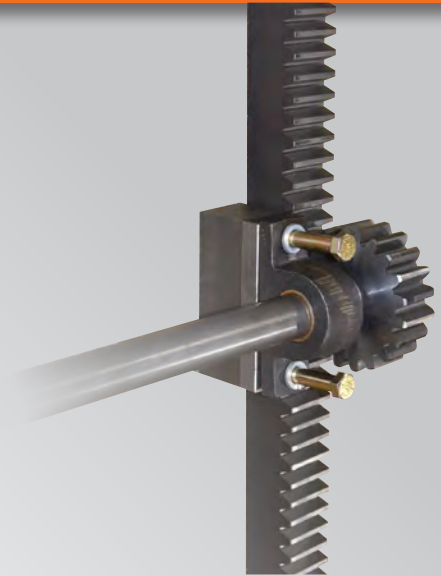

SVI International, Inc.

155 Harvestore Drive • DeKalb, IL 60115

800-321-8173 • 815-748-0200

Fax: 800-899-1784 • 815-748-0210

Entire contents copyright © 2020, SVI International, Inc.

Information and Catalogs Online:
www.sviinternational.com