



**DIRECTFIT™**

# Auto Lift Repair Parts and Accessories for Cochin

Automotive Shop Equipment | Auto Lift Repair Parts

*The Industry's Largest Selection of Auto Lift Repair Parts*

**DIRECTFIT™**  
SVI's DIRECT FIT™ BRAND

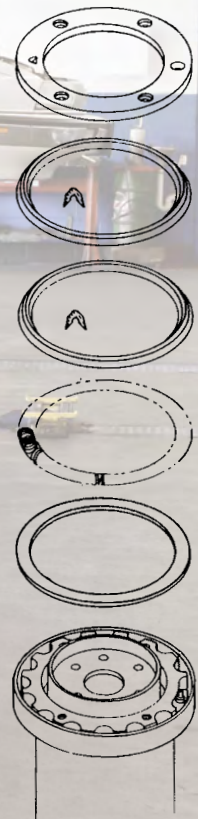
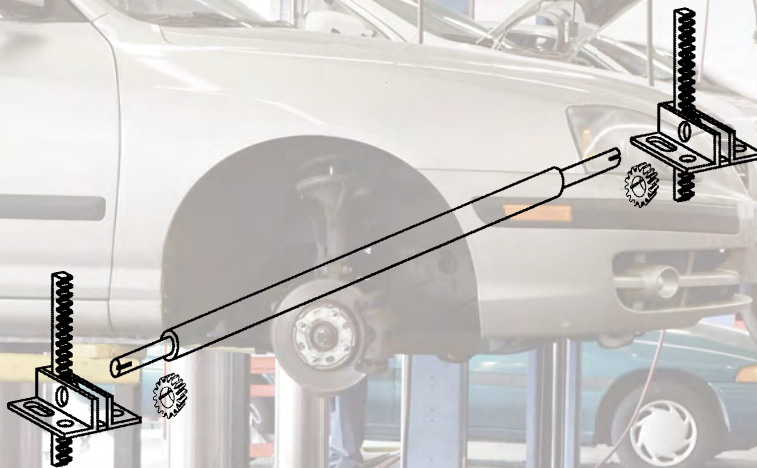

**SVI International, Inc.**  
155 Harvestore Drive • DeKalb, IL 60115

**800-321-8173**  
**815-748-0200**

[www.sviinternational.com](http://www.sviinternational.com)

BALTIMORE • CHICAGO • LOS ANGELES

## Hoist Packing

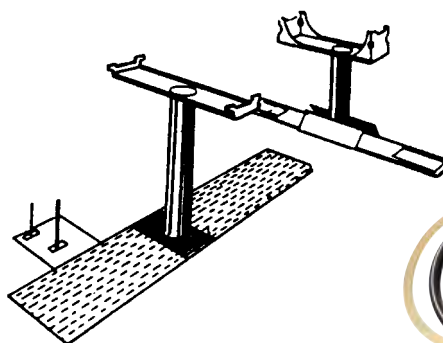
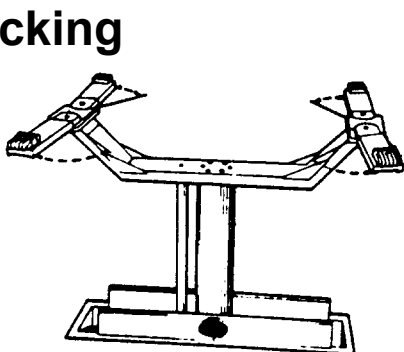
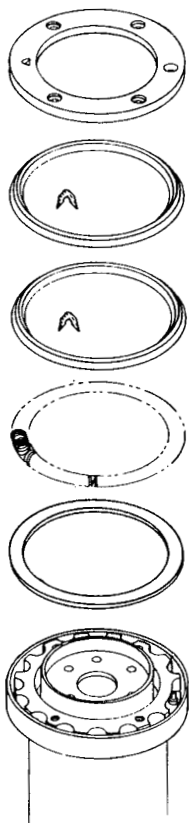

**DIRECTFIT™**  
SVI's DIRECT FIT™ BRAND



SVI Part #	Ref. OEM Kit #	Plunger Diameter	Contents and Descriptions
<b>For ALL 8-1/2" Diameter Plungers:</b>			
BH-1790	L-8-340	8-1/2"	2 - 9-3/4" x 8-1/2" Synthetic Vees 1 - Adapter Spring 1 - Spring Follower Shim 1 - Gasket 1 - Felt Wiper
BH-1790E	A-21605	8-1/2"	Optional Synthetic Rubber Wiper
BH-1790G	A-20656	8-1/2"	Optional Aluminum Gland Ring
<b>For ALL 10-5/8" Diameter Plungers:</b>			
BH-1735	L-10-5/8	10-5/8"	3 - 35-3/4 x 19/32" Hose Style Packings
BH-1737	L-10-340-F	10-5/8"	2 - 11-3/4" x 10-5/8" Synthetic Vees 1 - Adapter Spring 1 - Spring Follower Shim 1 - Gasket 1 - Felt Wiper
BH-1737E	A-21606	10-5/8"	Optional Synthetic Rubber Wiper
BH-1737G	B-20643	10-5/8"	Optional Aluminum Gland Ring

## Rack Bars, Gears, and Equalizer Assemblies

SVI Part #	OEM Part #	Description	Contents and Description
BH-9110	A-21458	Rack Bar - 72" Long	1 - Rack Bar
BH-9111	A-21458-84	Rack Bar - 84" Long	1 - Rack Bar
BH-9110ML		Manual Rack Bar Lock for Cochin	2 - Manual Rack Bar Lock
BH-9112	10025N	Pinion Gear	1 - Pinion Gear
BH-9113-40	50000-40	Equalizer Assembly (40" Piston Centers)	Incl.: Shaft, Housings, Bushings, Keys, Collars, Set Screws, Gears ( <b>Rack Bars Not Included</b> )
BH-9113-57	50000-57	Equalizer Assembly (57-1/2" Piston Centers)	Incl.: Shaft, Housings, Bushings, Keys, Collars, Set Screws, Gears ( <b>Rack Bars Not Included</b> )
BH-9113-85	50000-85	Equalizer Assembly (85" Piston Centers)	Incl.: Shaft, Housings, Bushings, Keys, Collars, Set Screws, Gears ( <b>Rack Bars Not Included</b> )
BH-9113-40C	50000-40C	Complete Equalizer Assembly (40" Piston Centers)	Incl.: Rack Bars, Pinion Gears, Shaft, Housings, Bushings, Keys, Collars, Set Screws
BH-9113-57C	50000-57C	Complete Equalizer Assembly (57-1/2" Piston Centers)	Incl.: Rack Bars, Pinion Gears, Shaft, Housings, Bushings, Keys, Collars, Set Screws
BH-9113-85C	50000-85C	Complete Equalizer Assembly (85" Piston Centers)	Incl.: Rack Bars, Pinion Gears, Shaft, Housings, Bushings, Keys, Collars, Set Screws
BH-9113-01	A-21361	85" Equalizer Shaft Only	1 - Shaft (91" Overall Length)
BH-9114-01	A-21363	40" Equalizer Shaft Only	1 - Shaft (46" Overall Length)
BH-9114-02	A-21362	57-1/2" Equalizer Shaft Only	1 - Shaft (63-1/2" Overall Length)
BH-9113-03	A-21115	Locking Collar with Set Screw	1 - Locking Collar

*continues on following page*

**DIRECTFIT™**  
SVI's DIRECT FIT™ BRAND

## Rack Bars, Gears, and Equalizer Assemblies (continued)

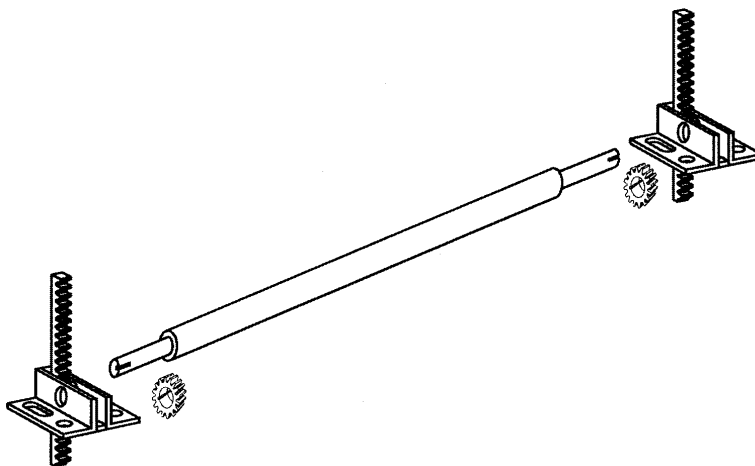

SVI Part #	OEM Part #	Description	Contents and Description
BH-9113-05	A-21459	Equalizer Bracket	1 - Non-Locking Equalizer Housing
BH-9614-06	10024N	Key 1 - 1/4" Key	
BH-9120-40	50000-40L	Locking Equalizer Assembly (40" Piston Centers) Pinion Gears ( <b>Rack Bars Not Included</b> )	Incl.: Housing, Lock Housing, Shaft, Lock, Lock Release Handle, Bushings, Keys, Collars, Set Screws,
BH-9120-57	50000-57L	Locking Equalizer Assembly (57-1/2" Piston Centers) Pinion Gears ( <b>Rack Bars Not Included</b> )	Incl.: Housing, Lock Housing, Shaft, Lock, Lock Release Handle, Bushings, Keys, Collars, Set Screws,
BH-9120-85	50000-85L	Locking Equalizer Assembly (85" Piston Centers) Pinion Gears ( <b>Rack Bars Not Included</b> )	Incl.: Housing, Lock Housing, Shaft, Lock, Lock Release Handle, Bushings, Keys, Collars, Set Screws,
BH-9120-40C	50000-40LC	Complete Locking Equalizer Assy. (40" Piston Centers)	Incl.: RackBars, Housing, LockHousing, Shaft, Lock Release Handle, Bushings, Keys, Collars, Set Screws, Pinion Gears
BH-9120-57C	50000-57LC	Complete Locking Equalizer Assy. (57-1/2" Piston Centers)	Incl.: RackBars, Housing, LockHousing, Shaft, Lock Release Handle, Bushings, Keys, Collars, Set Screws, Pinion Gears
BH-9120-85C	50000-85LC	Complete Locking Equalizer Assy. (85" Piston Centers)	Incl.: RackBars, Housing, LockHousing, Shaft, Lock Release Handle, Bushings, Keys, Collars, Set Screws, Pinion Gears
BH-9120-01		Lock Release Handle	1 - Release Handle for Lock System
BH-9120-02	A-21698	Equalizer Lock	1 - Lock Assembly
BH-9120-03	A-21459	Grooved Equalizer Bracket	1 - Equalizer Bracket for Lock System

## Plunger, Casing, Bearing, and Axle Assemblies

SVI Part #	OEM Part #	Description	Contents and Description
BH-9125	A-21447	Upper Bearing 75" Rise	For Rear Post on MP-8
BH-9125-01	A-21451	Cylinder Casing 8-1/2"	Cylinder Assembly for All 8-1/2" / Please specify lift model
BH-9125-02	A-21433	Plunger (Ram) 8-1/2"	Plunger Assembly for All 8-1/2" / Please specify lift model
BH-9126	A-20714	Upper Bearing 68" Rise	For Side By Side Lifts
BH-9127	A-21443	Upper Bearing	For All 10-5/8" Plungers
BH-9127-01	A-21490	Semi-Hydraulic Casing	For All 10-5/8" Single Post Semi-Hyd.
BH-9127-02	B-20952	Semi-Hydraulic Plunger	For All 10-5/8" Single Post Semi-Hyd.
BH-9127-03	A-21440	Full-Hydraulic Casing	For Single Post 10-5/8" Full Hyd.
BH-9127-03A	A-21440	Full-Hyd. Moveable Casing	For Front Plunger MP-210
BH-9127-04	A-21444	Full-Hydraulic Plunger	For All 10-5/8" Full Hydraulic Lifts
BH-9128-01	10106N	Axle Rollers for All Axles	For Moveable Piston Axle Assemblies
BH-9128-02	A-21264	Axle Shaft for 8-1/2"	For 8-1/2" Moveable Piston
BH-9128-03	A-21335	Axle Shaft for 10-5/8"	For 10-5/8" Moveable Piston





# DIRECT FIT™ BRAND

## SVI International, Inc.

Catalogs and Information Online: [www.sviinternational.com](http://www.sviinternational.com)

### AUTO LIFT REPAIR PARTS FOR ALL MAKES & MODELS

~NO MATTER THE AGE OF THE LIFT!

- Arm Restraint Kits & Parts
- Cables—Lifting and Equalizing
- Chain
- doorjammerPRO - Door Protection Pad
- Height Extensions and Rubber Pads
- Installation Products & Tools
- Power Units and Parts
- Pulleys and Chain Rollers
- Seal Kits for In-Ground & Surface Mount
- Safety Legs / Non-Rotators
- Replacement Lift Kits
- Power Post Lifting Systems
- Tanks for In-Ground Lifts
- Turf Attachments for 2-Post Lifts

### SURFACE MOUNT LIFT PARTS FOR:

Acanus	Gemini	Quality
Ammco®*	Gilbarco	Ranger
Alamo /	Globe	Ravaglioli
ASSSA	Grand	Rotary Lifts
ALM	Hofmann	Silent Tech
AMI	Hydralift	Slift
Ashawa	Ime Istobal	Somers Souriau
Ben Pearson	Kismet	Stenhoj
BendPak	Kimm	Stertil Koni
Benwil	Koni	Sun
Bishamon	Launch	Tecalemit
Boston	Laycock	Titan
Bradbury	Lincoln	Weaver
Cascos	Maha	Werther
Consul	Manitowoc Lifts	Western
Challenger	Mohawk	Westinghouse
Force	Nussbaum	Wheeltronic
Ford Smith	OMA	Worth
Forward	OMCN	Zippo
Fuchs / Zippo	PMW	

### IN-GROUND LIFT PARTS FOR:

Benwil	Gilbarco	PKS Lifts
Challenger	Globe	Rotary
Cochin	HDL/ISS Innovative	US Hoist
Curtis	Joyce	Weaver
Ford Smith	Manitowoc Lifts	Western

### AIR COMPRESSOR PARTS

- Air Receiver Tanks • Compressor Mufflers
- Automatic Tank Drain Valve for Champion Compressors
- Filters—Many OEM Ref Available!
- Filters, Regulators, Lubricators
- Intake Filter Products
- Milton Air System Products
- Re-Coil Hose • Valves
- Vibration Dampening Pads & much more!

### BRAKE LATHES REPAIR PARTS

- Brake Lathe Repair Parts and Accessories for All Makes 

### EXHAUST REMOVAL SYSTEMS & PRODUCTS

### FLUID DELIVERY

- Lenz Fittings
- Steel Hydraulic Line Tubing and Fittings
- Strut and Hangers

### HOSE REELS BY REELCRAFT®

### HYDRAULIC CYLINDERS—

- Custom Single-Acting Large Bore Cylinders
- Also see "Lifting Equipment"

### LIFTING EQUIPMENT

- New In-Ground Lifts—Car, Truck & Bus
- Small Equipment Shop Maintenance (SESM) Lifts for lifting Landscape Equip. ATVs / UTVs, Motorcycles, Lawn Mowers, Golf Carts and More!
- Custom Lifting Equipment incl. Production Line Lifts, Rail Car Lifts and More
- Custom Hydraulic Cylinders for Various Applications
- Turf Attachments for 2-Post Lifts
- In-Ground Lift Sections and Kits
- And more!

EASY TO ORDER:

**800-321-8173**

**815-748-0200**

Fax: 800-899-1784 • 815-748-0210

E-Mail: [parts@sviintl.com](mailto:parts@sviintl.com)

[www.sviinternational.com](http://www.sviinternational.com)

### LUBRICATION & PAINT / FOAM SPRAY REPAIR PARTS & KITS FOR:

- Alemite • ARO • Balcrank • Graco • Lincoln

### PETROLEUM EQUIPMENT & REPAIR PARTS FOR:

- Gas Pump & Meter Kits and Parts for Gasboy • Tokheim • Fill-Rite
- Including Parts for Older Pumps: Wayne • Bennett • Gilbarco • Bowser A.O. Smith (Geosource) • Southwest

### SEAL KITS

### SHOP EQUIPMENT

- Hein-Werner Products • Omega Products
- Porto-Power • Pro-Lift

### TIRE EQUIPMENT REPAIR PARTS

- Tire Changer and Wheel Balancer Parts for All Makes

Accu-Turn	FMC	Nussbaum
All Tool	Giuliano	Ranger
Ammco®*	Hofmann	Sicam
BaseLine®*	Hunter	Sice
Bosch	John Bean /	Snap-On
Cemb	(JBC)	Teco
Coats®*	Kwik-Way	Tuxedo
Corgi	Launch	

### VALVES

- Air Compressor Valves of All Types
- Air and Hoist Control Valves
- Ball Valves • Check Valves
- Kingston Valves • Pressure Relief Valves
- Relief Valves • Safety Valves
- Solenoid Valves
- Tire Changer Valves • And More!

### CUSTOM PRODUCTS

And let us know if you want something you use in your shop to be added to our product line!

**DIRECT FIT™**

In addition to SVI's DIRECT FIT™ BRAND, we are proud to be a one-stop shop for many other great products including:



B-Line  
by E-T-N



and many more!

3 Ready-Ship Warehouses for Faster Shipping! | **BALTIMORE • CHICAGO • LOS ANGELES**

**Main Office:** 155 Harvestore Drive • DeKalb, IL 60115

All names, numbers, symbols and descriptions are used for reference purposes only. It is not implied that any part listed is the product of these manufacturers. 08.06.2021

SVI does not represent and is not associated in any way with any other companies. Entire contents copyright © 2021, SVI International, Inc. Prices subject to change without notice.

\*AMMCO, BASELINE, COATS and DUCKHEAD are registered trademarks of Hennessy Industries, Inc. SVI International, Inc. is not associated in any way with Hennessy Industries, Inc.

**TERMS AND CONDITIONS OF THE  
SALES ORDER  
FOR SVI INTERNATIONAL, INC.**

1. **GENERAL.** The terms and conditions of sales order outlined herein shall apply to the sale by SVI INTERNATIONAL, INC. (hereinafter referred to as "Company") of the items described on the facing page (hereinafter referred to as "Merchandise") to Purchaser.
2. **DELIVERY.** Delivery shall be deemed to be complete when the Merchandise has been shipped F.O.B. Company's plants in DeKalb, Illinois, Montclair, California; and Hanover, Maryland ("Company's plants"). Shipments are subject to delays from causes or contingencies beyond the reasonable control of the Company. When otherwise not specified, shipments will be made in standard containers via carrier which, in the judgment of the Company, will result in the most practical method. Title and right of possession will pass to the Purchaser upon receipt by the carrier at the shipping point. If a customer of the Company should specify a specific carrier's method of shipment (i.e. UPS Next Day Air) and that carrier does not perform to the customer's expectations, freight credit to a customer's account will not be issued unless the Company can first obtain a credit.
3. **RISK OF LOSS.** Identification of the Merchandise under Uniform Commercial Code (hereinafter referred to as "UCC") Section 2-501 shall take place at the moment of shipment F.O.B. Company's plants. Risk of loss shall pass to the Purchaser when the Merchandise is shipped from the Company's plants.
4. **TITLE.** Title to the merchandise shall transfer to the Purchaser when the Merchandise is shipped from the Company's plants.
5. **WARRANTIES.** The Company guarantees its products to be free from defects in workmanship and raw materials for a period of one year from date of purchase. THIS WARRANTY IS EXPRESSLY IN LIEU OF ANY AND ALL WARRANTIES EXPRESS OR IMPLIED. COMPANY DOES NOT WARRANT THE MERCHANDISE IS MERCHANTABLE OR FIT FOR ANY PARTICULAR PURPOSE. Company's liability for breach of the terms of this Agreement, including any warranty, is limited to either refund of the invoice price of the Merchandise or at Company's option, replacement of the Merchandise free of charge, including transportation charges but not including the cost of labor. Purchaser has not relied on any statement or upon the conduct of Company with respect to the prospective use of the merchandise. Company shall not be liable for and Purchaser waives any and all claims for any loss or damage, directly or indirectly, arising from the use of the Merchandise and for punitive, incidental or consequential damages, including, but not limited to, damages to property, for loss of use, loss of time, loss of profit or loss of income. The Company does not authorize the sale of our products under any other warranty, expressed or implied. **Please note:** Electrical components and cylinder or shaft seals are not covered under warranty.
6. **SETOFF.** All claims for money due or to become due from the Company shall be subject to deduction by the Company for any setoff or counterclaim arising out of this or any other claims of the Company or its affiliated companies, whether such setoff or counterclaim arose before or after any assignment by Purchaser.
7. **INDEMNIFICATION.** Purchaser agrees to indemnify the Company and hold it harmless from and against all claims, liability, loss, damage or expense, including reasonable counsel fees, arising from or by reason of any modifications or alterations made by Purchaser. If a customer of the Company modifies or alters any part, in any manner whatsoever, or uses any part in departure from recommended performance specifications, said customer agrees to indemnify and hold the Company harmless from and against all liability and expenses based on damage to property or injury to or death of any person arising out of or attributable to such modified or altered part. Further, the Company will not accept any such modified or altered part for credit to a customer's account.
8. **FREIGHT POLICY.** Freight charges are prepaid and added to invoice or collect FOB shipping point. Note: All customers are responsible for all carrier shipping costs, fees, surcharges, etc. including order refusal and return fees.
9. **RETURN POLICY.** To return a part for credit or inspection, Purchaser must first contact our Main Office in Illinois, to obtain a Return Merchandise Form. Once Purchaser has obtained this form, the parts can be returned freight prepaid only. The Return form must be included with the shipment. Parts returned to the Company without the approved form will be returned freight collect to the shipper or refused. Returns must be initiated within 30 days of the invoice date. The Return Forms are valid for 30 days, from the date of issue. All Returns are subject to restocking charges. Return parts brought into our remote warehouses, will not be accepted by our personnel, without a Return Merchandise Form from the Main Office. Parts which have been used in any way or manner, including any installation or incorporation into a lift, hoist, or other equipment, shall NOT be eligible for return whether or not a Return form has been assigned. **Please note:** Electrical parts or components are not returnable for credit. This includes all switches, pushbuttons, relays, electric motors, capacitors, fuses, solenoids, power units with wiring issues or any other electrical items. Custom, built to order, special order, and non-stocked genuine parts are non-returnable.
10. **RESTOCK CHARGE.** Returns are subject to a restocking charge. Refusals are subject to the same restocking charge plus the cost of outbound and return freight charges and/or fees incurred by the Company due to shipment refusal.
11. **PRICES AND PAYMENTS.** All prices are subject to change without notice. All prices are F.O.B. shipping point. The Company standard terms are net 30 days, C.O.D. company check, C.O.D. cash, VISA, MasterCard, Discover or American Express. However, if in the judgment of the Company, the financial condition of the Purchaser at any time does not justify shipment according to standard terms of payment, the Company may require full or partial payment in advance.
12. **INTERPRETATION.** This sales order is intended by the parties as a complete and exclusive statement of the terms of their agreement. It supersedes all prior agreements, written or oral. No course of prior dealings between the parties and no usage of the trade shall be relevant to supplement or explain any terms used in this sales order. Acceptance or acquiescence in a course of performance rendered under this purchase order shall not be relevant to determine the meaning of this sales order even though the accepting or acquiescing party has knowledge of the nature of the performance and opportunity for objection. Whenever a term defined by the UCC is used in this sales order the definition contained in the UCC shall control.
13. **MODIFICATION.** This sales order can be modified or rescinded only by a writing signed by both parties.
14. **WAIVER.** No claim or right arising out of a breach of this sales order can be discharged in whole or in part by a waiver or renunciation of the claim or right unless such waiver or renunciation is supported by consideration and is in writing signed by the aggrieved party.
15. **ASSIGNMENT.** No right or interest in this sales order shall be assigned by either party without the written consent of the other and no delegation of any obligation owed, or of the performance of any obligation by either the Company or Purchaser shall be made without the written consent of the other party. Any attempted assignment or delegation not made in conformity with this paragraph shall be wholly void and totally ineffective for all purposes.
16. **TIME TO PERFORM AND BRING ACTION.** Time is of the essence of this sales order. Any action for breach of this sales order shall be commenced within two (2) years after the cause of action has accrued. Any party who loses any litigation shall reimburse the other party for costs including reasonable attorney's fees. The exclusive jurisdiction for any legal action shall be the Circuit Court of DeKalb County, Illinois.
17. **APPLICABLE LAW.** This sales order shall be governed by the UCC of Illinois as effective and in force on the date of this sales order.



BALTIMORE • CHICAGO • LOS ANGELES



**DIRECTFIT™**  
SVI's DIRECT FIT™ BRAND

- Air Compressor Parts and Filters
- Auto Lift Parts for Any Brand
- Auto Lift Cables and Chain
- Auto Lift Power Units and Parts
- Auto Lift Sheaves / Pulleys and Chain Rollers
- Brake Lathe Repair Parts for All Makes
- Exhaust System Products
- Fluid Delivery Repair Parts
- Hose Reels and Hose Stops
- In-Ground Auto Lifts
- Lubrication Equipment Repair Parts
- Petroleum / Service Station Pump and Tank Products
- Repair Parts for Gasboy Consumer Series
- SESM Lifts for ATV/UTV, Golf Cart and More!
- Tire Changer Repair Parts
- Turf Attachments for 2-Post Lifts
- Vehicle Lifting Systems
- Wheel Balancer Accessories

## SVI International, Inc.

155 Harvestore Drive • DeKalb, IL 60115

**800-321-8173 • 815-748-0200**

FAX: 800-899-1784 • 815-748-0210

E-MAIL: [parts@sviintl.com](mailto:parts@sviintl.com)

Entire contents copyright © 2021, SVI International, Inc.

Information and Catalogs Online:  
[www.sviinternational.com](http://www.sviinternational.com)