

AIR / HYDRAULIC PUMPS

Ideal for Rolling Bridge Jacks AND OTHER APPLICATIONS

SVI offers a variety of Rolling Bridge Jack Parts and Pumps!

No matter your needs or your budget, SVI has an Air Actuated Hydraulic Pump to fit your needs. Don't forget to pick up a hose for your application with standard lengths ranging from 16" to 36". Contact SVI today!



SVI International, Inc.
BALTIMORE • CHICAGO • LOS ANGELES
155 Harvestore Drive • DeKalb, IL 60115

800-321-8173 • 815-748-0200

fax: 800-899-1784 • 815-748-0210

E-Mail: parts@sviintl.com

www.sviinternational.com

2.5 QUART TITAN AIR / HYDRAULIC PUMP

FEATURES:

- Operates with as little as 80 PSI (5.5 bar)
- Durable Metal Air Motor
- Weight: 18 lbs (8.2 kg)
- Input Port 1/4"-18 NPT
- Output Port 3/8"-18 NPT

AME-15905 10,000 PSI 2.5 Quart

- Builds 10,000 PSI (700 Bar) hydraulic pressure (max pressure)
- Heavy duty steel reservoir

AME-15906 5,500 PSI 2.5 Quart

- Builds 5,500 PSI (379 Bar) hydraulic pressure (max pressure)
- High Density Polyethylene Reservoir

AME-15907 3,900 PSI 2.5 Quart

- Builds 3,900 PSI (269 Bar) hydraulic pressure (max pressure)
- High Density Polyethylene Reservoir



See Comparison Chart for more statistics.

2.5 QUART • 10,000 PSI HEBER AIR / HYDRAULIC PUMP

FEATURES:

- Builds 10,000 PSI (700 Bar) hydraulic pressure max pressure)
- Integral Reservoir Over-Pressurization Protection
- ABS Plastic Reservoir
- Baked Enamel Finish for Increased Corrosion Resistance
- Standard Foot Pedal

BH-7011-25 10,000 PSI 2.5 Quart

SPECIFICATIONS:

DIMENSIONS: 7" Wide x 12.5" Long x 8" Tall

USABLE OIL VOLUME: 2.5 Quart (2.4 L)

PRESSURE RATING: 10,000 PSI (70 MPa)

AIR SOURCE PRESSURE: 58-116 psi (0.4-0.8 MPa)

FLOW RATE - NO LOAD: 1.21 qt./Min (1.15 L/Min)

FLOW RATE - LOAD: 0.17 qt./Min (0.16 L/Min)

OUTPUT OIL THREAD: 3/8"-18 NPT

WEIGHT: 20.28 lbs (9.2 kg)



DIMENSIONS:

7" Wide x 12.5" Long x 8" Tall

SVI offers a variety of
Rolling Bridge Jack
Parts and Pumps!
Call or E-Mail today!



See Comparison Chart for more statistics.

10,000 PSI OMEGA LIFT TURBO AIR / HYDRAULIC PUMP

FEATURES:

- User friendly foot-actuated design for easy control of moving fluid at tremendous rate
- Uses 3/8" NPTF fluid coupler
- Provides up to 10,000 PSI with standard shop air supply of 110-175 PSI
- Built-in pressure by-pass system protect overload operation
- Efficiently operates many industrial and construction single-acting ram applications
- A compact yet powerful Air Turbo Motor U.S. Patent No. 5,341,723 is equipped to raise the load to the desired height efficiently, effortlessly, and safely
- U.S. Patent No.5,946,912, a built-in by-pass device protects hydraulic system from over pumping damage
- Made of durable light weight corrosion-free aluminum
- Input Port 1/4"-18 NPT / Output Port 3/8"-18 NPT



SF-22903	10,000 PSI	1.5 Quart	Omega Air / Hydraulic Pump
SF-22905	10,000 PSI	2.1 Quart	Omega Air / Hydraulic Pump
SF-22907	10,000 PSI	4 Quart	Omega Air / Hydraulic Pump

See Comparison Chart for more statistics.

10,000 PSI (700 BAR) RATED HOSES FOR AIR / HYDRAULIC PUMPS

Looking for other Specifications, Lengths or Ends, Contact SVI: 800-321-8173



SVI Part #	Length	Description	Fitting Ends
BH-7092-01	16"	10,000 PSI Hose for Air/Hydraulic Pump	3/8" NPTF Male (1) Swivel / (1) Rigid
BH-7092-02	18"	10,000 PSI Hose for Air/Hydraulic Pump	3/8" NPTF Male (1) Swivel / (1) Rigid
BH-7092-03	24"	10,000 PSI Hose for Air/Hydraulic Pump	3/8" NPTF Male (1) Swivel / (1) Rigid
BH-7092-04	30"	10,000 PSI Hose for Air/Hydraulic Pump	3/8" NPTF Male (1) Swivel / (1) Rigid
BH-7092-05	36"	10,000 PSI Hose for Air/Hydraulic Pump	3/8" NPTF Male (1) Swivel / (1) Rigid

COMPARISON CHART OF OUR MOST POPULAR AIR/HYDRAULIC PUMPS FOR ROLLING JACKS

SVI Part #	Input Air Pressure (psi)	Input Port Threads (Air)	Output Port Threads (Oil)	Oil Delivery Flow Rate (cu.in./min)		Max Pressure (psi)	Usable Oil Capacity (cu.in.)	Length	Width	Height	Weight
				No Load	Load						
AME-15905	90-140	1/4-18NPT	3/8-18 NPT	24.4	7.3	10,000	144 in ³	12.3"	6.7"	7.50"	19 lbs
AME-15906	90-120	1/4-18NPT	3/8-18 NPT	—	—	5,500	—	—	—	—	18 lbs
AME-15907	90-120	1/4-18NPT	3/8-18 NPT	—	—	3,900	—	—	—	—	18 lbs
SF-22903	110-175	1/4-18NPT	3/8-18 NPT	66	11	10,000	91.50 in ³	9.75"	4.63"	7.50"	18.92 lbs
SF-22905	110-175	1/4-18NPT	3/8-18 NPT	65	12	10,000	122.00 in ³	11.50"	6.00"	8.00"	22 lbs
SF-22907	110-175	1/4-18NPT	3/8-18 NPT	65	12	10,000	231.00 in ³	13.50"	8.00"	7.25"	28.16 lbs
BH-7011-25	58-116	—	3/8-18 NPT	91.5	9.8	10,000	146.46 in ³	12.50"	7.00"	8.00"	20.28 bs

AIR / HYDRAULIC PUMP CONVERSION KITS FOR ROLLING JACKS

BH-7504-14 2500 PSI Air/Hydraulic Pump Conversion Kit

Interchange Ref: FA5120, FC5827, FC5275-3, FC5185-53, FC5185-53BK, FC5948, FC5883, others

BH-7504-05 3200 PSI Air/Hydraulic Pump Conversion Kit

Interchange Ref: FA5121, FC5270-1, FC5270-3, FC5278-1, FC5819, FC5884, FC5889, others

BH-7504-22 3400 PSI Air/Hydraulic Pump Conversion Kit

Interchange Ref: FA5135, FC5824, FC5885, others



BH-7504-22



BH-7504-05

BH-7215-13

Interchange Ref: 500823, others

Air/Hydraulic Pump

BH-7231-45

Interchange Ref: 63-0012, 63-0005, others

Air/Hydraulic Pump

BH-7514-51

Interchange Ref: FC5954, others

Air/Hydraulic Pump Kit



BH-7514-51

BH-7525-98

Interchange Ref: APO2528, others

Air/Hydraulic Pump

BH-7531-90

Interchange Ref: FC5949, others

Air/Hydraulic Pump

****Must have Filter / Regulator / Lubricator Used with Pump. Cannot be set more than 110 PSI**

BH-7544-98 3335 PSI

Interchange Ref: FC5965Z, others

Air/Hydraulic Pump Kit



BH-7544-98

BH-7803-08

Interchange Ref: 6-0960, others

Air/Hydraulic Pump

BH-7806-29

Interchange Ref: 3-0843, others

Air/Hydraulic Pump Repair Kit



**SVI offers a variety of
Rolling Bridge Jack Parts and Pumps!**
*Don't forget to pick up a hose for your
application with standard lengths ranging
from 16" to 36". Contact SVI today.*



SPX Power Team Air / Hydraulic Pump with Hand Control

BH-7806-28 5500 PSI

Interchange Ref: 6-1428, others

- Unique bladder design for all-position operation and storage.
- Hard-coat anodized aluminum housing, distinctive styling.
- Oil filler with integral safety relief minimizes chance of damage to reservoir bladder if overfilling occurs.
- Mounting Slots 3/8" Standard



Ideal for powering single-acting cylinders and portable hydraulic tools.

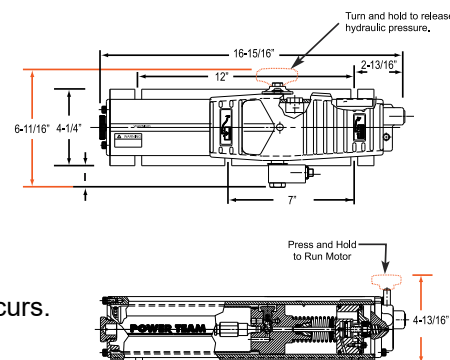

SVI Part #	Input Air Pressure (psi) at 20 cfm	Input Port Threads (Air)	Output Port Threads (Oil)	Oil Delivery Flow Rate (cu.in./min)		Max Pressure (psi)	Usable Oil Capacity (cu.in.)	Length	Width	Height	Weight
				No Load	Load						
BH-7806-28	40-120	—	3/8 NPTF	—	9	5,500	33.5 in ³	16-15/16"	6-11/16"	4-13/16"	15 lbs

Repair Parts Available. Need another Pressure Setting up to 10,000 PSI or need the Foot Control Version—Contact SVI today!

BH-7514-21 6000 PSI

Interchange Ref: FA562-1, FC5163, others

Bullet Style Air / Hydraulic Pump

Repair Parts Available—Contact SVI

- (4) 0.32" Mounting Holes (Centers 3.31" on width / 7" on length)
- Features Handle Release Valve
- Reservoir Capacity 37.2 cu. in. / Usable Oil Capacity 36.6 cu. in.
- Relief Valve Setting 6,000–6,300 psi (413.8–434.4 bar)
- Unit contains an orifice in the return to reservoir.

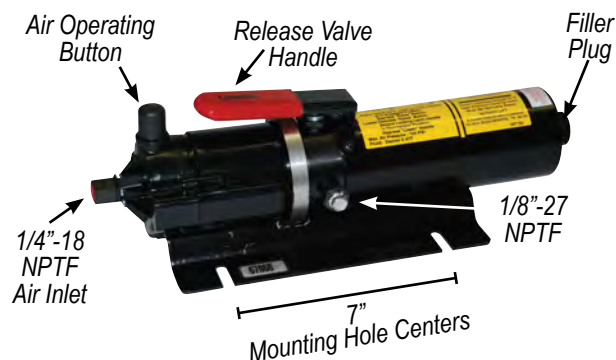

DIMENSIONS: 4-15/16" Tall x 4-1/2" Wide x 14-11/16" OAL

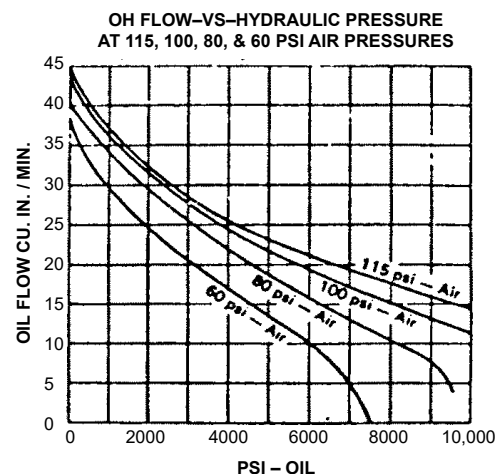
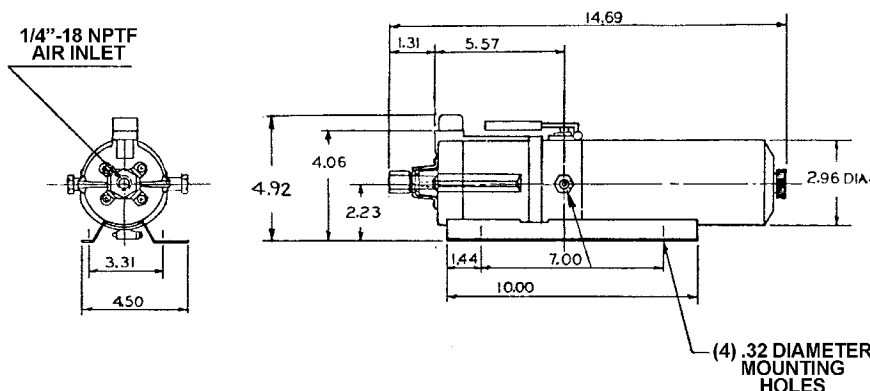

SVI Part #	Operating Air Pressure	Input Port Threads (Air)	Output Port Threads (Oil)	Oil Delivery Flow Rate (cu.in./min)		Max Pressure (psi)	Usable Oil Capacity (cu.in.)	Length	Width	Height	Weight
				No Load	Load						
BH-7514-21	60-120	1/4"-18 NPTF	1/8"-27 NPTF	—	—	5,500	36.6 in ³	14-11/16"	4-1/2"	4-15/16"	11.5 lbs



SVI International, Inc.
BALTIMORE • CHICAGO • LOS ANGELES
155 Harvestore Drive • DeKalb, IL 60115

800-321-8173 • 815-748-0200

fax: 800-899-1784 • 815-748-0210

E-Mail: parts@sviintl.com

www.sviinternational.com



DIRECT FIT™ BRAND

SVI International, Inc.

Catalogs and Information Online: www.sviinternational.com

AUTO LIFT REPAIR PARTS FOR ALL MAKES & MODELS

~NO MATTER THE AGE OF THE LIFT!

- Arm Restraint Kits & Parts
- Cables—Lifting and Equalizing
- Chain
- doorjammerPRO - Door Protection Pad
- Height Extensions and Rubber Pads
- Installation Products & Tools
- Power Units and Parts
- Pulleys and Chain Rollers
- Seal Kits for In-Ground & Surface Mount
- Safety Legs / Non-Rotators
- Replacement Lift Kits
- Power Post Lifting Systems
- Tanks for In-Ground Lifts
- Turf Attachments for 2-Post Lifts

SURFACE MOUNT LIFT PARTS FOR:

Acanus	Gemini	Quality
Ammco®*	Gilbarco	Ranger
Alamo /	Globe	Ravaglioli
ASSSA	Grand	Rotary Lifts
ALM	Hofmann	Silent Tech
AMI	Hydralift	Slift
Ashawa	Ime Istobal	Somers Souriau
Ben Pearson	Kismet	Stenhoj
BendPak	Kimm	Stertil Koni
Benwil	Koni	Sun
Bishamon	Launch	Tecalemit
Boston	Laycock	Titan
Bradbury	Lincoln	Weaver
Cascos	Maha	Werther
Consul	Manitowoc Lifts	Western
Challenger	Mohawk	Westinghouse
Force	Nussbaum	Wheeltronic
Ford Smith	OMA	Worth
Forward	OMCN	Zippo
Fuchs / Zippo	PMW	

IN-GROUND LIFT PARTS FOR:

Benwil	Gilbarco	PKS Lifts
Challenger	Globe	Rotary
Cochin	HDL/ISS Innovative	US Hoist
Curtis	Joyce	Weaver
Ford Smith	Manitowoc Lifts	Western

AIR COMPRESSOR PARTS

- Air Receiver Tanks • Compressor Mufflers
- Automatic Tank Drain Valve for Champion Compressors
- Filters—Many OEM Ref Available!
- Filters, Regulators, Lubricators
- Intake Filter Products
- Milton Air System Products
- Re-Coil Hose • Valves
- Vibration Dampening Pads & much more!

BRAKE LATHES REPAIR PARTS

- Brake Lathe Repair Parts and Accessories for All Makes 

EXHAUST REMOVAL SYSTEMS & PRODUCTS

FLUID DELIVERY

- Lenz Fittings
- Steel Hydraulic Line Tubing and Fittings
- Strut and Hangers

HOSE REELS BY REELCRAFT®

HYDRAULIC CYLINDERS—

- Custom Single-Acting Large Bore Cylinders
- Also see "Lifting Equipment"

LIFTING EQUIPMENT

- New In-Ground Lifts—Car, Truck & Bus
- Small Equipment Shop Maintenance (SESM) Lifts for lifting Landscape Equip. ATVs / UTVs, Motorcycles, Lawn Mowers, Golf Carts and More!
- Custom Lifting Equipment incl. Production Line Lifts, Rail Car Lifts and More
- Custom Hydraulic Cylinders for Various Applications
- Turf Attachments for 2-Post Lifts
- In-Ground Lift Sections and Kits
- And more!

EASY TO ORDER:

800-321-8173

815-748-0200

Fax: 800-899-1784 • 815-748-0210

E-Mail: parts@sviintl.com

www.sviinternational.com

LUBRICATION & PAINT / FOAM SPRAY REPAIR PARTS & KITS FOR:

- Alemite • ARO • Balcrank • Graco • Lincoln

PETROLEUM EQUIPMENT & REPAIR PARTS FOR:

- Gas Pump & Meter Kits and Parts for Gasboy • Tokheim • Fill-Rite
- Including Parts for Older Pumps: Wayne • Bennett • Gilbarco • Bowser A.O. Smith (Geosource) • Southwest

SEAL KITS

SHOP EQUIPMENT

- Hein-Werner Products • Omega Products
- Porto-Power • Pro-Lift

TIRE EQUIPMENT REPAIR PARTS

- Tire Changer and Wheel Balancer Parts for All Makes

Accu-Turn	FMC	Nussbaum
All Tool	Giuliano	Ranger
Ammco®*	Hofmann	Sicam
BaseLine®*	Hunter	Sice
Bosch	John Bean /	Snap-On
Cemb	(JBC)	Teco
Coats®*	Kwik-Way	Tuxedo
Corgi	Launch	

VALVES

- Air Compressor Valves of All Types
- Air and Hoist Control Valves
- Ball Valves • Check Valves
- Kingston Valves • Pressure Relief Valves
- Relief Valves • Safety Valves
- Solenoid Valves
- Tire Changer Valves • And More!

CUSTOM PRODUCTS

And let us know if you want something you use in your shop to be added to our product line!

DIRECT FIT™

In addition to SVI's DIRECT FIT™ BRAND, we are proud to be a one-stop shop for many other great products including:



B-Line
by E-T-N



and many more!

3 Ready-Ship Warehouses for Faster Shipping! | **BALTIMORE • CHICAGO • LOS ANGELES**

Main Office: 155 Harvestore Drive • DeKalb, IL 60115

All names, numbers, symbols and descriptions are used for reference purposes only. It is not implied that any part listed is the product of these manufacturers. 08.09.2021

SVI does not represent and is not associated in any way with any other companies. Entire contents copyright © 2021, SVI International, Inc. Prices subject to change without notice.

*AMMCO, BASELINE, COATS and DUCKHEAD are registered trademarks of Hennessy Industries, Inc. SVI International, Inc. is not associated in any way with Hennessy Industries, Inc.