

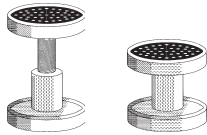

Insist on only SVI "Direct Fit" brand Lift Repair Parts.

entire contents copyright © 2005 SVI International, Inc.

For a more comprehensive listing of pad style lift height extensions visit SVI's exclusive Height Extension Catalog.



for lift models VLX6,
VLXS6,
VLX6-1, 2, 3 or 4

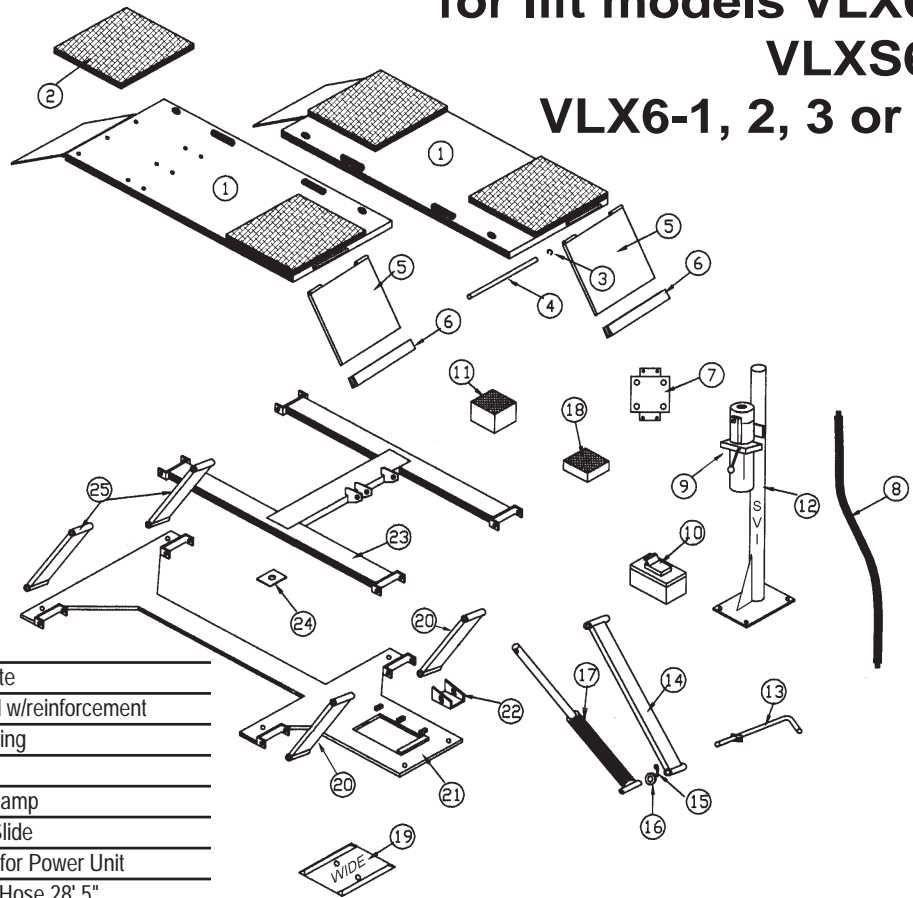

| Item | SVI part# | OEM# | Req | Description |
|------|---------------|-------------|-----|---------------------------------|
| 1 | BH-7546-001 | FJ2386-1 | 2 | Pick Up Plate |
| 2 | BH-7546-002 | FJ2433 | 4 | Rubber Pad w/reinforcement |
| 3 | BH-7546-003 | FJ2334 | 4 | Retaining Ring |
| 4 | BH-7546-004 | FJ2388 | 2 | Hinge Pin |
| 5 | BH-7546-005 | FJ2387 | 2 | Approach Ramp |
| 6 | BH-7525-22 | FC5142-3 | 2 | 14" Ramp Slide |
| 7 | BH-9785-45 | T120020 | 1 | Wall Mount for Power Unit |
| 8 | BH-7512-17 | FJ85 | 1 | Power Unit Hose 28' 5" |
| 9 | BH-7007-01 | P833 | 1 | Power Unit |
| 10 | SF-22903 | P831 | 1 | Pump for air operated models |
| 11 | BH-9756-87 | FJ2428 | 4 | 3" Tall Rubber Block |
| 12 | BH-7537-34 | FJ864 | 1 | Power Unit Stand (one unit) |
| | BH-7537-34D | FJ570 | 1 | Power Unit Stand (two unit) |
| 13 | BH-7546-006 | FA2390 | 1 | Lock Release Handle |
| 14 | BH-7546-007 | FJ2458 | 1 | Lock Leg |
| 15 | F-CP-125-1250 | | 1 | 1/8" x 1-1/4" Cotter Pin |
| 16 | BH-7546-008 | FJ2252-4 | 1 | Washer |
| 17 | BH-7505-02 | FJ2248 | 1 | Hydraulic Cylinder |
| | BH-7532-85 | FJ2248-12TH | | Seal Kit for Texas Hyd Cylinder |

| Item | SVI part# | OEM# | Req | Description |
|------|-------------|---------------|-----|------------------------------|
| 18 | BH-9756-86 | FJ2427 | | 1-1/2" Tall Rubber Block |
| 19 | BH-9701 | SVI Exclusive | 1 | 15" Wide Reach Wheel Spotter |
| | BH-9702 | SVI Exclusive | 1 | 15" Wide Reach Dual Spotter |
| 20 | BH-7546-010 | FJ2244 | 2 | Front Lift Leg |
| 21 | BH-7546-011 | FJ2370 | 1 | Mounting Plate |
| 22 | BH-7546-012 | FJ2293-1 | 1 | Cylinder Retainer |
| 23 | BH-7546-013 | FJ2459 | 1 | Superstructure |
| 24 | BH-7546-014 | FJ2392 | 4 | Retainer |
| 25 | BH-7546-015 | FJ2245 | 2 | Rear Lift Leg |

For lift repair parts, SVI is your answer!

BH-9756-87 FJ2428 3" Tall Rubber Block

Lift downtime is costly. That is why top lift repair professionals and top lift users have come to rely on only:

"GENUINE SVI LIFT REPAIR PARTS".

Used all over the U.S. and can be specifically found in the following:

- Most Quick Lubes
- Discount Tire/America's Tire Locations
- Big "O" Tire Locations
- Independent Tire Locations
- Anywhere there are any low-rise lifts