

Insist on only SVI "Direct Fit" brand Lift Repair Parts.

entire contents copyright © 2005 SVI International, Inc.

# for lift model MPAL8

All lifts can be repaired.  
SVI is your answer.

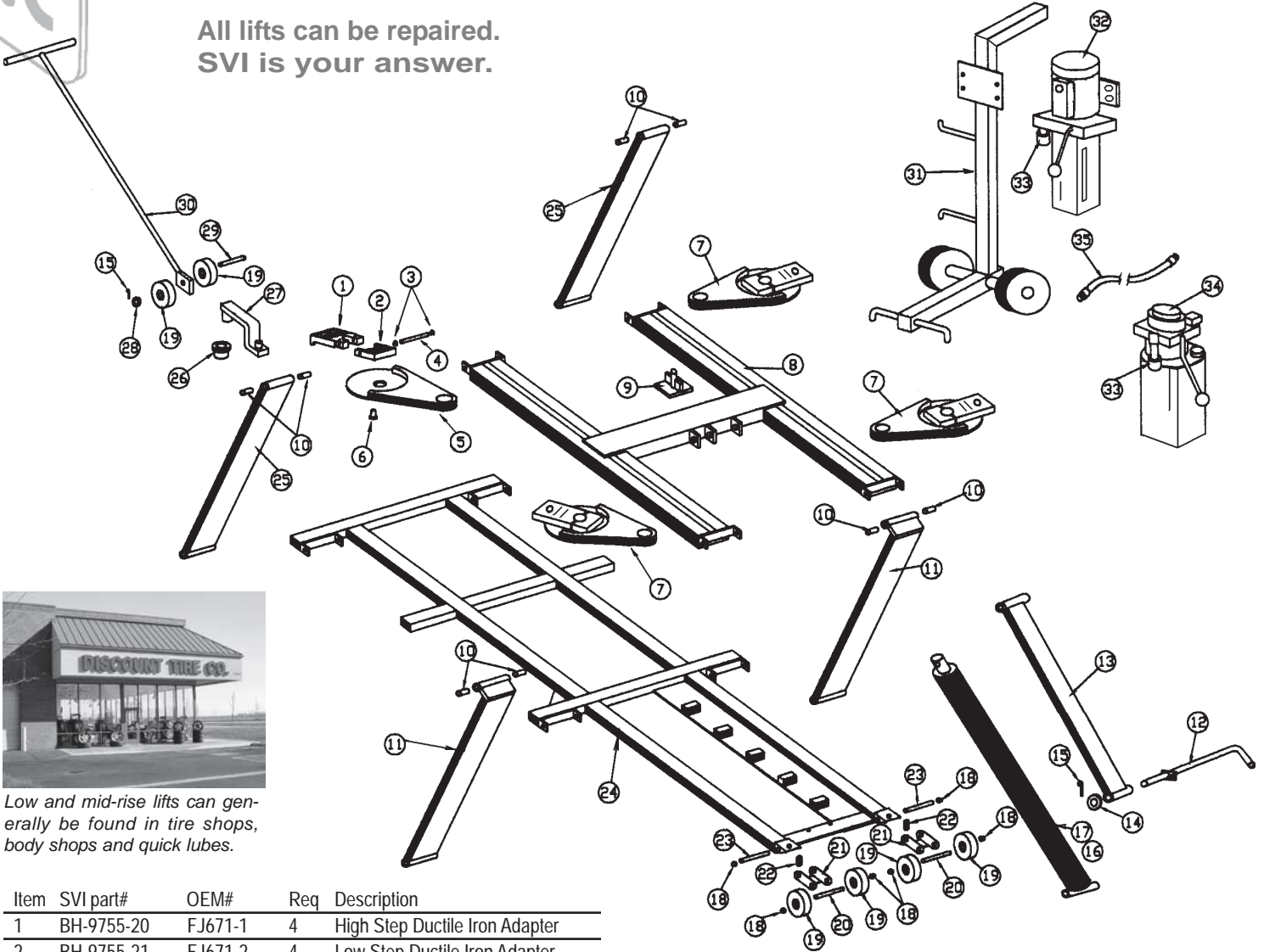

Low and mid-rise lifts can generally be found in tire shops, body shops and quick lubes.

Item	SVI part#	OEM#	Req	Description
1	BH-9755-20	FJ671-1	4	High Step Ductile Iron Adapter
2	BH-9755-21	FJ671-2	4	Low Step Ductile Iron Adapter
3	BH-9755-26	FJ671-6	8	3/32" Hog Ring
4	BH-9755-22	FJ671-3	4	Adapter Pivot Pin
5	BH-7546-033		4	Adapter Swivel Base
6	BH-9755-25L	FJ79-6	4	Adapter Swivel Pin
7	BH-7545-49	FJ2261	4	Adapter Base and Adapters
8	BH-7510-45	FJ2265	1	Superstructure
9	BH-7537-63	FJ2372	4	Adapter Slide
10	BH-7545-63	FJ2284-21	8	Lift Leg Bushings
11	BH-7510-62	FJ2268	2	Front Lift Leg
12	BH-7510-55	FJ2267	1	Lock Release Bar
13	BH-7510-66	FJ2270	1	Lock Leg
14	BH-7546-008	FJ2252-4	1	Washer
15	F-CP-125-1250		1	1/8" x 1-1/4" Cotter Pin
16	BH-7505-03	FJ2263	1	Hydraulic Cylinder
17	call for details		1	Hyd Cylinder Seal Kit
18	BH-7525-69			1/2" Push Nut
19	BH-7510-67	FJ2271-1	6	Roller (also used on QL4P models)
20	BH-7510-38	FJ2264-19	2	Axle
21	BH-7510-35	FJ2264-12	2	Wheel Holder
22	BH-7510-39	FJ2264-9	2	Spring
23	BH-7510-37	FJ2264-18	2	Wheel Holder Pivot Pin
24	BH-7510-50	FJ2266	1	Base

Item	SVI part#	OEM#	Req	Description
25	BH-7510-62	FJ2269	2	Rear Lift Leg
26	BH-7510-81	FJ2277-5		Collar
27	BH-7510-82	FJ2277		Hitch
28	F-FW-0500-USS			1/2" Flatwasher
29	BH-7510-68	FJ2271-2		Axle, Long Clevis Pin
30	BH-7510-70	FJ2271	1	Rolling Handle
31	BH-7505-43	FA569		Power Unit Stand (mobile)
32	BH-7007-01	P601	1	Power Unit 110V or 220V
33	BH-7512-48	FJ850	1	Coupler Plug (female)
34	BH-7207-81	P622	1	Power Unit (air operated)
35	BH-7512-47	FJ849	1	Power Unit Hose

SVI cares strictly about making quality lift repair parts and not simply bottom line performance. This is the reason you will often see improvements in product quality and design criteria versus that of any other manufacturer.