

# Automotive Lift

R E P A I R P A R T S



**SVI International, Inc.**  
**(800) 321-8173 • fax: (800) 899-1784**  
155 Harvestore Drive • DeKalb, IL 60115  
**[www.sviinternational.com](http://www.sviinternational.com)**

**BALTIMORE • CHICAGO • LOS ANGELES**

Repair Parts for: Challenger/VBM

Repair Parts for:  
**Challenger/  
VBM**  
LRC7225H

**Model E10**  
**(10,000 lb. capacity)**

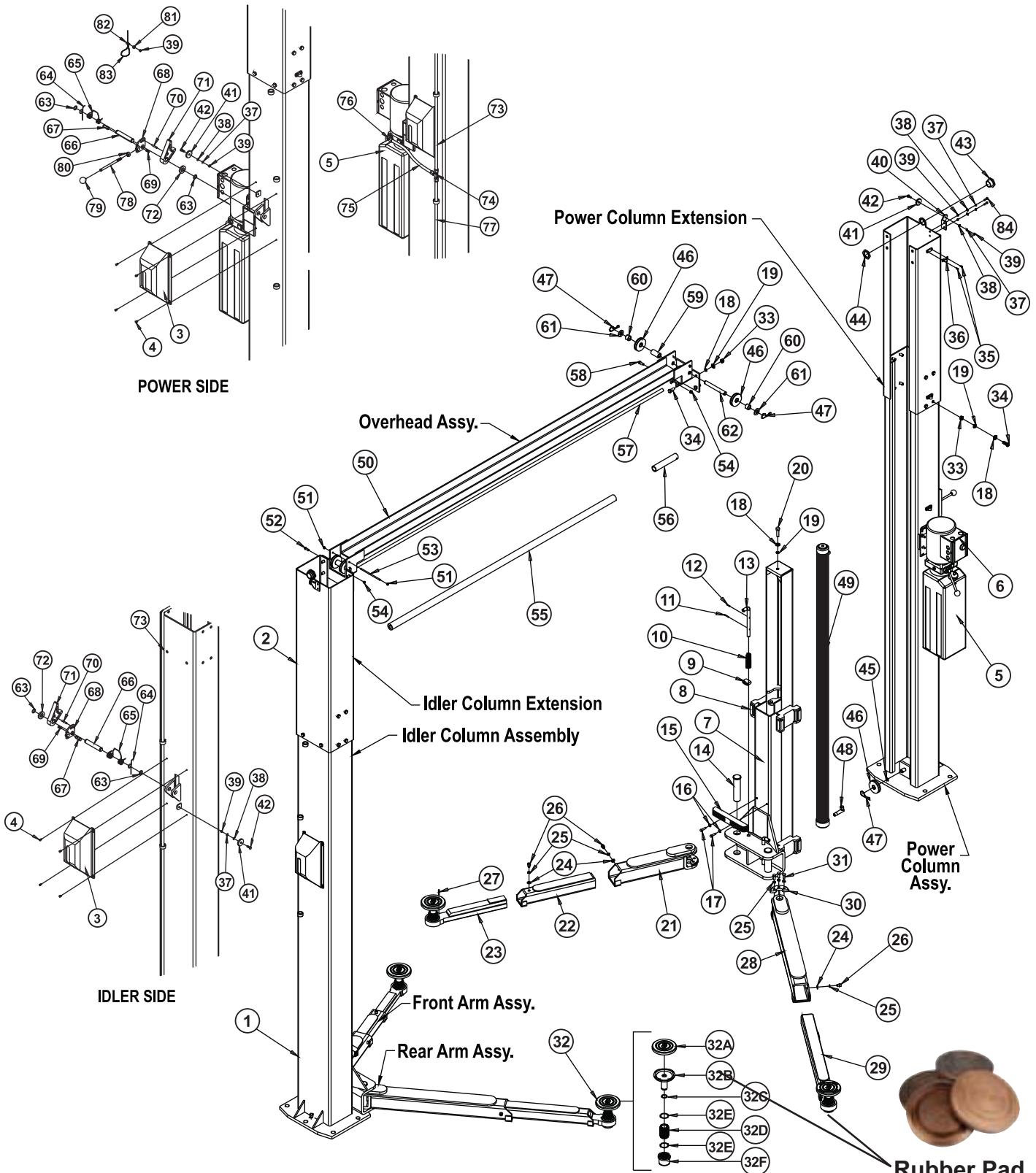



## Model E10 (10,000 lb. capacity)

Item	SVI part #	OEM #	Req	Description
1	call for details	JSJ5-02-01-00CH	1	Power Column Weld
	call for details	JSJ5-02-01-00fCH	1	Idler Column Weld
2	call for details	JSJ5-02-02-00CH	1	Power Extension Weld
	call for details	JSJ5-02-02-00fCH	1	Idler Extension Weld
3	BH-7234-31	X10-013	1	Power Lock Cover
	BH-7234-32	X10-014	1	Idler Lock Cover
4	call for details	X10-065	8	Screw M5 x 10
5	call for details	31368-21	1	Power Unit
6	call for details	X10-048	4	Nut M8
7	call for details	X10-085	2	Carriage
8	BH-7234-51	X10-084	16	Slide Block
9	BH-7234-26	X10-083	4	Outer Gear
10	BH-7234-27	X10-082	4	Arm Restraint Spring
11	BH-7234-30	X10-081	4	Spring Pin 4 x 30
12	BH-7234-29	X10-080	4	Spring Pin 4 x 24
13	BH-7234-28	X10-079	4	Arm Restraint Pin
14	BH-7234-47	X10-076	4	Arm Pin
15	call for details	X10-086	2	Door Guard
16	call for details	X10-087	4	Washer 8mm
17	call for details	X10-088	4	Bolt M8 x 30
18	call for details	X10-038	28	Washer 12mm
19	call for details	X10-039	28	Spring Washer 12mm
20	call for details	X10-092	2	Bolt M12 x 45
21	call for details	JSJ5B-10-01-00	2	Front Female Arm
22	call for details	JSJ5B-10-02-00	2	Front Intermediate Arm
23	call for details	JSJ5B-10-03-00CH	2	Front Male Arm
24	call for details	X10-073	6	Washer 10mm
25	call for details	X10-074	18	Spring Washer 10mm
26	call for details	X10-075	6	Screw M10
27	call for details	B2211	4	Roll Pin Ø6x30
28	call for details	JSJ5B-09-01-00B	2	Rear Female Arm
29	call for details	JSJ5B-09-02-00CH	2	Rear Male Arm
30	BH-7234-25	X10-078	4	Inner Gear
31	call for details	X10-077	12	Screw M10 x 25
32	BH-7232-98	B2250	4	Foot Pad Assembly
32A	BH-7232-93	B2208	4	Rubber Pad Insert
32B	call for details	B2205	4	Foot Pad Weld
32C	call for details	B17256	4	2 x 30 Retaining Ring
32D	call for details	B17254	4	Threaded Sleeve
32E	call for details		8	3 x 40 Retaining Ring
32F	call for details	B17276-1	4	Threaded Insert
33	call for details	X10-040	28	Nut M12
34	call for details	X10-037	28	Bolt M12 x 30
35	call for details	X10-049	10	Bolt M5 x 8
36	BH-7234-57	X10-050	5	Plate-Shutoff Cord Clamp
37	call for details	X10-033	8	Spring Washer 6mm
38	call for details	X10-032	8	Washer 6mm

Item	SVI part #	OEM #	Req	Description
39	call for details	X10-034	9	Nut M6
40	call for details	JSJ4-02-11-00	1R/1L	Pulley Bracket
41	BH-7234-24A	X10-031	4	Pulley
42	BH-7234-24B	X10-030	4	Pulley Axle
43	BH-7234-56	X10-052	2	Hose Guide
44	call for details	X10-053	2	Hose Guide Nut
45	call for details	X10-099	4	Washer 20mm
46	BH-7234-40	X10-057	6	Synch. Sheave
47	call for details	X10-054	6	Hair Pin Cotter
48	call for details	X10-046	2	Long Elbow
49	call for details	JSJ5-07-00CH	2	Cylinder
50	call for details	JSJ5-03-01-00Q	1	Overhead Weld
51	call for details	B31061	4	M6 Lock Nut
52	call for details	X10-063	1	Bolt M8
53	call for details	JSJ5-03-07CH	2	Cable Trapping Rod
54	call for details	X10-096	2	Lock Nut M10
55	BH-7234-58F	X10-061	1	Shutoff Bar Cushion
56	BH-7229-37	36027	1	Limit Switch
57	call for details	JSJ5-03-02CH	1	Shutoff Bar
58	call for details	X10-060	2	Bolt M8 x 25
59	BH-7234-43	X10-059	2	Middle Spacer Sleeve
60	BH-7234-42	X10-056	4	Spacer Sleeve
61	call for details	X10-055	4	Washer
62	BH-7234-41	X10-058	2	Axle
63	call for details	X10-020	4	"C" Ring 20
64	BH-7234-36	X10-022	2	Lock Release Spring 1
65	BH-7234-37	X10-023	2	Lock Release Spring 2
66	BH-7234-38	X10-024	2	Lock Release Shaft
67	BH-7234-39	X10-021	2	Lock Release Wire Pin
68	BH-7234-18	X10-025	2	Lock Release Cam
69	call for details	X10-026	2	Bolt M6
70	call for details	X10-027	2	Spring Pin 6x 35
71	BH-7234-35	X10-028	2	Lock Pawl
72	call for details	X10-029	2	Washer
73	BH-7234-54	X10-041	1	Idler Column Hose
74	call for details	X10-042	1	Union Tee
75	call for details	JSJ5-17CH	1	Power Unit Hose
76	call for details	X10-044	1	O-Ring Elbow
77	call for details	JSJ4-16	1	Power Column Hose
78	BH-7234-34	X10-018	1	Lock Release Stud
79	BH-7234-33	X10-017	1	Lock Release Knob
80	call for details	X10-019	1	Nut M10
81	call for details	X10-036	1	Sleeve
82	call for details	X10-035	1	Bolt (Cable Clamp)
83	call for details	JSJ5-06CH	1	Lock Release Cable
84	call for details	X10-051	4	Bolt M6 x 20

**TERMS AND CONDITIONS OF THE  
SALES ORDER  
FOR SVI INTERNATIONAL, INC.**

1. **GENERAL.** The terms and conditions of sales order outlined herein shall apply to the sale by SVI INTERNATIONAL, INC. (hereinafter referred to as "Company") of the items described on the facing page (hereinafter referred to as "Merchandise") to Purchaser.
2. **DELIVERY.** Delivery shall be deemed to be complete when the Merchandise has been shipped F.O.B. Company's plants in DeKalb, Illinois, Duarte, California; and Baltimore, Maryland ("Company's plants"). Shipments are subject to delays from causes or contingencies beyond the reasonable control of the Company. When otherwise not specified, shipments will be made in standard containers via carrier which, in the judgment of the Company, will result in the most practical method. Title and right of possession will pass to the Purchaser upon receipt by the carrier at the shipping point. If a customer of the Company should specify a specific carrier's method of shipment (i.e. UPS Next Day Air) and that carrier does not perform to the customer's expectations, freight credit to a customer's account will not be issued unless the Company can first obtain a credit.
3. **RISK OF LOSS.** Identification of the Merchandise under Uniform Commercial Code (hereinafter referred to as "UCC") Section 2-501 shall take place at the moment of shipment F.O.B. Company's plants. Risk of loss shall pass to the Purchaser when the Merchandise is shipped from the Company's plants.
4. **TITLE.** Title to the merchandise shall transfer to the Purchaser when the Merchandise is shipped from the Company's plants.
5. **WARRANTIES.** The Company guarantees its products to be free from defects in workmanship and raw materials for a period of one year from date of purchase. THIS WARRANTY IS EXPRESSLY IN LIEU OF ANY AND ALL WARRANTIES EXPRESS OR IMPLIED. COMPANY DOES NOT WARRANT THE MERCHANDISE IS MERCHANTABILITY OR FIT FOR ANY PARTICULAR PURPOSE. Company's liability for breach of the terms of this Agreement, including any warranty, is limited to either refund of the invoice price of the Merchandise or at Company's option, replacement of the Merchandise free of charge, including transportation charges but not including the cost of labor. Purchaser has not relied on any statement or upon the conduct of Company with respect to the prospective use of the merchandise. Company shall not be liable for and Purchaser waives any and all claims for any loss or damage, directly or indirectly, arising from the use of the Merchandise and for punitive, incidental or consequential damages, including, but not limited to, damages to property, for loss of use, loss of time, loss of profit or loss of income. The Company does not authorize the sale of our products under any other warranty, expressed or implied.
6. **SETOFF.** All claims for money due or to become due from the Company shall be subject to deduction by the Company for any setoff or counterclaim arising out of this or any other claims of the Company or its affiliated companies, whether such setoff or counterclaim arose before or after any assignment by Purchaser.
7. **INDEMNIFICATION.** Purchaser agrees to indemnify the Company and hold it harmless from and against all claims, liability, loss, damage or expense, including reasonable counsel fees, arising from or by reason of any modifications or alterations made by Purchaser. If a customer of the Company modifies or alters any part, in any manner whatsoever, or uses any part in departure from recommended performance specifications, said customer agrees to indemnify and hold the Company harmless from and against all liability and expenses based on damage to property or injury to or death of any person arising out of or attributable to such modified or altered part. Further, the Company will not accept any such modified or altered part for credit to a customer's account.
8. **FREIGHT POLICY.** Freight charges on individual orders less than \$3,000 in net value are prepaid and added to invoice or collect F.O.B. shipping point. Freight charges (standard ground service and continental US only) on individual orders more than \$3,000 net value are paid by the Company F.O.B. shipping point. Note: customers with C.O.D. terms are responsible for all carrier C.O.D. fees regardless of order net value.
9. **RETURN POLICY.** To return parts for credit or inspection Purchaser must first contact the Company to obtain a Return Goods Authorization number (RGA#). Once Purchaser has obtained an RGA# the parts can be returned freight prepaid only. The RGA# must be on the outside of the container in a highly visible location. All parts must be returned freight prepaid and the shipment must include a letter of explanation giving the specific reason for return including details as to the conditions under which the part or parts operated. Note: parts returned without an RGA#, freight collect or without written explanation may be refused. Parts which have been used in any way or manner, including any installation or incorporation into a lift or hoist, shall NOT be eligible for return whether or not an RGA has been assigned.
10. **RESTOCK CHARGE.** Returns are subject to up to twenty-five (25%) restocking charge. Refusals are subject to the same restocking charge plus the cost of outbound and return freight charges and/or fees incurred by the Company due to shipment refusal.
11. **PRICES AND PAYMENTS.** All prices are subject to change without notice. All prices are F.O.B. shipping point. The Company standard terms are net 30 days, C.O.D. company check, C.O.D. cash, VISA, MasterCard, Discover or American Express. However, if in the judgment of the Company, the financial condition of the Purchaser at any time does not justify shipment according to standard terms of payment, the Company may require full or partial payment in advance.
12. **INTERPRETATION.** This sales order is intended by the parties as a complete and exclusive statement of the terms of their agreement. It supersedes all prior agreements, written or oral. No course of prior dealings between the parties and no usage of the trade shall be relevant to supplement or explain any terms used in this sales order. Acceptance or acquiescence in a course of performance rendered under this purchase order shall not be relevant to determine the meaning of this sales order even though the accepting or acquiescing party has knowledge of the nature of the performance and opportunity for objection. Whenever a term defined by the UCC is used in this sales order the definition contained in the UCC shall control.
13. **MODIFICATION.** This sales order can be modified or rescinded only by a writing signed by both parties.
14. **WAIVER.** No claim or right arising out of a breach of this sales order can be discharged in whole or in part by a waiver or renunciation of the claim or right unless such waiver or renunciation is supported by consideration and is in writing signed by the aggrieved party.
15. **ASSIGNMENT.** No right or interest in this sales order shall be assigned by either party without the written consent of the other and no delegation of any obligation owed, or of the performance of any obligation by either the Company or Purchaser shall be made without the written consent of the other party. Any attempted assignment or delegation not made in conformity with this paragraph shall be wholly void and totally ineffective for all purposes.
16. **TIME TO PERFORM AND BRING ACTION.** Time is of the essence of this sales order. Any action for breach of this sales order shall be commenced within two (2) years after the cause of action has accrued. Any party who loses any litigation shall reimburse the other party for costs including reasonable attorneys fees. The exclusive jurisdiction for any legal action shall be the Circuit Court of DeKalb County, Illinois.
17. **APPLICABLE LAW.** This sales order shall be governed by the UCC of Illinois as effective and in force on the date of this sales order.

***Offering the Best in Automotive Lift Repair Parts and More!***

---

Auto Lift Cables • Auto Lift Parts • Brake Lathe Repair Parts

Compressed Air Repair Parts • Exhaust System Products • Fluid Delivery Repair Parts

Lubrication Equipment Repair Parts • Repair Parts for Gasboy Consumer Series

Service Station Pump and Tank Products • SVI Misc Auto Lift Products and Catalogs

Tire Changer Repair Parts • Vehicle Lifting Systems • Wheel Balancer Accessories

---

***Serving the Industry Since 1977 • Same-Day Shipping***



**SVI International, Inc.**

**(800) 321-8173 • fax: (800) 899-1784**

155 Harvestore Drive • DeKalb, IL 60115

**[www.sviinternational.com](http://www.sviinternational.com)**

**BALTIMORE • CHICAGO • LOS ANGELES**